A.M.S. V853
Type F (AMS 1), 1947.

Prepared under the direction of the Chief of Engineers by the Army Map Service (AM), War Department, Washington, D. C. Compiled in 1947 from Kentucky, 1:62,500, USGS, Hardinsburg, 1931. Planimetric detail revised from aerial photography by photo-planimetric methods. Aerial photography by the U. S. Army Air Force, 1946. Horizontal and vertical control by USGS. Planimetry field edited, 1947.

SCALE 1:24000
CONTOUR INTERVAL 20 FEET
DATUM IS MEAN SEA LEVELTRANSVERSE MERCATOR PROJECTION
1927 NORTH AMERICAN DATUMREPRINTED FROM MILITARY EDITION FOR CIVIL USE
PENDING REVISION FOR STANDARD ISSUE
SOLD AND DISTRIBUTED BY U. S. GEOLOGICAL SURVEY, WASHINGTON 25, D. C.USGS
Historical File
Topographic DivisionTRUE NORTH
MAGNETIC NORTH
APPROXIMATE MEAN
DECLINATION, 1947

INDEX TO BOUNDARIES

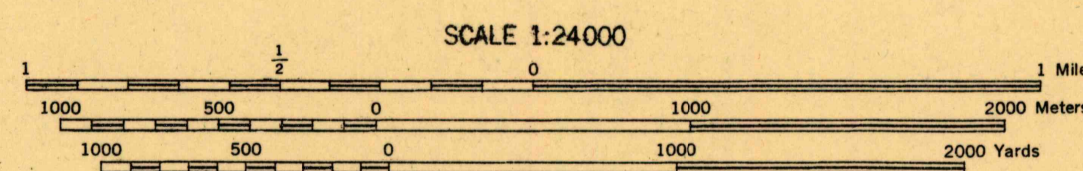
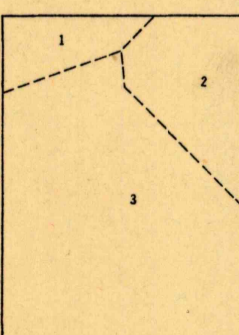

INDEX TO ADJOINING SHEETS

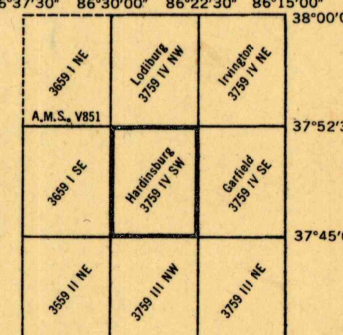
U. S. G. S.
FILE COPY
Inspection and Editing.HARDINSBURG, KENTUCKY
BRECKINRIDGE COUNTY
N3745-W8622.5/7.5

OCT 15 1948

2135