



Produced and published by the Geological Survey

Orthophoto prepared from 1:76,000-scale  
aerial photograph taken March 26, 1972

Projection and 10,000-foot grid ticks: Virginia coordinate  
system, north zone (Lambert conformal conic)  
1000-meter Universal Transverse Mercator grid,  
zone 17. 1927 North American datum

Photoimagery transformed by scanning techniques  
which may produce double or mismatched images;  
use the mean of image positions for map point

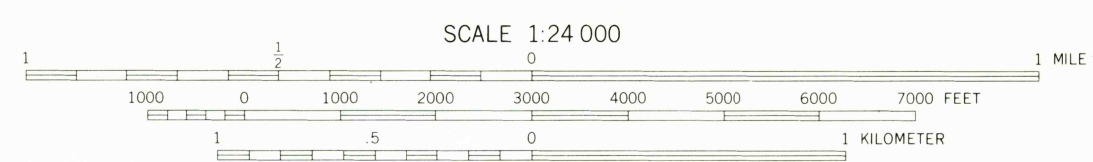
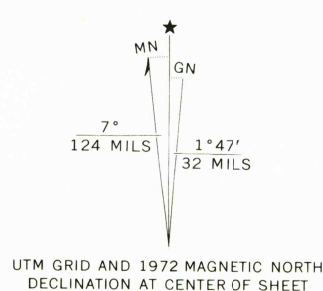

ADJOINING ORTHOPHOTOQUADS

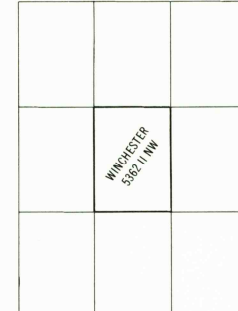

PRINCIPAL NUMBERED HIGHWAYS  
○ Interstate Route    ○ U. S. Route    ○ State Route

USGS  
Historical File  
Topographic Division

This quadrangle area also covered by  
1:24,000-scale topographic map

WINCHESTER, VA.  
N3907.5-W7807.5/7.5

1972

AMS 5362 II NW—SERIES V034

FOR SALE BY U.S. GEOLOGICAL SURVEY, WASHINGTON, D. C. 20242  
AND VIRGINIA DIVISION OF MINERAL RESOURCES, CHARLOTTESVILLE, VIRGINIA 22903

MAY 10 1974

1500