

5163 IV NW
(SUNNYVALE)

UNITED STATES
DEPARTMENT OF THE INTERIOR
GEOLOGICAL SURVEY



ROPER SCHOOL QUADRANGLE
COLORADO-ADAMS CO.
7.5 MINUTE SERIES (TOPOGRAPHIC)

5163 I NW
(LEADER NW)

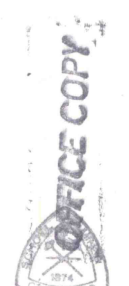
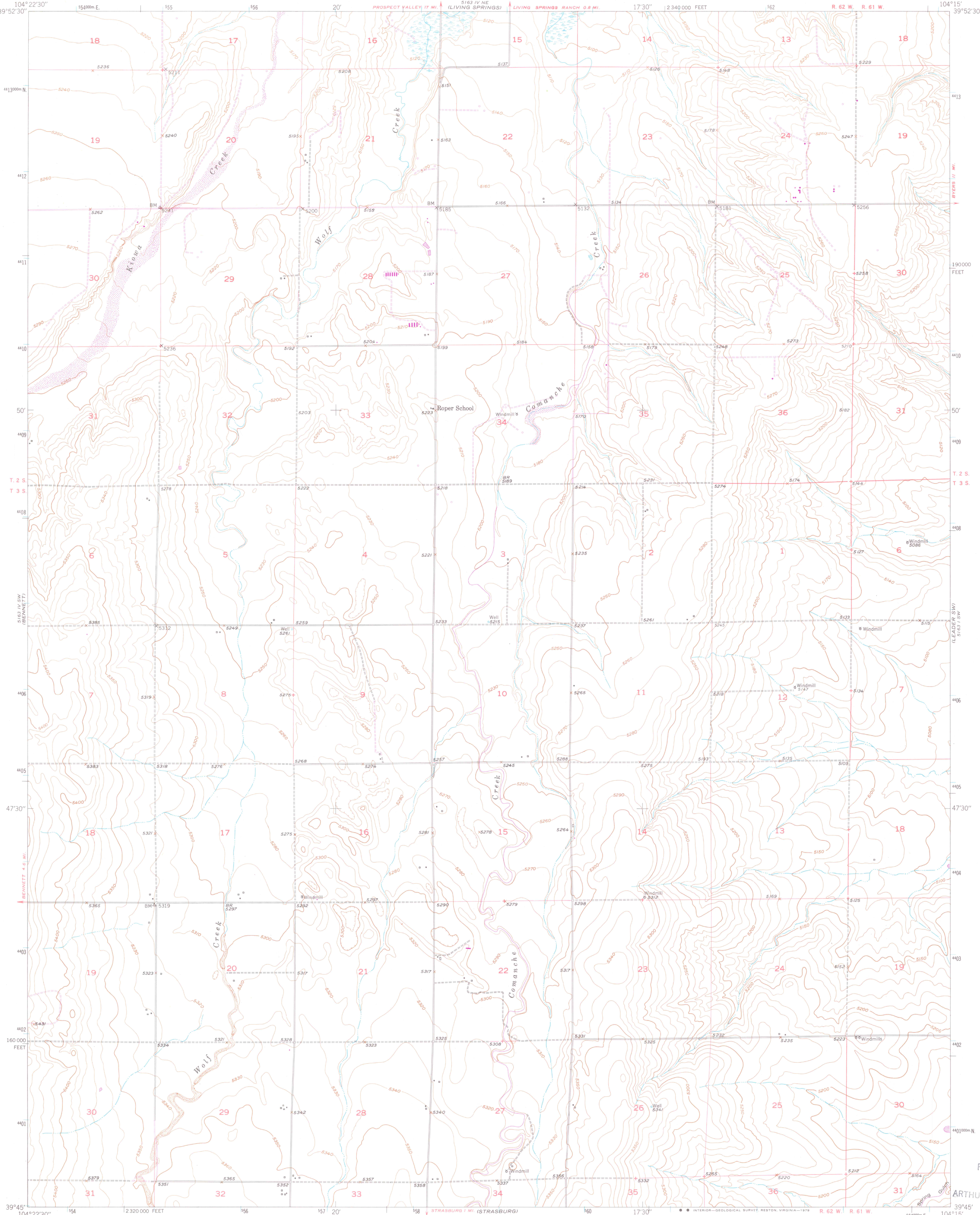

FEB 20 1980
MAP ROOM
ARTHUR LAKES LIBRARY

Mapped, edited, and published by the Geological Survey as part of the Department of the Interior program for the development of the Missouri River Basin. Control by USGS and NOS/NOAA. Culture and drainage in part compiled from aerial photographs taken October 1948 and May 1949. Topography by plane-table methods, 1950. Polyconic projection. 1927 North American datum 10,000-foot grid based on Colorado coordinate system, north zone. 1000-meter Universal Transverse Mercator grid ticks. zone 13, shown in blue. Revisions shown in purple compiled from aerial photographs taken 1975 and other source data. This information not field checked. Map edited 1978.

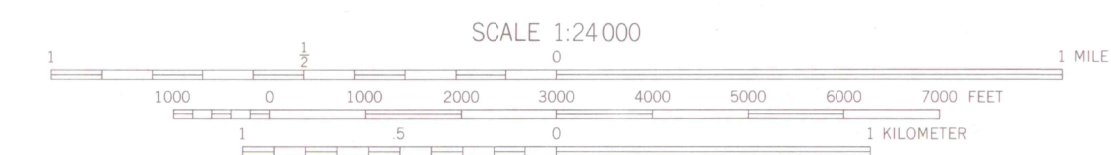
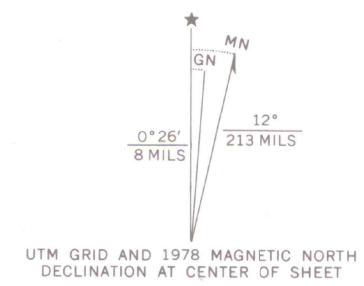

CONTOUR INTERVAL 10 FEET
NATIONAL GEODETIC VERTICAL DATUM OF 1929

THIS MAP COMPLIES WITH NATIONAL MAP ACCURACY STANDARDS
FOR SALE BY U. S. GEOLOGICAL SURVEY, DENVER, COLORADO 80225, OR RESTON, VIRGINIA 22092
A FOLDER DESCRIBING TOPOGRAPHIC MAPS AND SYMBOLS IS AVAILABLE ON REQUEST



ROAD CLASSIFICATION
HARD-SURFACE ALL WEATHER ROADS
Heavy-duty... LAVERGNE LANE Light-duty...
Medium-duty... LAVERGNE LANE Unimproved dirt...
U. S. Route State Route

ROPER SCHOOL, COLO.
N3945-W10415/7.5

1950
PHOTOREVISED 1978
DMA 5163 IV SE-SERIES V877

LIBRARY USE ONLY