

5051 I NW  
ROCK HOUSE  
CANYON

UNITED STATES  
DEPARTMENT OF THE INTERIOR  
GEOLOGICAL SURVEY

PANTHER HILL QUADRANGLE  
NEW MEXICO-CHAVES CO.  
7.5 MINUTE SERIES (TOPOGRAPHIC)

5051 I NW  
GOYOTE DRAW

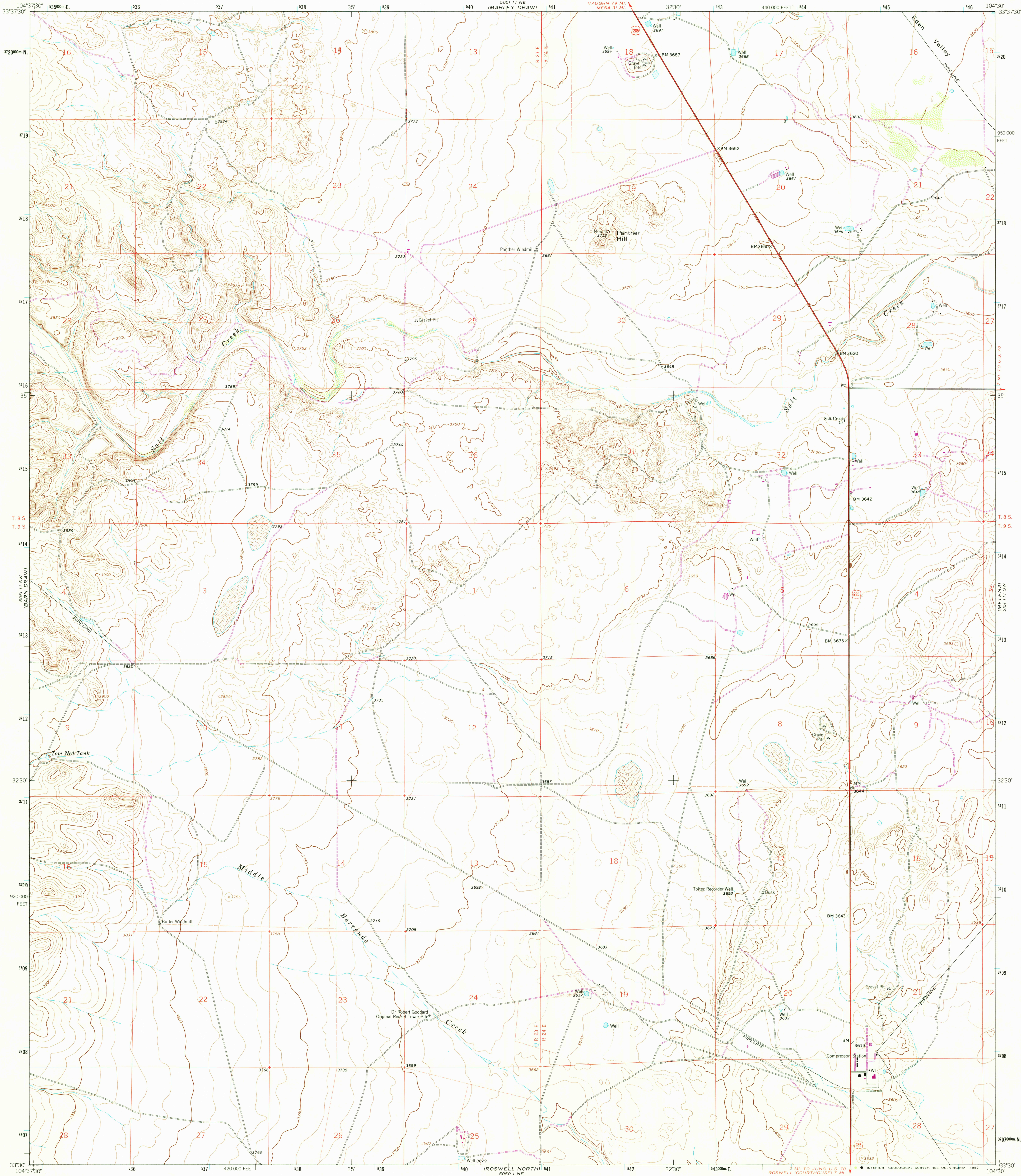

Mapped, edited, and published by the Geological Survey

Control by USGS and NOS/NOAA

Topography by photogrammetric methods from aerial photographs taken 1961. Field checked 1962

Polyconic projection. 10,000-foot grid ticks based on New Mexico coordinate system, east zone. 1000-meter Universal Transverse Mercator grid ticks, zone 13, shown in blue. 1927 North American Datum. To place on the predicted North American Datum 1983 move the projection lines 6 meters south and 48 meters east as shown by dashed corner ticks

Fine red dashed lines indicate selected fence lines

Revisions shown in purple and woodland compiled from aerial photographs taken 1979 and other sources. This information not field checked. Map edited 1982

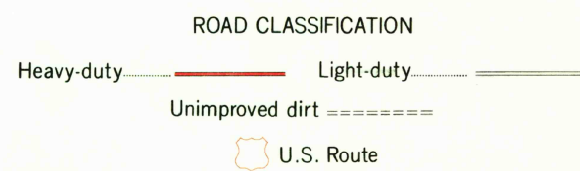
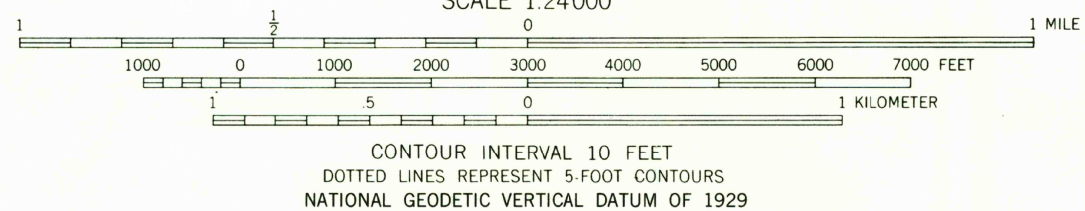
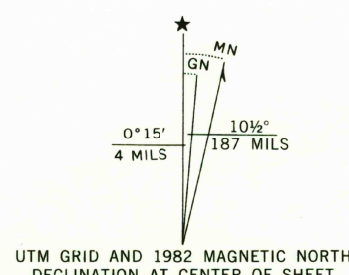

THIS MAP COMPLIES WITH NATIONAL MAP ACCURACY STANDARDS  
FOR SALE BY U.S. GEOLOGICAL SURVEY, DENVER, COLORADO 80225, OR RESTON, VIRGINIA 22092  
A FOLDER DESCRIBING TOPOGRAPHIC MAPS AND SYMBOLS IS AVAILABLE ON REQUEST

PANTHER HILL, N. MEX.  
N3330-W10430/7.5

1962  
PHOTOREVISED 1982  
DMA 5051 II SE-SERIES V881

RETURN TO  
USGS AND HISTORICAL MAP ARCHIVES

5051 I NW  
ENTER LAKE  
ROAD 1/4 NW

MAR 10 1983

2604