

DEPARTMENT OF THE INTERIOR
FRANKLIN K. LANE, SECRETARY
U. S. GEOLOGICAL SURVEY
GEORGE OTIS SMITH, DIRECTOR

TOPOGRAPHY
WAR DEPARTMENT
CORPS OF ENGINEERS, U. S. ARMY

NEW MEXICO
(DONA ANA COUNTY)
MT. RILEY QUADRANGLE

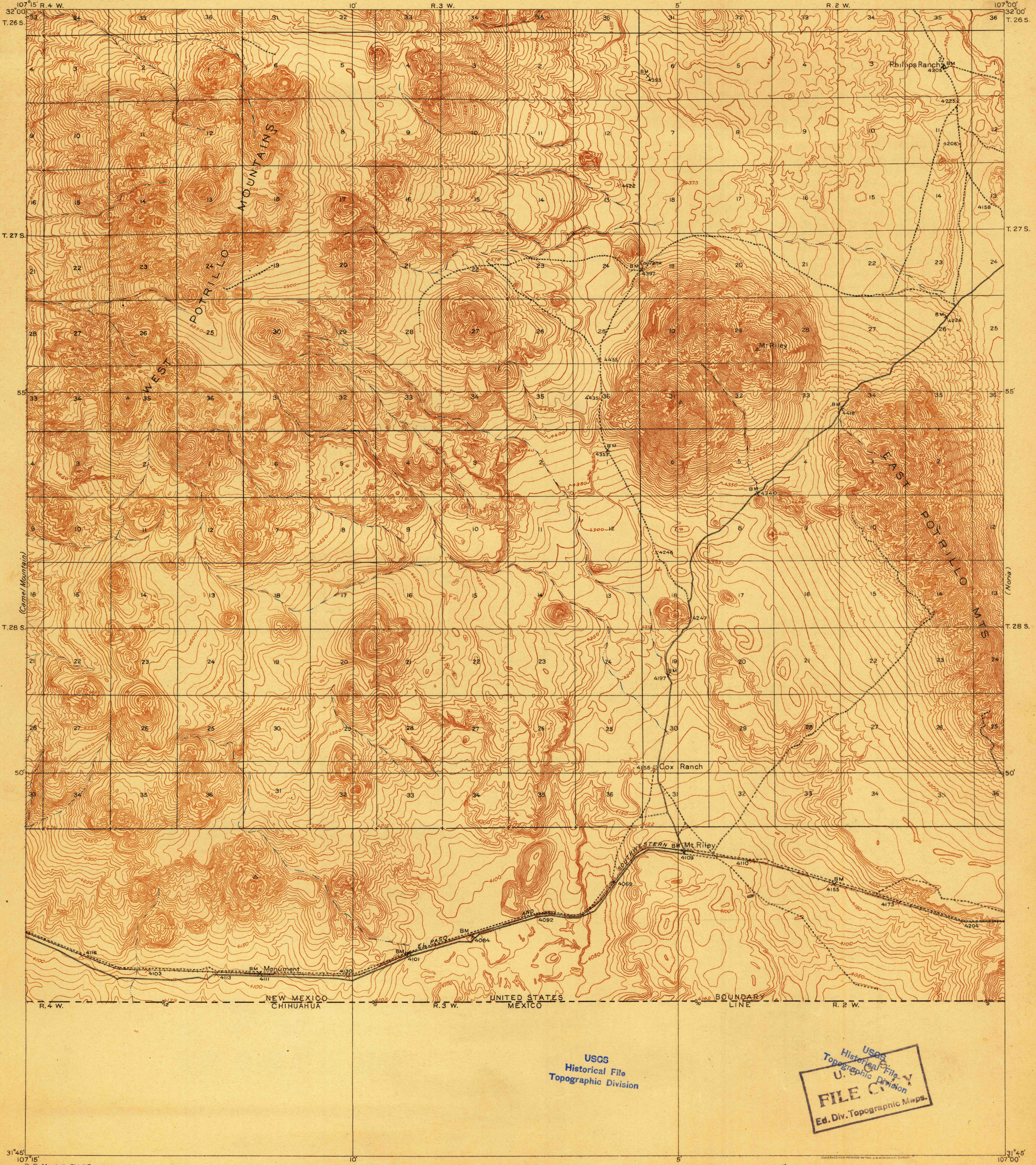

R. B. Marshall, Chief Geographer.
T. G. Gerdine, Geographer in charge.
Glenn S. Smith, Topographic Engineer
in charge Military Surveys.
Topography by C. E. Giffin, H. L. McDonald, A. J. Ogle,
J. L. Lewis, W. R. Chenoweth and Bishop Moorhead
Control by International Boundary Commission, C. L. Nelson,
and R. W. Burchard.
Surveyed in 1917.

L	C
McD	
G	
M	

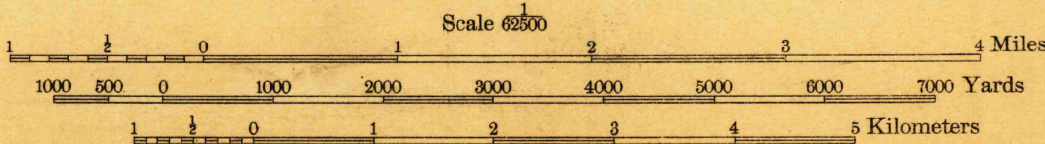

Contour interval 10 feet
Datum is mean sea level

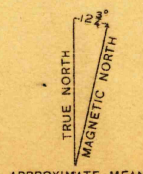

Edition of 1918

JAN 31 1918 2/20

MT. RILEY, N.M.
2120