

UNITED STATES
DEPARTMENT OF THE INTERIOR
GEOLOGICAL SURVEY

WAR DEPARTMENT

NEW MEXICO-TEXAS
NEWMAN QUADRANGLE
15-MINUTE SERIES

U.S.G.S.
FILE COPY
Inspection and Editing.

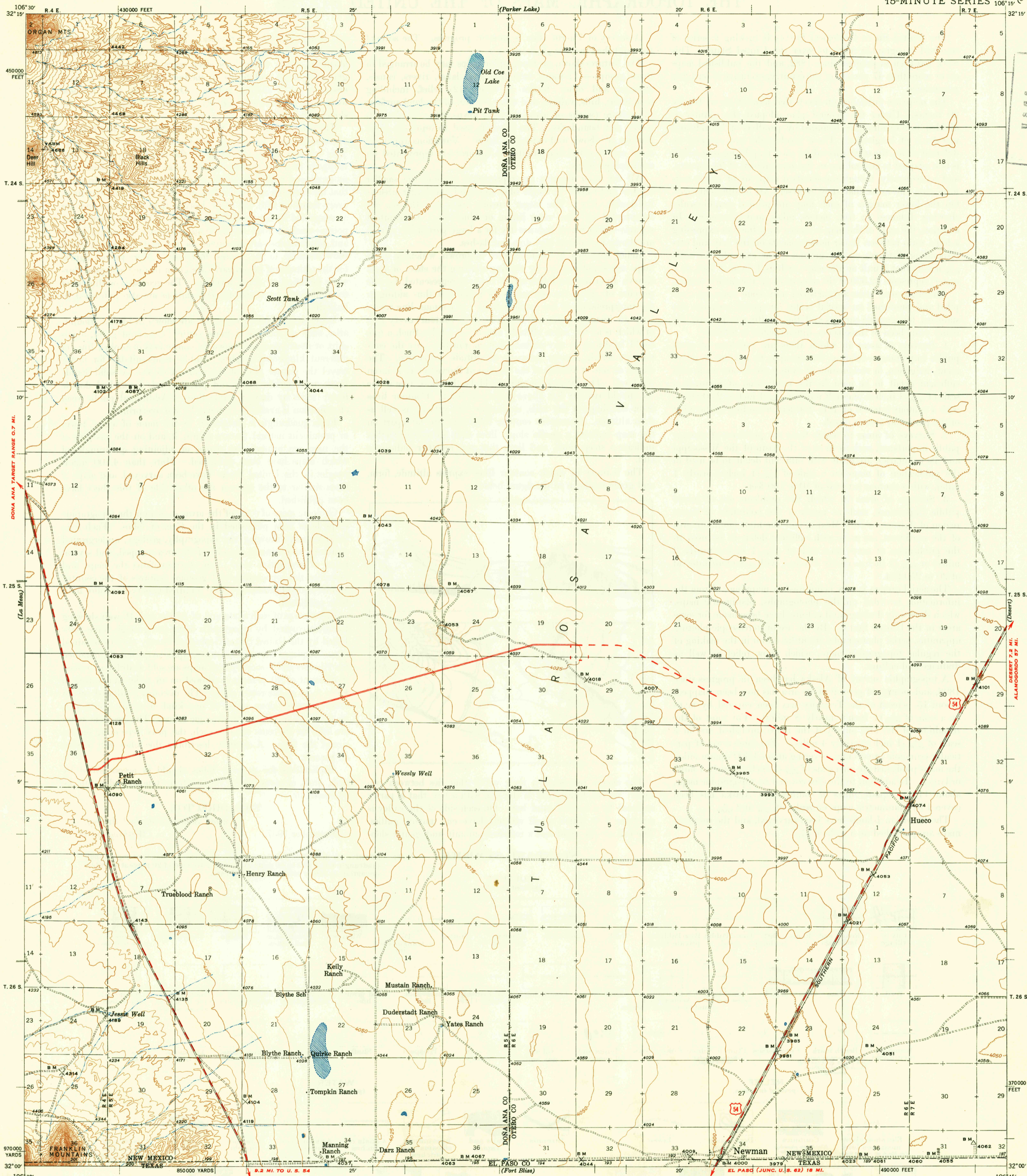

Topography by C. E. Walker, F. L. Gregg,
R. E. Mann, and W. Bell
Surveyed in 1940

ROAD CLASSIFICATION
HARD-SURFACE ALL WEATHER ROADS DRY WEATHER ROADS
Heavy-duty ———— 1 LANE 16' LANE Improved dirt ————
Medium-duty ———— 1 LANE 16' LANE Unimproved dirt ————
Loose-surface, graded, or narrow hard-surface ————
U. S. Route State Route
ROADS UNSURVEYED

TRUE NORTH
MAGNETIC NORTH
APPROXIMATE MEAN
DECLINATION, 1940

SCALE 1:62,500
3000 0 3000 6000 9000 12000 15000 18000 21000 FEET
1 5 0 1 2 3 4 5 KILOMETERS

Contour interval 25 feet
Datum is mean sea level

Polyconic projection. 1927 North American datum
5000 yard grid based on U. S. zone system, E
10000 foot grid based on New Mexico (Central)
rectangular coordinate system

NEWMAN, N. MEX.-TEX.
Edition of 1943
Reprinted 1949
N3200-W10615/15

USGS
Historical File
Topographic Division
FILE COPY
Inspection and Editing.

FEB 1 1949

3225