

UNITED STATES  
DEPARTMENT OF THE INTERIOR  
GEOLOGICAL SURVEY

CRESTON QUADRANGLE  
WASHINGTON  
7.5 MINUTE SERIES (TOPOGRAPHIC)

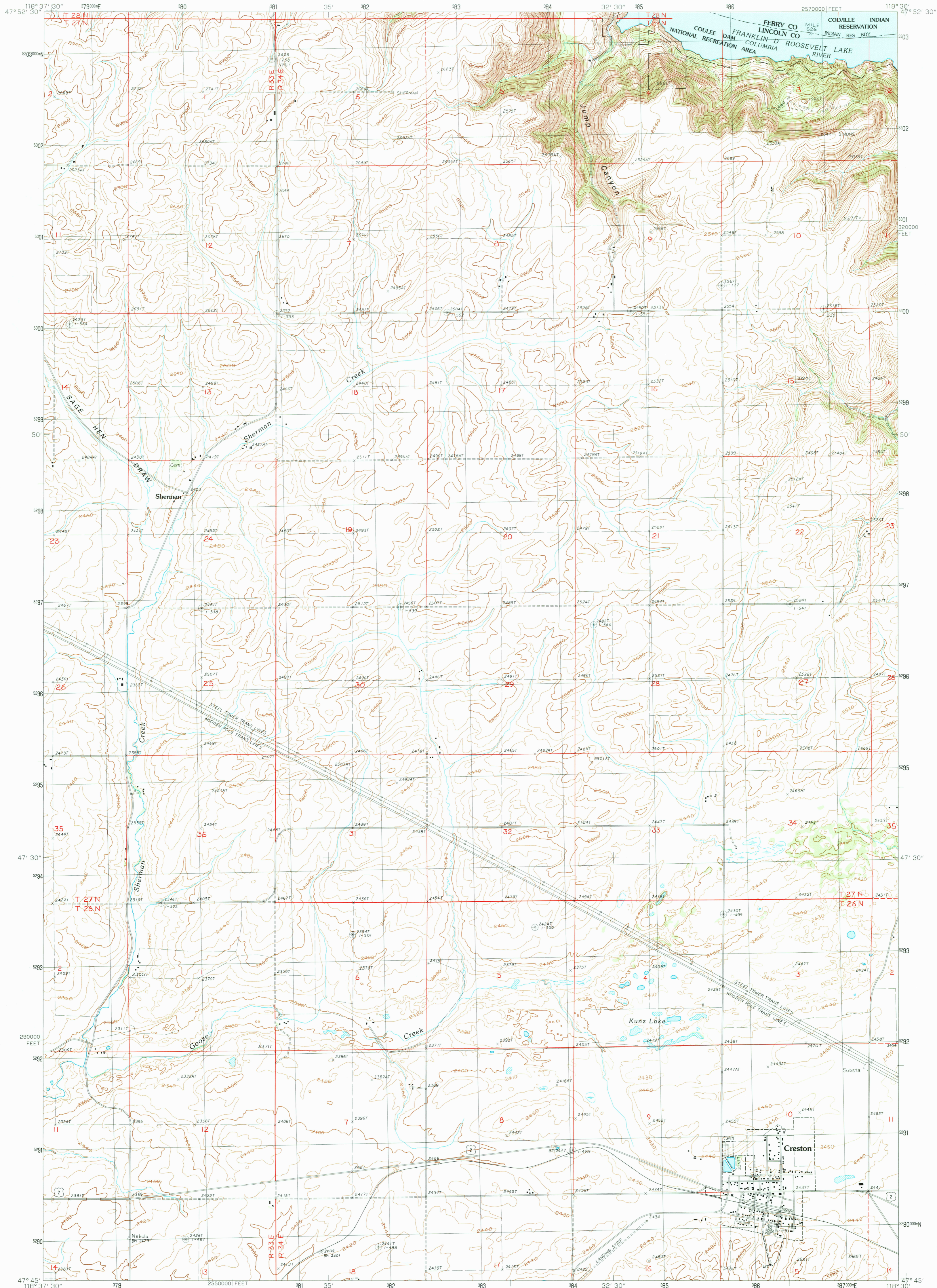

PRODUCED BY THE UNITED STATES GEOLOGICAL SURVEY  
CONTROL BY THE UNITED STATES GEOLOGICAL SURVEY  
COMPILED FROM AERIAL PHOTOGRAPHS TAKEN IN 1983  
FIELD CHECKED 1986. MAP EDITED 1989  
PROJECTION: LAMBERT CONFORMAL CONIC  
GRID: 1000-METER UNIVERSAL TRANSVERSE MERCATOR, ZONE 11  
10,000-FOOT STATE GRID TICKS  
UTM GRID DECLINATION 1909 WEST  
1989 MAGNETIC NORTH DECLINATION 19 00' EAST  
VERTICAL DATUM: NATIONAL GEODETIC VERTICAL DATUM OF 1929  
HORIZONTAL DATUM: 1927 NORTH AMERICAN DATUM  
To place on the predicted North American Datum of 1983,  
move the projection lines as shown by dashed corner ticks  
(17 meters north and 83 meters east)  
There may be private inholdings within the boundaries of any  
Federal or State reservations shown on this map  
No distinction made between houses, barns, and other buildings

PROVISIONAL MAP  
Produced from original  
manuscript drawings.  
Information shown as of date of  
photography.

SCALE 1:24 000  
INTERIOR—GEOLOGICAL SURVEY, RESTON, VIRGINIA—1989  
1 0 1 KILOMETERS  
1 0 1 METERS  
1 0 1 MILES  
1 0 1 FEET  
CONTOUR INTERVAL 20 FEET  
SUPPLEMENTARY CONTOUR INTERVAL 10 FEET  
To convert meters to feet multiply by 3.2808  
To convert feet to meters multiply by .3048  
THIS MAP COMPLIES WITH NATIONAL MAP ACCURACY STANDARDS  
FOR SALE BY U.S. GEOLOGICAL SURVEY, DENVER, COLORADO 80225, OR RESTON, VIRGINIA 22092

1	2	3	1 Keller Ferry
4	5	2 Whitestone Rock	3 Johnny George Mtn.
6	7	5 Lincoln	6 Wagner Lake
		7 Creston Butte	8 Telford

ADJOINING 7.5 QUADRANGLE NAMES

CRESTON, WASHINGTON  
PROVISIONAL EDITION 1989  
47118-G5-TF-024

USGS NMD HISTORICAL MAP  
NOV 13 1989  
REC'D FILE COPY