

UNITED STATES
DEPARTMENT OF THE INTERIOR
GEOLOGICAL SURVEY

SPRAGUE QUADRANGLE
WASHINGTON
7.5 MINUTE SERIES (TOPOGRAPHIC)
SW/4 SPRAGUE 15' QUADRANGLE

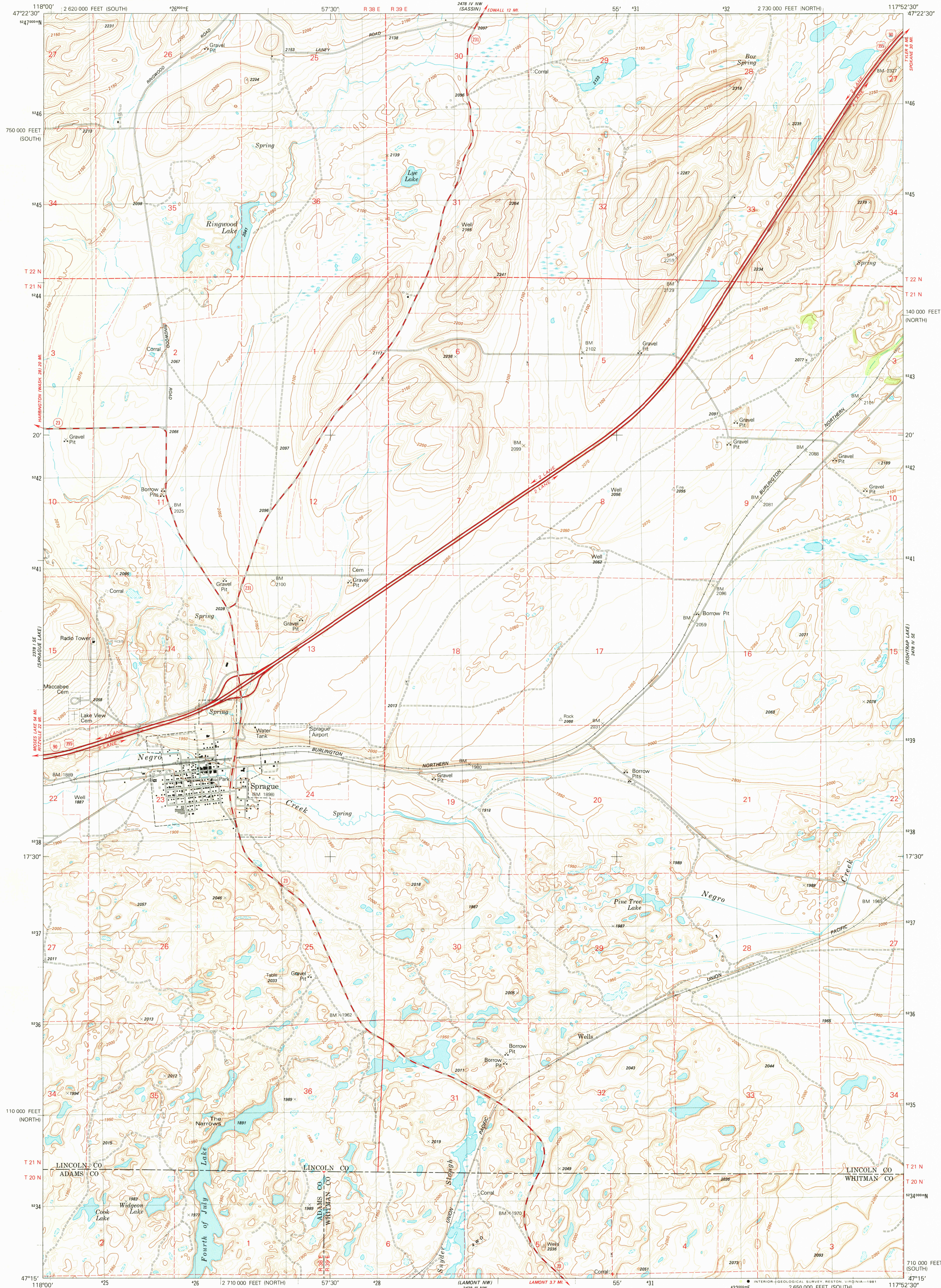

Maped, edited, and published by the Geological Survey

Control by USGS and NOS/NOAA

Topography by photogrammetric methods from aerial
photographs taken 1975. Field checked 1975
Map edited 1981

Projection: Washington coordinate system, north zone
(Lambert conformal conic)
10,000-foot grid ticks based on Washington coordinate system,
north and south zones

1000-meter Universal Transverse Mercator grid, zone 11
1927 North American Datum
To place on the predicted North American Datum 1983
move the projection lines 17 meters north and
81 meters east as shown by dashed corner ticks

Fine red dashed lines indicate selected fence and field lines where
generally visible on aerial photographs. This information is unchecked

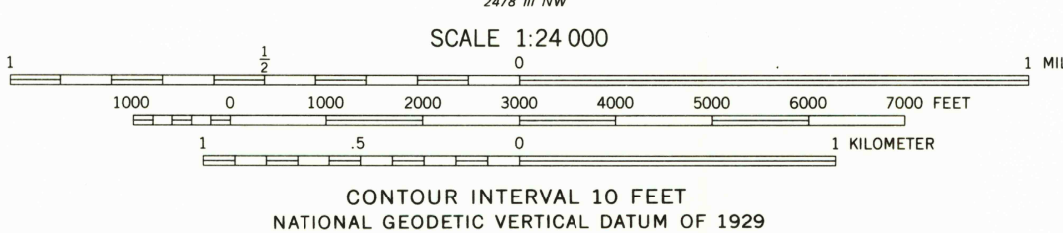
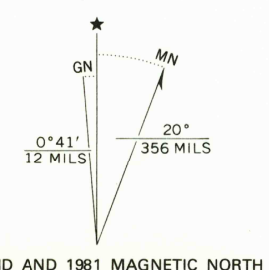

ROAD CLASSIFICATION

Primary highway, hard surface	Light-duty road, hard or improved surface
Secondary highway, hard surface	Unimproved road
Interstate Route	U. S. Route
	State Route

SPRAGUE, WASH.
SW/4 SPRAGUE 15' QUADRANGLE
N4715-W11752.5/7.5

1981

DMA 2478 IV SW-SERIES V891

USGS
Historical File
National Mapping Div.
2000
MAR 12 1981