

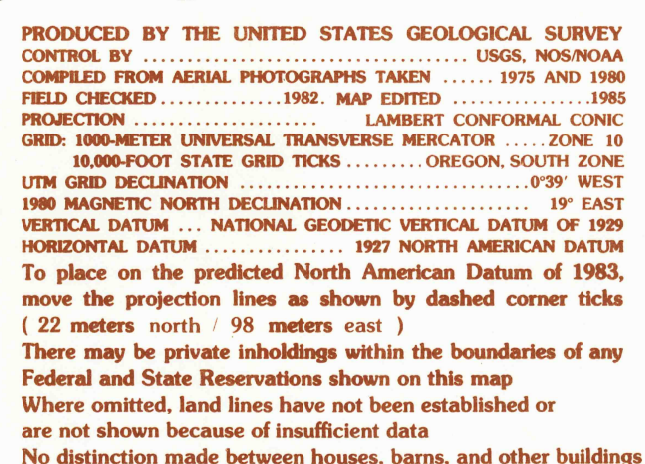



DEER HEAD POINT QUADRANGLE
OREGON-DOUGLAS CO.
7.5 MINUTE SERIES (TOPOGRAPHIC)



FEET
CONTOUR INTERVAL 40 FEET
CONTROL ELEVATIONS SHOWN TO THE NEAREST 0.1 FOOT
OTHER ELEVATIONS SHOWN TO THE NEAREST FOOT
To convert meters to feet multiply by 3.2808
To convert feet to meters multiply by 0.3048

ROAD LEGEND

Improved Road.....
Unimproved Road.....
Trail.....

 Interstate Route  U.S. Route  State Route

DEER HEAD POINT, OREG.
PROVISIONAL EDITION 1985

FOR SALE BY U.S. GEOLOGICAL SURVEY, DENVER, COLORADO 80225, OR RESTON, VIRGINIA 22092

43123-E8-TE-024