

WICKIUP MTN. QUADRANGLE  
OREGON—CLATSOP CO.  
7.5 MINUTE SERIES (TOPOGRAPHIC)

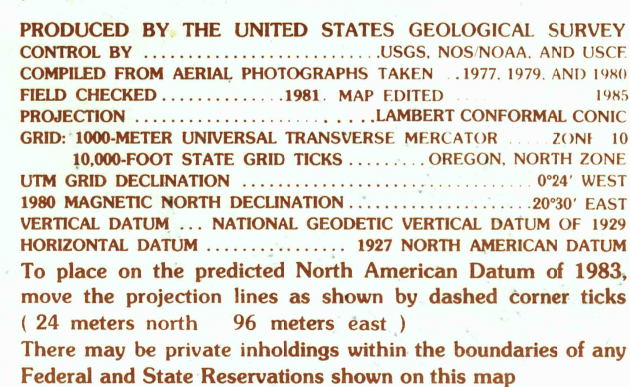

**SCALE 1:24 000**

The graphic scale bar is divided into four units: Kilometers (0 to 1), Meters (0 to 1000), Miles (0 to 1), and Feet (0 to 7000). The Kilometers scale has a mark at 0.5. The Meters scale has a mark at 500. The Miles scale has a mark at 0.5. The Feet scale has marks at 2000, 3000, 4000, 5000, 6000, and 7000.

**CONTOUR INTERVAL 40 FEET**

CONTROL ELEVATIONS SHOWN TO THE NEAREST 0.1 FOOT  
OTHER ELEVATIONS SHOWN TO THE NEAREST FOOT

To convert meters to feet multiply by 3.2808  
To convert feet to meters multiply by 0.3048



1	2	3	1 Cathlamet Bay
4		5	2 Knappa
6	7	8	3 Cathlamet
			4 Green Mtn.
			5 Nicolai Mtn.
			6 Saddle Mtn.
			7 Vinemapple
			8 Sager Creek

**ROAD LEGEND**

Improved Road.....

Unimproved Road.....

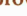
Trail.....

 Interstate Route     U.S. Route     State Route

**WICKIUP MTN., OREG.**

**PROVISIONAL EDITION 1985**

FOR SALE BY U. S. GEOLOGICAL SURVEY, DENVER, COLORADO 80225, OR RESTON, VIRGINIA 22092

46123-A5-TF-024

