

UNITED STATES
DEPARTMENT OF THE INTERIOR
GEOLOGICAL SURVEY

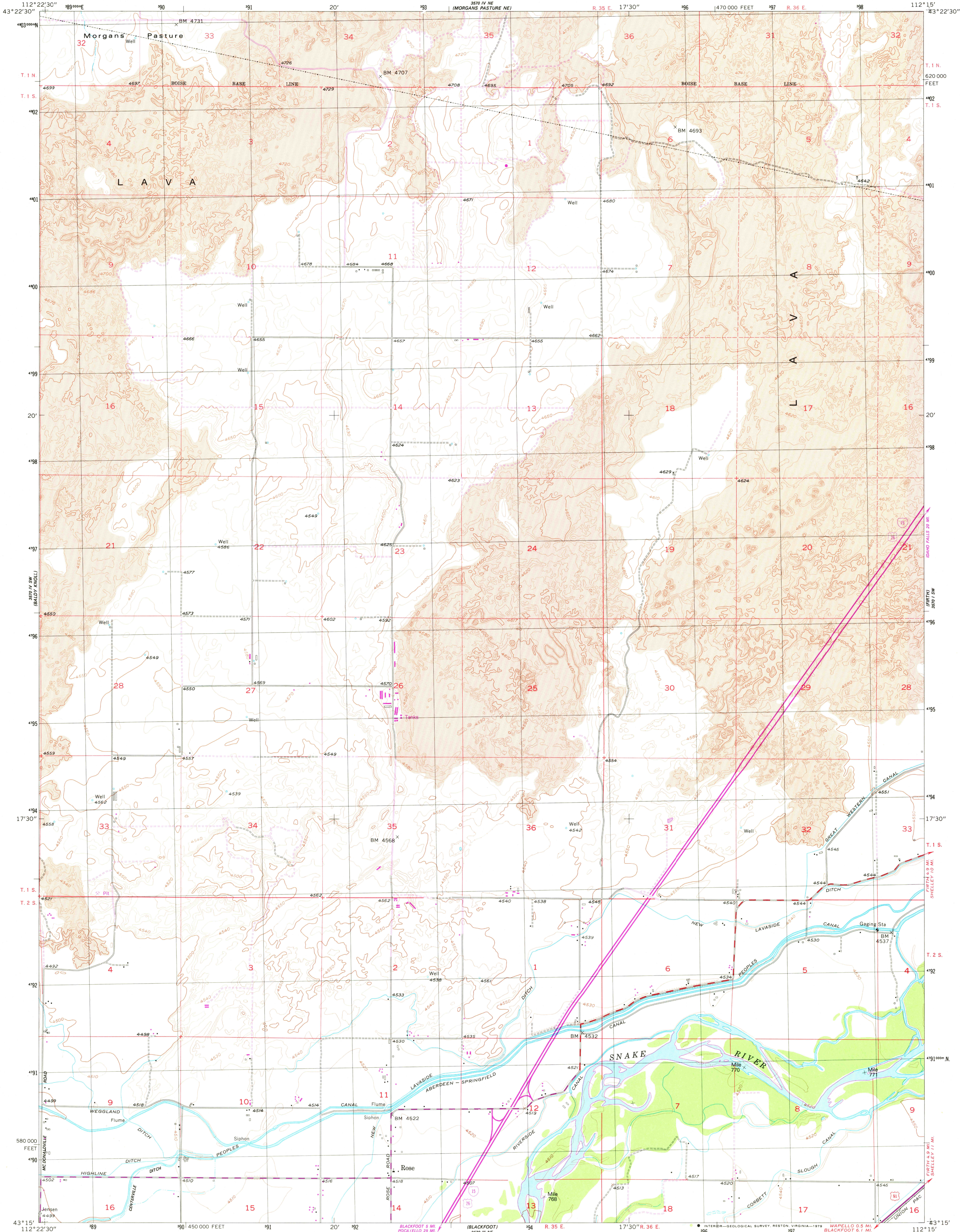

ROSE QUADRANGLE
IDAHO-BINGHAM CO.
7.5 MINUTE SERIES (TOPOGRAPHIC)



Mapped, edited, and published by the Geological Survey
Control by USGS and NOS/NOAA

Topography from aerial photographs by Kelsh plotter
and by planetable surveys 1955. Aerial photographs taken 1950

Polyconic projection. 1927 North American datum
10,000-foot grid based on Idaho coordinate system, east zone

1927 North American datum
1000-meter Universal Transverse Mercator grid, zone 12

To place on the predicted North American Datum 1983,
move the projection lines 12 meters north and
66 meters east as shown by dashed corner ticks

Revisions shown in purple and woodland compiled from
aerial photographs taken 1976 and other source data

This information not field checked. Map edited 1979

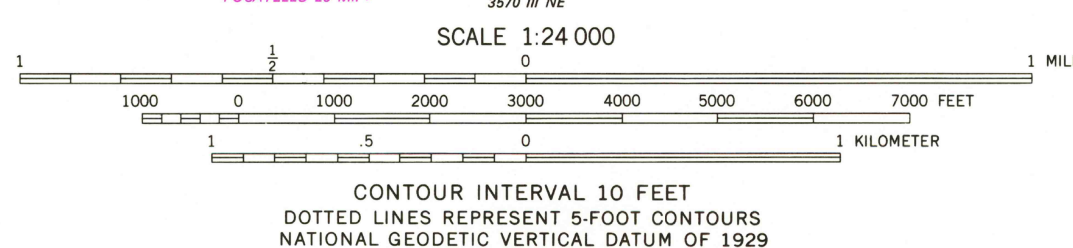
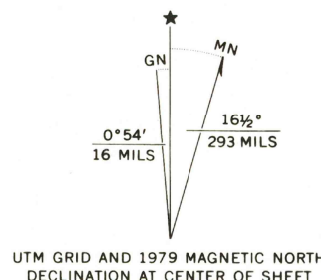

THIS MAP COMPLIES WITH NATIONAL MAP ACCURACY STANDARDS
FOR SALE BY U.S. GEOLOGICAL SURVEY, DENVER, COLORADO 80225, OR RESTON, VIRGINIA 22092
A FOLDER DESCRIBING TOPOGRAPHIC MAPS AND SYMBOLS IS AVAILABLE ON REQUEST



ROAD CLASSIFICATION
Heavy-duty ——— Light-duty ———
Medium-duty ——— Unimproved dirt ———
U.S. Route ——— State Route ———
Interstate Route ———

USGS
Historical File
Topographic Division

ROSE, IDAHO
N4315-W11215/7.5

1955
PHOTOREVISED 1979
DMA 3570 IV SE-SERIES V893

APR 16 1980
1930