

UNITED STATES  
DEPARTMENT OF THE INTERIOR  
GEOLOGICAL SURVEY

SHOSHONE QUADRANGLE  
IDAHO—LINCOLN CO.  
7.5 MINUTE SERIES (TOPOGRAPHIC)

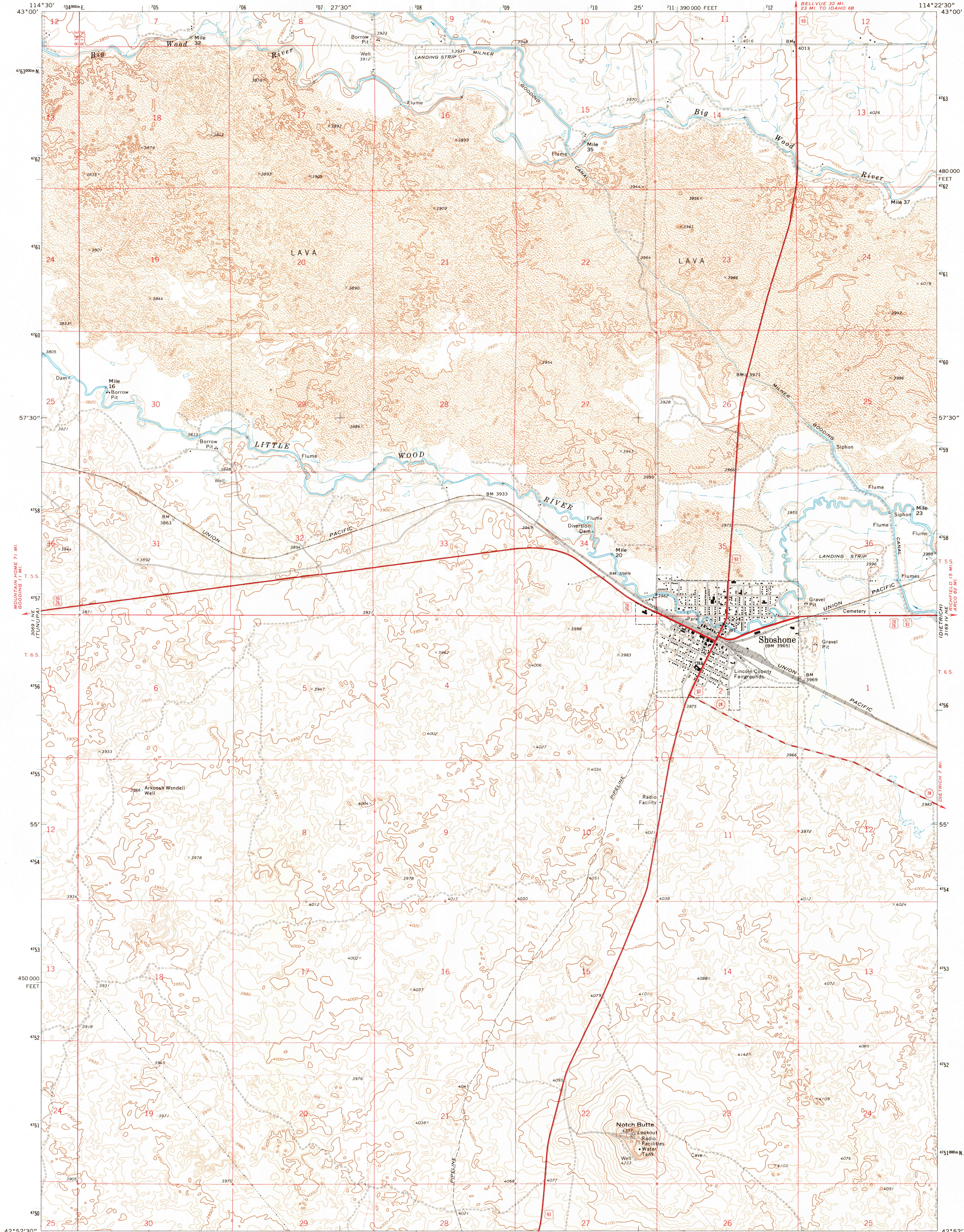

Mapped, edited, and published by the Geological Survey  
Control by USGS and USC&GS  
Topography by photogrammetric methods from aerial  
photographs taken 1969. Field checked 1971  
Projection and 10,000-foot grid ticks: Idaho coordinate  
system, central zone (transverse Mercator)  
1000-meter Universal Transverse Mercator grid ticks,  
zone 11, shown in blue. 1927 North American datum  
Fine red dashed lines indicate selected fence lines

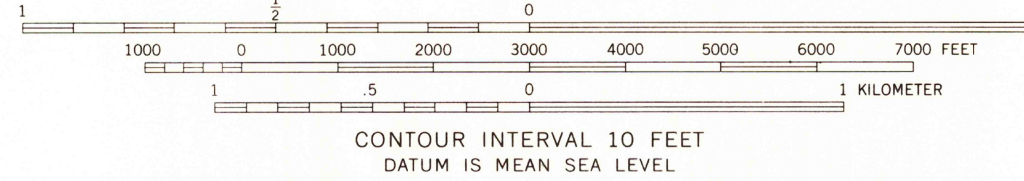
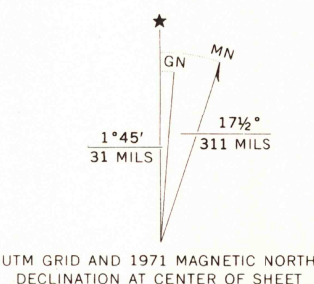

ROAD CLASSIFICATION  
Primary highway, hard surface ————  
Light-duty road, hard or improved surface ————  
Secondary highway, hard surface ————  
Unimproved road ————  
Interstate Route ————  
U. S. Route ————  
State Route ————



THIS MAP COMPLIES WITH NATIONAL MAP ACCURACY STANDARDS  
FOR SALE BY U. S. GEOLOGICAL SURVEY, DENVER, COLORADO 80225, OR RESTON, VIRGINIA 22092  
A FOLDER DESCRIBING TOPOGRAPHIC MAPS AND SYMBOLS IS AVAILABLE ON REQUEST

SHOSHONE, IDAHO  
N4252.5—W11422.5/7.5  
1971

AMS 3169 IV NW—SERIES Y883