

6579 IV SE
(EMERADO)

UNITED STATES
DEPARTMENT OF THE INTERIOR
GEOLOGICAL SURVEY

GRAND FORKS SW QUADRANGLE
NORTH DAKOTA—GRAND FORKS CO.
7.5 MINUTE SERIES (TOPOGRAPHIC)
SW/4 GRAND FORKS 15' QUADRANGLE

6579 IV NE
(GRAND FORKS)

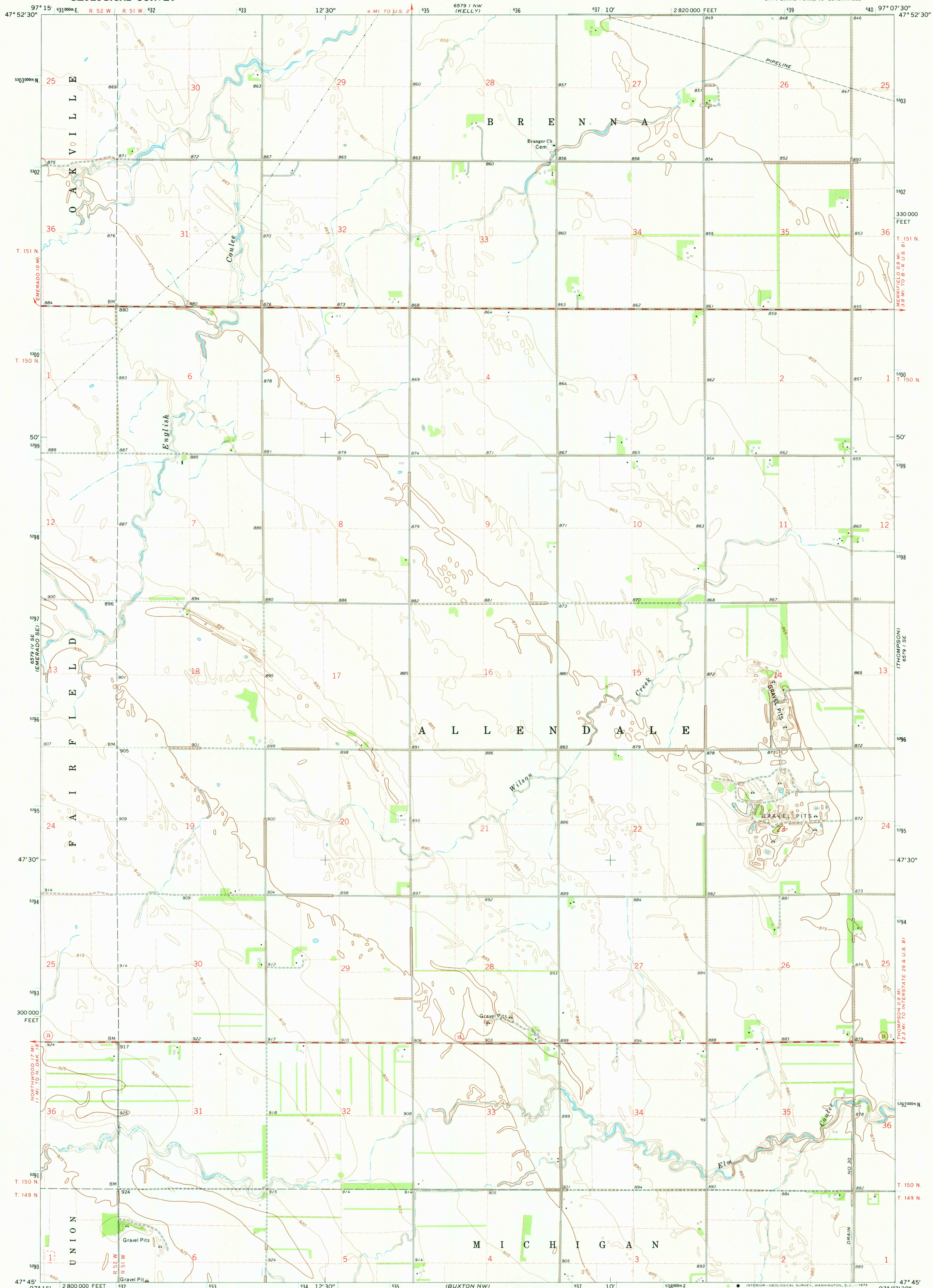

Maped, edited, and published by the Geological Survey
Control by USGS and USC&GS
Planimetry by photogrammetric methods from aerial photographs
taken 1965. Topography by planetable surveys 1971
Polyconic projection. 1927 North American datum
10,000-foot grid based on North Dakota coordinate system,
north zone
1000-meter Universal Transverse Mercator grid ticks,
zone 14, shown in blue
Fine red dashed lines indicate selected fence and field lines
where generally visible on aerial photographs
This information is unchecked

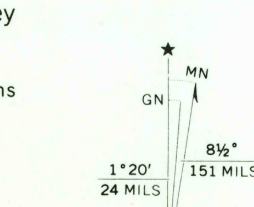

CONTOUR INTERVAL 5 FEET
DATUM IS MEAN SEA LEVEL
SCALE 1:24,000
1 MILE
1 KILOMETER

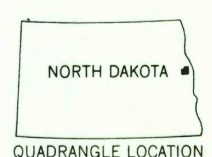

ROAD CLASSIFICATION
Primary highway, hard surface
Secondary highway, hard surface
Light-duty road, hard or improved surface
Unimproved road
Interstate Route
U. S. Route
State Route

GRAND FORKS SW, N. DAK.
SW/4 GRAND FORKS 15' QUADRANGLE
N4745-W9707.5/7.5
1971
AMS 6579 I SW—SERIES V871

MAY 29 1973