

UNITED STATES  
DEPARTMENT OF THE INTERIOR  
GEOLOGICAL SURVEY

NEW TOWN QUADRANGLE  
NORTH DAKOTA—MOUNTRAIL CO.  
7.5 MINUTE SERIES (TOPOGRAPHIC)

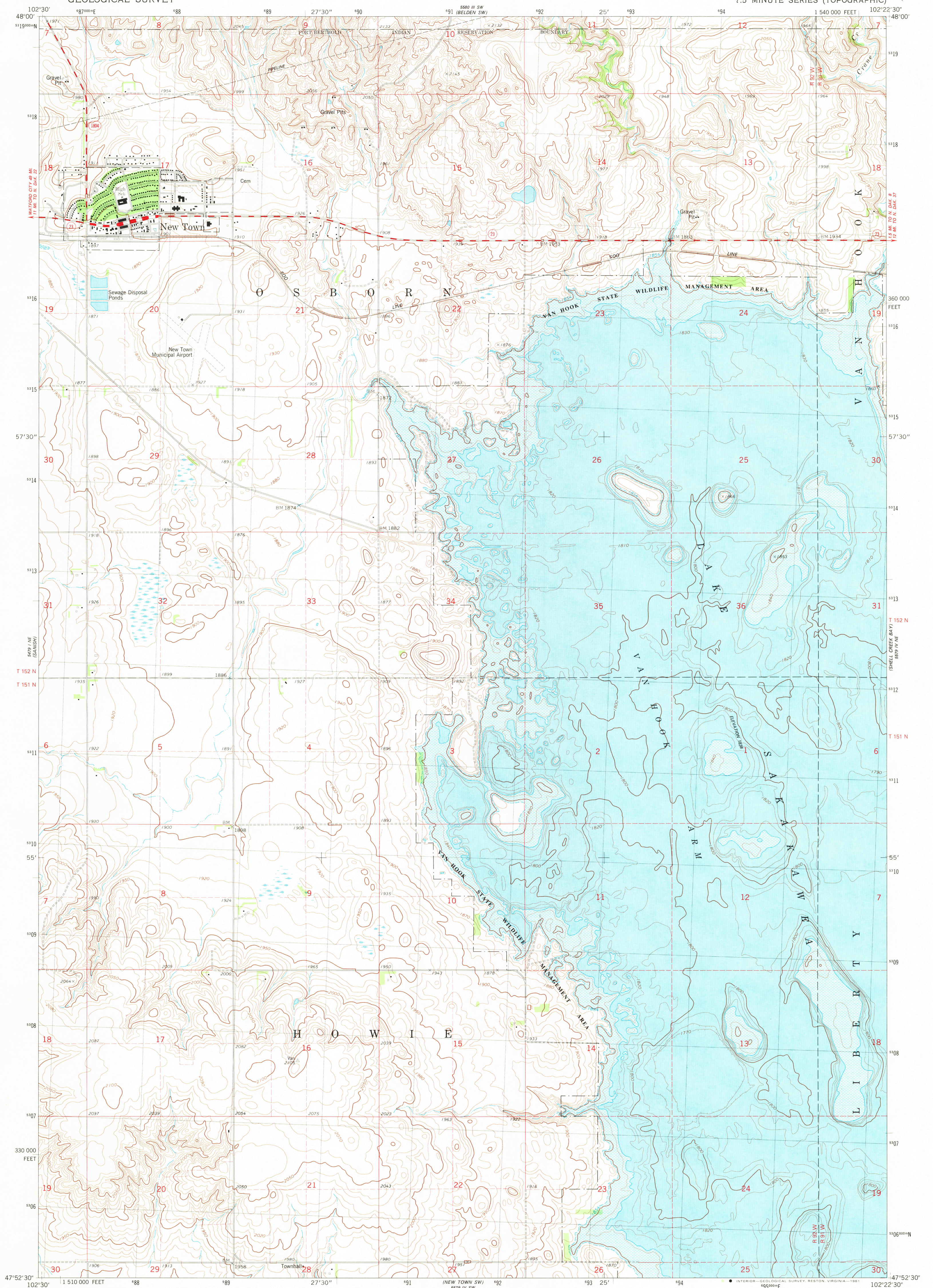

Mapped, edited, and published by the Geological Survey

Control by USGS and NOS/NOAA  
Topography by photogrammetric methods from aerial photographs taken 1973 and 1977. Field checked 1975. Map edited 1981  
Underwater contours in Lake Sakakawea from USCE maps dated 1949

Projection and 10,000-foot grid ticks: North Dakota coordinate system, north zone (Lambert conformal conic)  
1000-meter Universal Transverse Mercator grid, zone 13  
1927 North American Datum  
To place on the predicted North American Datum 1983 move the projection lines 3 meters north and 36 meters east as shown by dashed corner ticks  
There may be private inholdings within the boundaries of the National or State reservations shown on this map

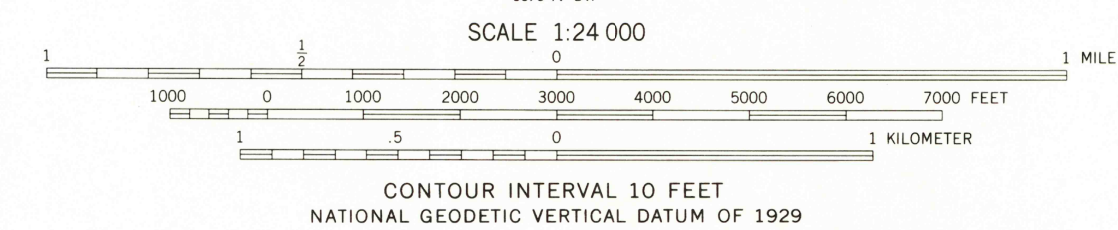
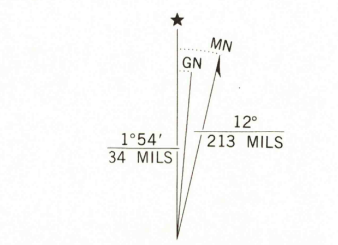

THIS MAP COMPLIES WITH NATIONAL MAP ACCURACY STANDARDS  
FOR SALE BY U.S. GEOLOGICAL SURVEY, DENVER, COLORADO 80225, OR RESTON, VIRGINIA 22092  
AND BY THE STATE WATER COMMISSION, BISMARCK, NORTH DAKOTA 58501  
A FOLDER DESCRIBING TOPOGRAPHIC MAPS AND SYMBOLS IS AVAILABLE ON REQUEST

ROAD CLASSIFICATION  
Primary highway, hard surface  
Secondary highway, hard surface  
Light-duty road, hard or improved surface  
Unimproved road  
Interstate Route  
U.S. Route  
State Route

QUADRANGLE LOCATION  
Areas covered by dashed light-blue pattern are subject to controlled inundation

NEW TOWN, N. DAK.  
N4752.5-W10222.5/7.5  
1981  
DMA 5579 IV NW—SERIES V871

RETURN TO:  
USGS HISTORICAL MAP ARCHIVES

NOV 24 1981

1981