

STATE OF CALIFORNIA
FRANK F. MERRIAM, GOVERNOR
EARL LEE KELLY, DIRECTOR OF PUBLIC WORKS
EDWARD HYATT, STATE ENGINEER

DEPARTMENT OF THE INTERIOR
U.S. GEOLOGICAL SURVEY

CALIFORNIA
(KINGS COUNTY)
CHATOM RANCH QUADRANGLE

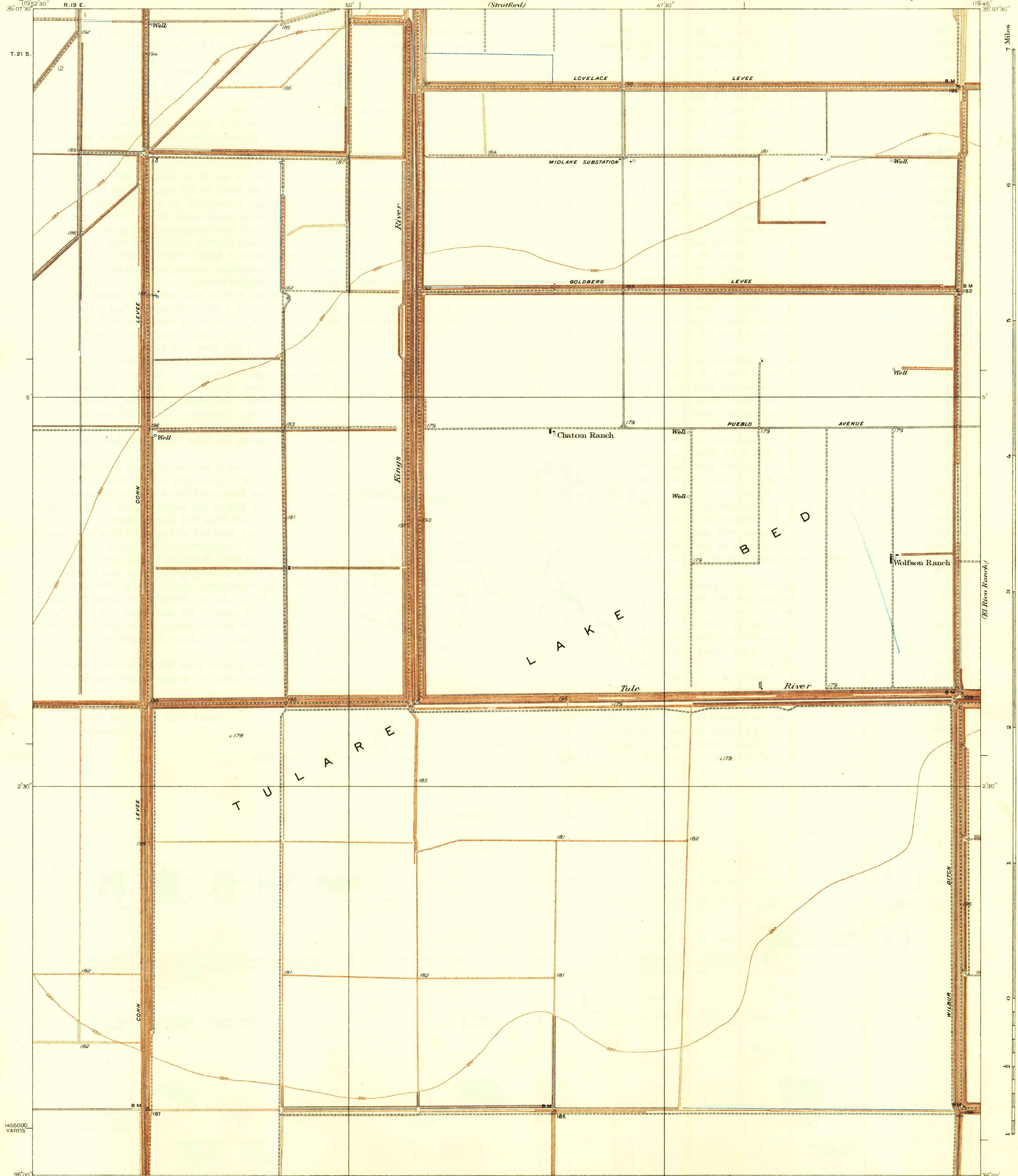

Topography by FAWuopio
Control by U.S. Geological Survey
Surveyed in 1933

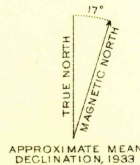

Scale 31680
1 Mile
5000 2500 0 5000 Feet
1 1/2 1/4 0 1/4 1/2 Kilometers
Contour interval 5 feet
Datum is mean sea level

Polyconic projection, North American datum
5000 yard grid based upon U.S. zone system G

USGS
Historical File
Topographic Division

CHATOM RANCH, CALIF.
Edition of 1935

JAN 27 1936 (1940)

1940