

DEPARTMENT OF THE INTERIOR
U. S. GEOLOGICAL SURVEY

STATE OF CALIFORNIA
JAMES ROLPH, JR., GOVERNOR
EARL LEE KELLY, DIRECTOR OF PUBLIC WORKS
EDWARD HYATT, STATE ENGINEER
(Westhaven)

Advance sheet
Subject to correction

CALIFORNIA
(KINGS COUNTY)
KETTELMAN CITY QUADRANGLE

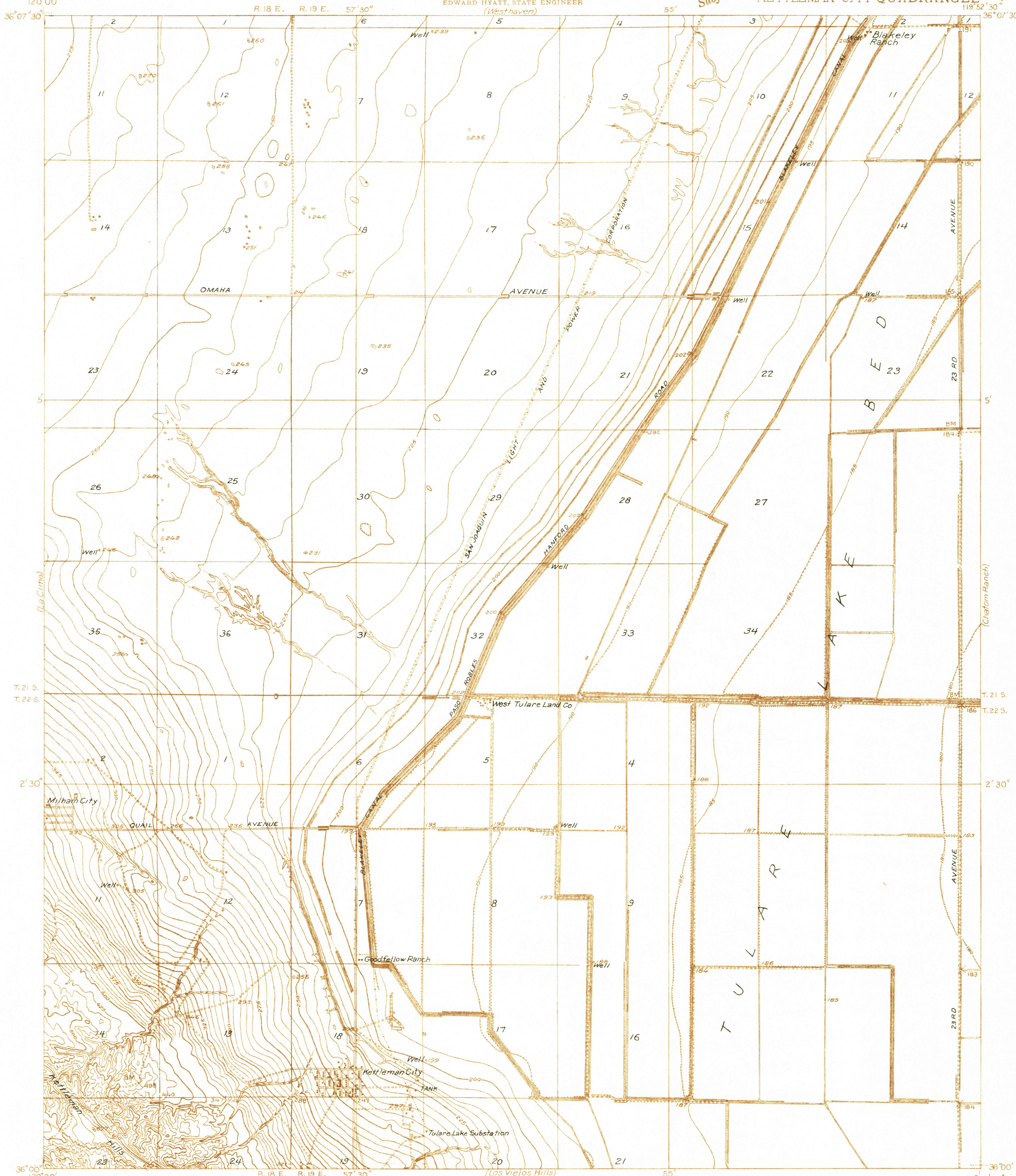

H. H. Hodgeson, Division Engineer
Topography by E. P. Davis and D. H. Rutledge
Control by U. S. Geological Survey
Surveyed in 1930, 1932 and 1933

TRUE NORTH
MAGNETIC NORTH
APPROXIMATE MEAN DECLINATION, 1933

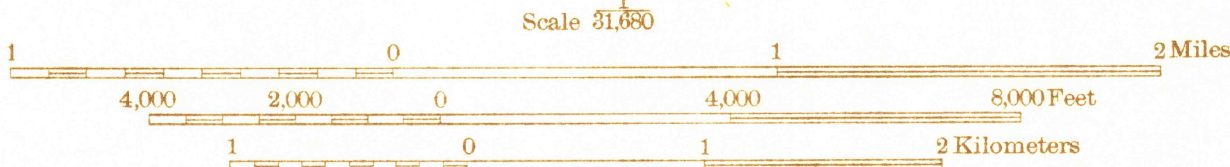

Contour intervals 5 and 25 feet (see diagram)
Datum is mean sea level

Polygonic projection. North American datum
To join Los Viejos Hills, Kettleman Plain,
and La Cima maps, use dotted corners.



KETTELMAN CITY, CALIF.