

UNITED STATES  
DEPARTMENT OF THE INTERIOR  
GEOLOGICAL SURVEY

BUFFALO CREEK QUADRANGLE  
CALIFORNIA—SACRAMENTO CO.  
7.5 MINUTE SERIES (TOPOGRAPHIC)

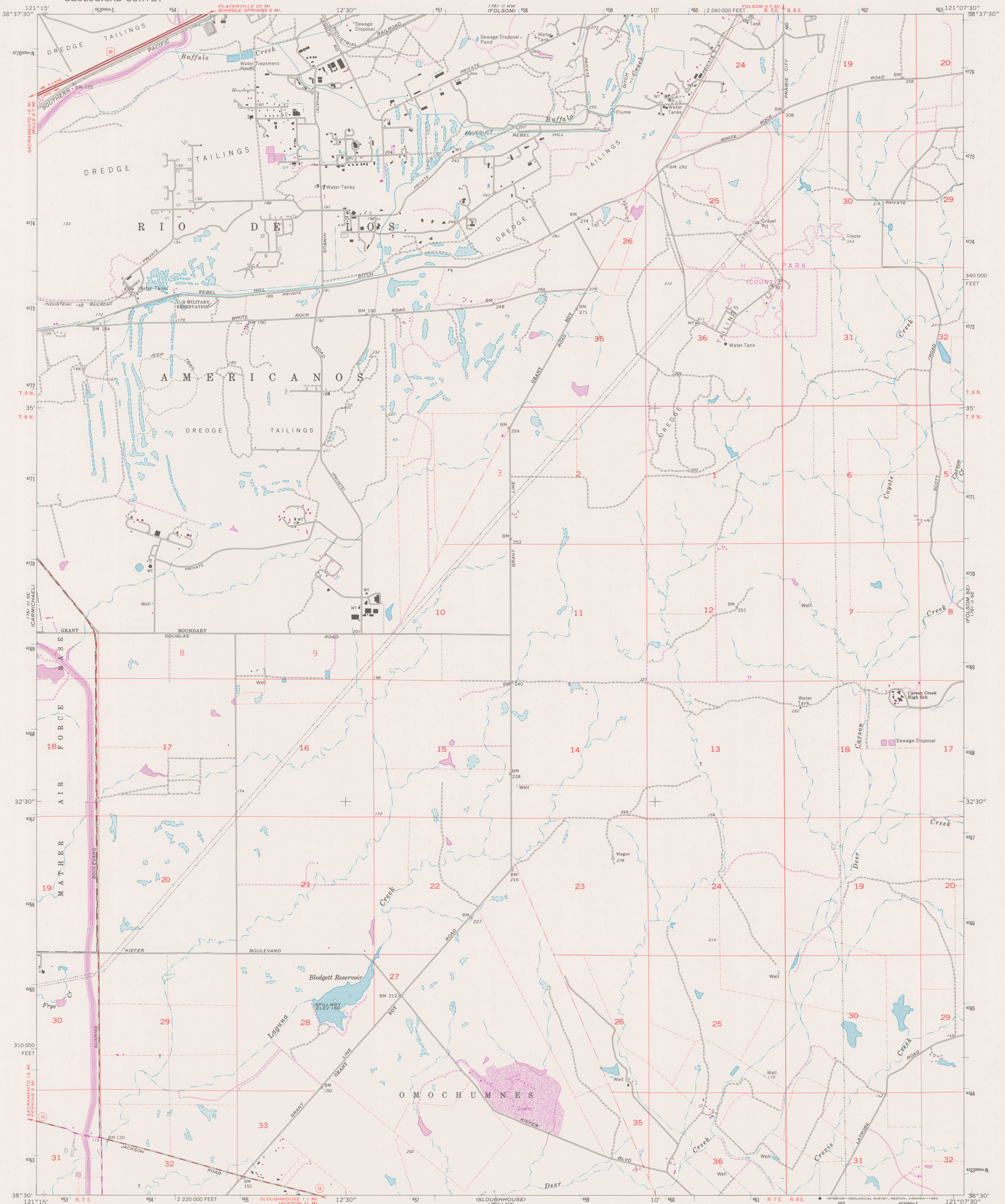

Mapped, edited, and published by the Geological Survey  
in cooperation with California Department of Water Resources

Control by USGS and NOS/NOAA

Topography by photogrammetric methods from aerial photographs  
taken 1952 and planetable surveys 1954. Revised from aerial  
photographs taken 1966. Field checked 1967

Polyconic projection. 1927 North American datum  
10,000-foot grid based on California coordinate system, zone 2  
1000-meter Universal Transverse Mercator grid ticks,  
zone 10, shown in blue

To place on the predicted North American Datum 1983  
move the projection lines 14 meters north and  
91 meters east as shown by dashed corner ticks

There may be private inholdings within the boundaries of  
the National or State reservations shown on this map  
Fine red dashed lines indicate selected fence lines

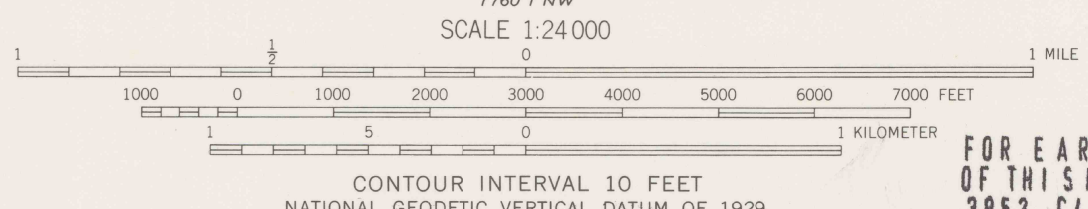
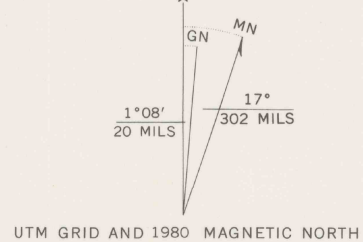

THIS MAP COMPLIES WITH NATIONAL MAP ACCURACY STANDARDS  
FOR SALE BY U. S. GEOLOGICAL SURVEY, DENVER, COLORADO 80225, OR RESTON, VIRGINIA 22092  
A FOLDER DESCRIBING TOPOGRAPHIC MAPS AND SYMBOLS IS AVAILABLE ON REQUEST

FOR EARLIER EDITION  
OF THIS MAP SEE ALSO  
3852 CAS 31 P5  
UNDER SAME QUAD NAME

Revision shown in purple and woodland compiled by the County of  
Sacramento from aerial photographs taken 1978 and other source data  
This information not field checked. Map edited 1980

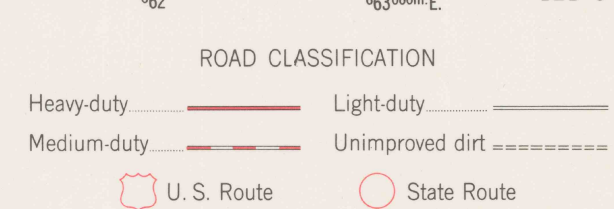

BUFFALO CREEK, CALIF.

N3830—W12107.5/7.5

1967  
PHOTOREVISED 1980  
DMA 1761 II SW—SERIES V895

REFERENCE  
REF  
3700M  
Var  
U5  
7.5  
ed. 1980 P