

UNITED STATES  
DEPARTMENT OF THE INTERIOR  
GEOLOGICAL SURVEY

SOMERTON QUADRANGLE  
ARIZONA—YUMA CO.  
7.5 MINUTE SERIES (TOPOGRAPHIC)  
SW 1/4 YUMA 15' QUADRANGLE

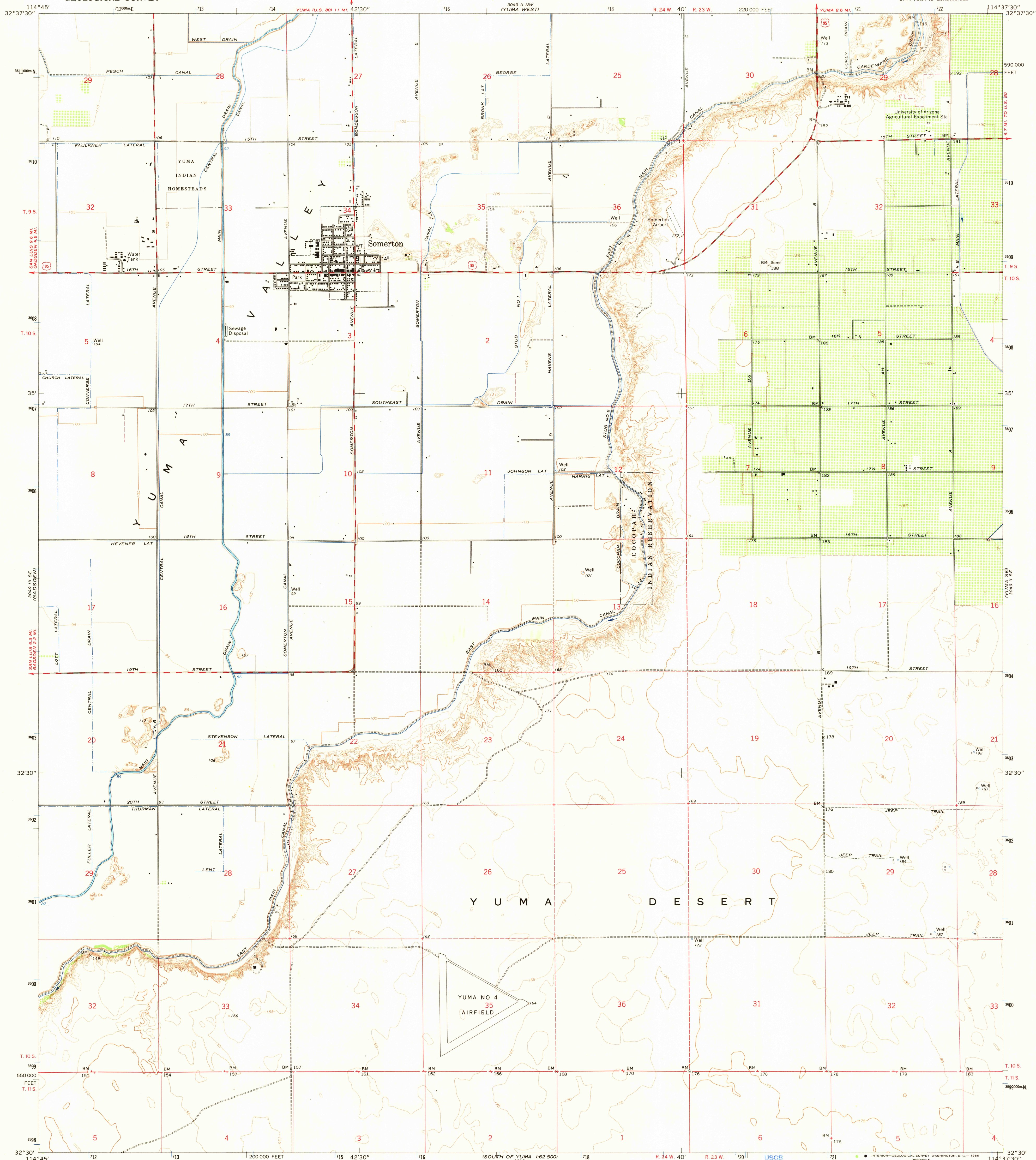

Mapped, edited, and published by the Geological Survey  
Control by USGS, USC&GS, and U. S. Bureau of Reclamation  
Topography by photogrammetric methods from aerial photographs  
taken 1962-63, and from planetable surveys by USBR 1937-38  
and USGS 1965  
Polyconic projection. 1927 North American datum  
10,000-foot grid based on Arizona coordinate system, west zone  
1000-meter Universal Transverse Mercator grid ticks,  
zone 11, shown in blue  
Fine red dashed lines indicate selected fence lines

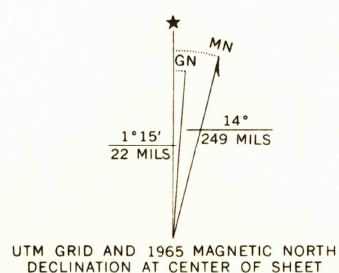

SCALE 1:24,000  
CONTOUR INTERVAL 5 FEET  
DATUM IS MEAN SEA LEVEL  
THIS MAP COMPLIES WITH NATIONAL MAP ACCURACY STANDARDS  
FOR SALE BY U. S. GEOLOGICAL SURVEY, DENVER, COLORADO 80225, OR WASHINGTON, D. C. 20242  
A FOLDER DESCRIBING TOPOGRAPHIC MAPS AND SYMBOLS IS AVAILABLE ON REQUEST

USGS  
Historical File  
Topographic Division  
ROAD CLASSIFICATION  
Medium-duty — Light-duty  
Unimproved dirt — U. S. Route  
U.S.G.S.  
FILE COPY  
TOPOGRAPHIC DIVISION  
SOMERTON, ARIZ.  
SW 1/4 YUMA 15' QUADRANGLE  
N3230—W11437.5/7.5  
1965  
AMS 3049 II SW—SERIES V898

2380