

UNITED STATES
DEPARTMENT OF THE INTERIOR
GEOLOGICAL SURVEY

SANTA FE QUADRANGLE
MISSOURI
7.5 MINUTE SERIES (TOPOGRAPHIC)
SE 1/4 FLORIDA 15' QUADRANGLE

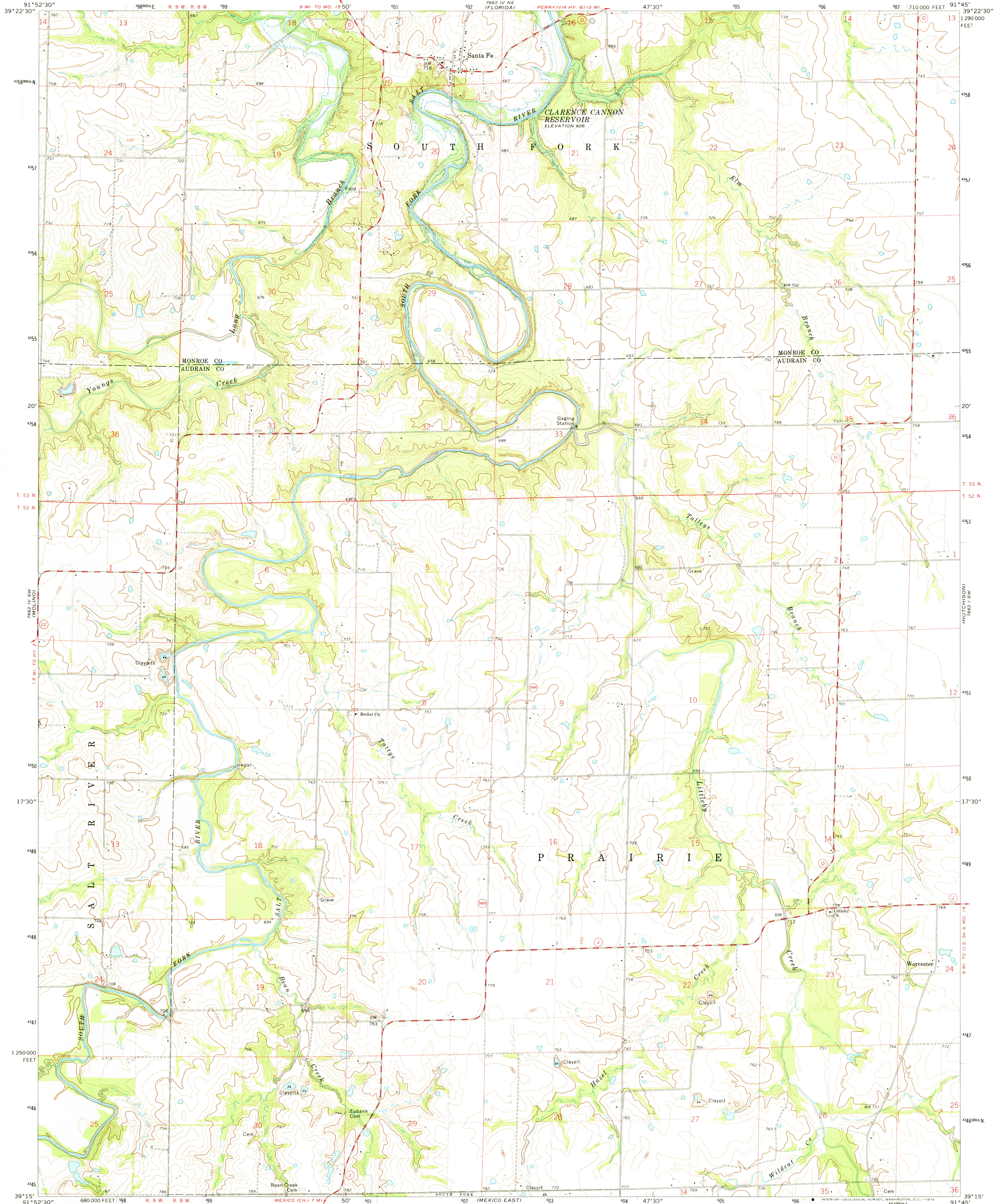

Mapped, edited, and published by the Geological Survey

Control by USGS and USC&GS

Topography by photogrammetric methods from aerial photographs taken 1971. Field checked 1972

Projection and 10,000-foot grid ticks: Missouri coordinate system, central zone (transverse Mercator)

1000-meter Universal Transverse Mercator grid ticks, zone 15, shown in blue. 1927 North American datum

Areas covered by dashed light-blue pattern are subject to controlled inundation

Fine red dashed lines indicate selected fence and field lines where generally visible on aerial photographs. This information is unchecked

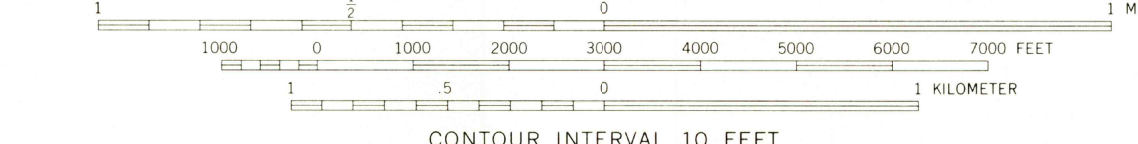
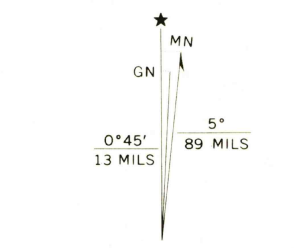

THIS MAP COMPLIES WITH NATIONAL MAP ACCURACY STANDARDS
FOR SALE BY U. S. GEOLOGICAL SURVEY, DENVER, COLORADO 80225, OR WASHINGTON, D. C. 20242
AND BY THE MISSOURI GEOLOGICAL SURVEY, ROLLA, MISSOURI 65401
A FOLDER DESCRIBING TOPOGRAPHIC MAPS AND SYMBOLS IS AVAILABLE ON REQUEST

ROAD CLASSIFICATION
Primary highway, hard surface
Secondary highway, hard surface
Unimproved road
Interstate Route
U. S. Route
State Route



USGS
HISTORICAL FILE
TOPOGRAPHIC DIVISION

SANTA FE, MO.
SE 1/4 FLORIDA 15' QUADRANGLE
N3915-W9145/7.5
1972

3200
AUG 26 1974

AMS 7662 IV SE-SERIES V879