

UNITED STATES  
DEPARTMENT OF THE INTERIOR  
GEOLOGICAL SURVEY

BONNEVILLE SW QUADRANGLE  
WYOMING-FREMONT CO.  
7.5 MINUTE SERIES (TOPOGRAPHIC)

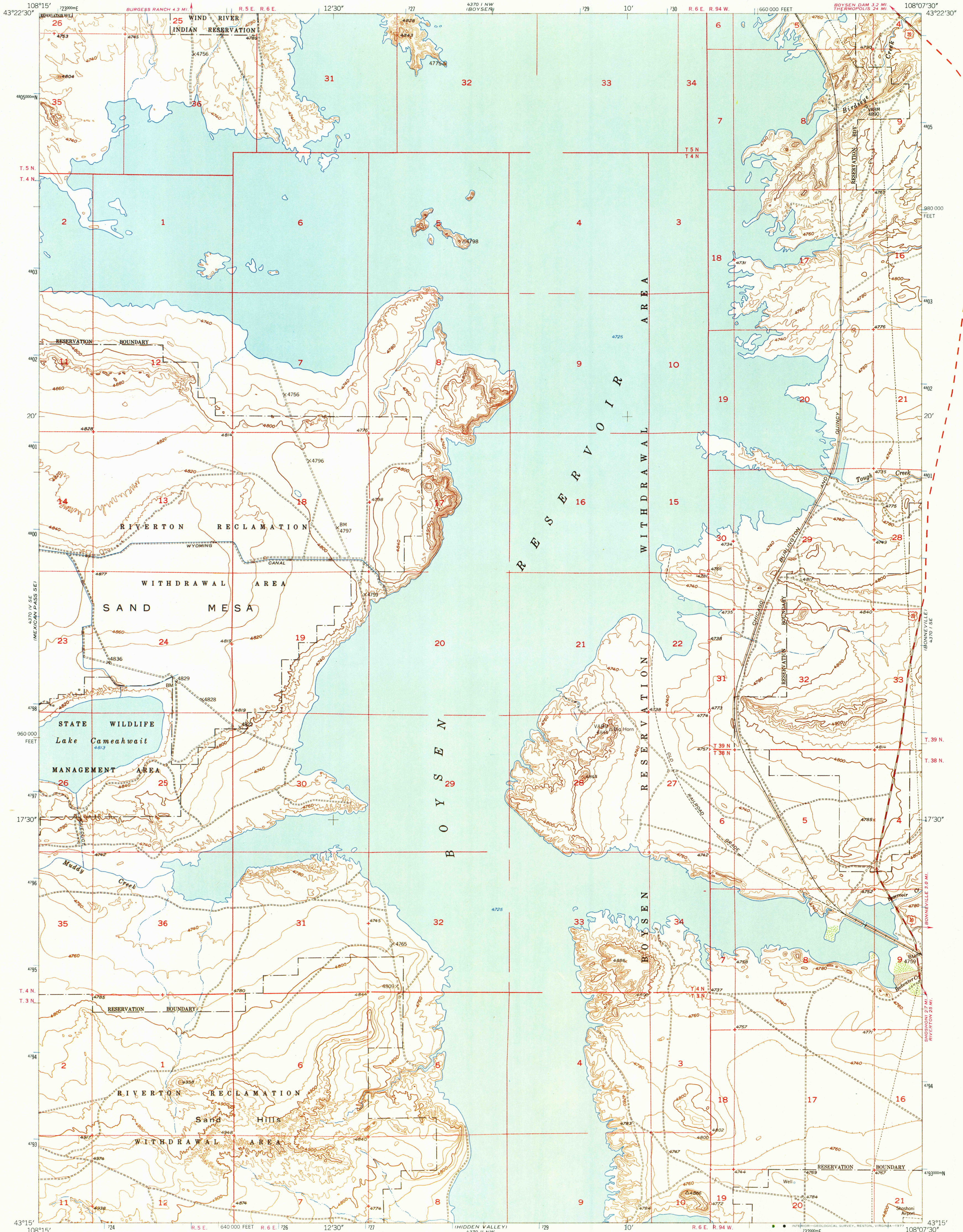

Map by the Geological Survey and the Bureau of Reclamation  
Edited and published by the Geological Survey as part of the  
Department of the Interior program for the development of the  
Missouri River Basin  
Control by USGS and USC&GS  
Topography by planetable surveys, 1942, and from aerial photographs  
by multiplex methods. Aerial photographs taken October 1948.  
Field check 1950. Revised 1958  
Polyconic projection. 1927 North American datum  
10,000-foot grid based on Wyoming coordinate system,  
west central zone  
1000-meter Universal Transverse Mercator grid ticks, zone 12, shown in blue  
T<sub>s</sub>. 3, 4, and 5 N. R<sub>s</sub>. 5 and 6 E. based on the Wind River Meridian.  
T<sub>s</sub>. 38 and T<sub>s</sub>. 39 N., R<sub>s</sub>. 94 W. based on the Sixth Principal Meridian.

SCALE 1:24 000  
1 000 000 2000 3000 4000 5000 6000 7000 FEET  
1 KILOMETRE  
CONTOUR INTERVAL 20 FEET  
NATIONAL GEODETIC VERTICAL DATUM OF 1929  
THIS MAP COMPLIES WITH NATIONAL MAP ACCURACY STANDARDS  
FOR SALE BY U. S. GEOLOGICAL SURVEY, DENVER, COLORADO 80225, OR RESTON, VIRGINIA 22092  
A FOLDER DESCRIBING TOPOGRAPHIC MAPS AND SYMBOLS IS AVAILABLE ON REQUEST

ROAD CLASSIFICATION  
Primary highway, hard surface. Light-duty road, hard or improved surface.  
Secondary highway, hard surface. Unimproved road.  
Interstate Route. U. S. Route. State Route.  
USGS Historical File Topographic Division  
BONNEVILLE SW, WYO.  
N4315-W10807.5/7.5  
1958  
AMS 4370 1 SW-SERIES V874

RETURN TO:  
USGS AND HISTORICAL MAP ARCHIVES

MAR 23 1977

This map was reproduced by electronic color scanning of an earlier printing (1959).