

UNITED STATES
DEPARTMENT OF THE INTERIOR
GEOLOGICAL SURVEY

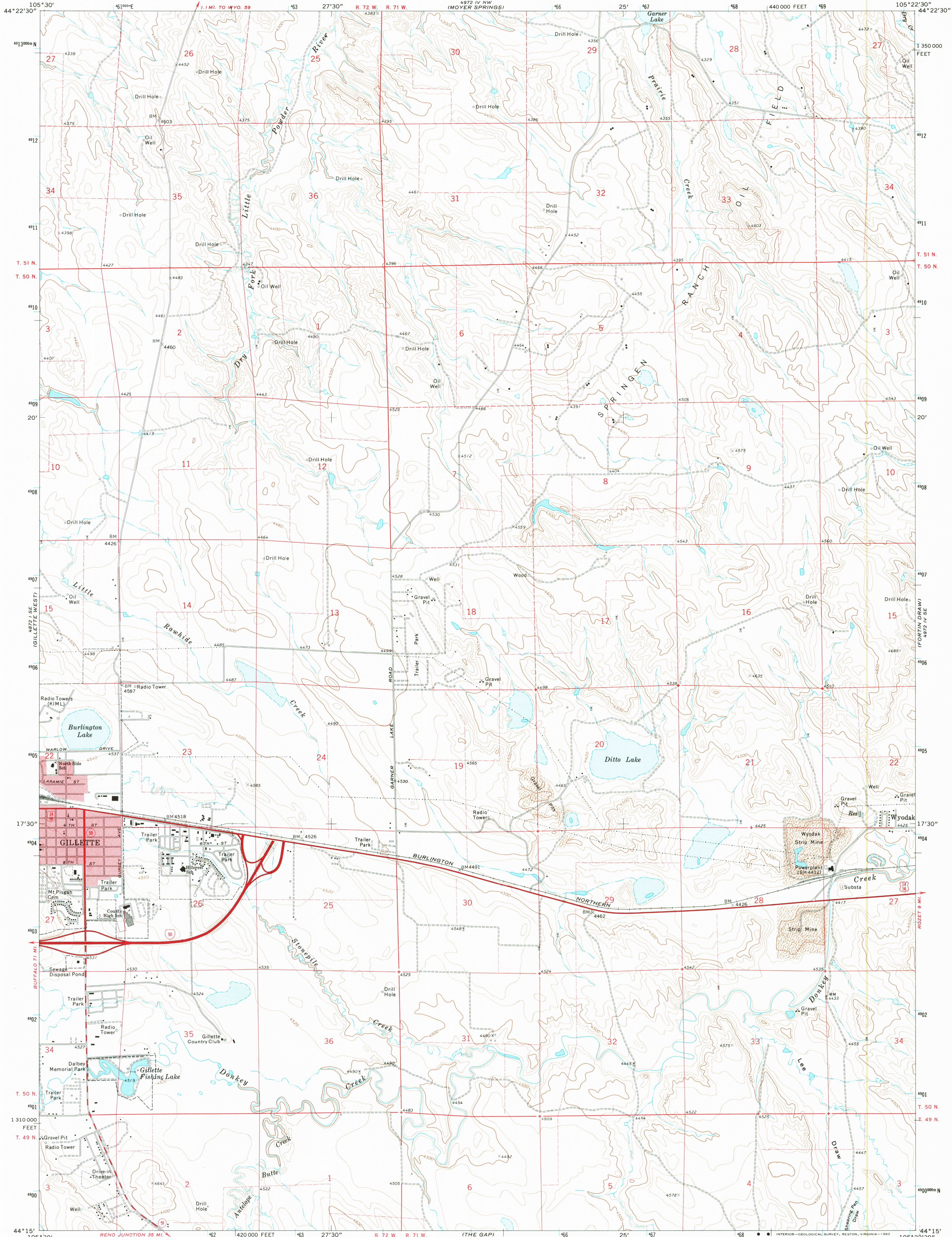

GILLETTE EAST QUADRANGLE
WYOMING—CAMPBELL CO.
7.5 MINUTE SERIES (TOPOGRAPHIC)



Mapped, edited, and published by the Geological Survey
Control by USGS and USC&GS

Topography by photogrammetric methods from aerial
photographs taken 1970. Field checked 1971

Projection and 10,000-foot grid ticks: Wyoming
coordinate system, east zone (transverse Mercator)
1000-meter Universal Transverse Mercator grid ticks,
zone 13, shown in blue. 1927 North American datum

Red tint indicates areas in which only landmark features are shown

Fine red dashed lines indicate selected fence lines

To place on the predicted North American Datum 1983
move the projection lines 7 meters north and
46 meters east as shown by dashed corner ticks

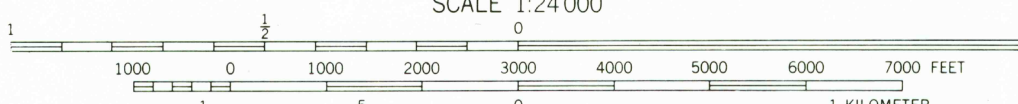
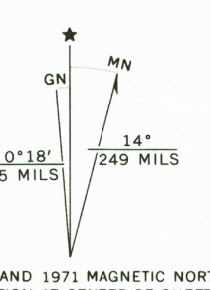

CONTOUR INTERVAL 20 FEET
NATIONAL GEODETIC VERTICAL DATUM OF 1929

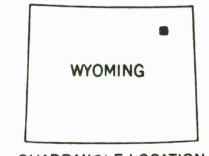

ROAD CLASSIFICATION
Primary highway, hard surface
Secondary highway, hard surface
Unimproved road
Interstate Route
U. S. Route
State Route

USGS
Historical File
Topographic Division

GILLETTE EAST, WYO.
N4415—W10522.5/7.5
1971

DMA 4972 IV SW—SERIES V874

MAY - 1 1980

RETURN TO:
USGS AND HISTORICAL MAP ARCHIVES