

UNITED STATES
DEPARTMENT OF THE INTERIOR
GEOLOGICAL SURVEY

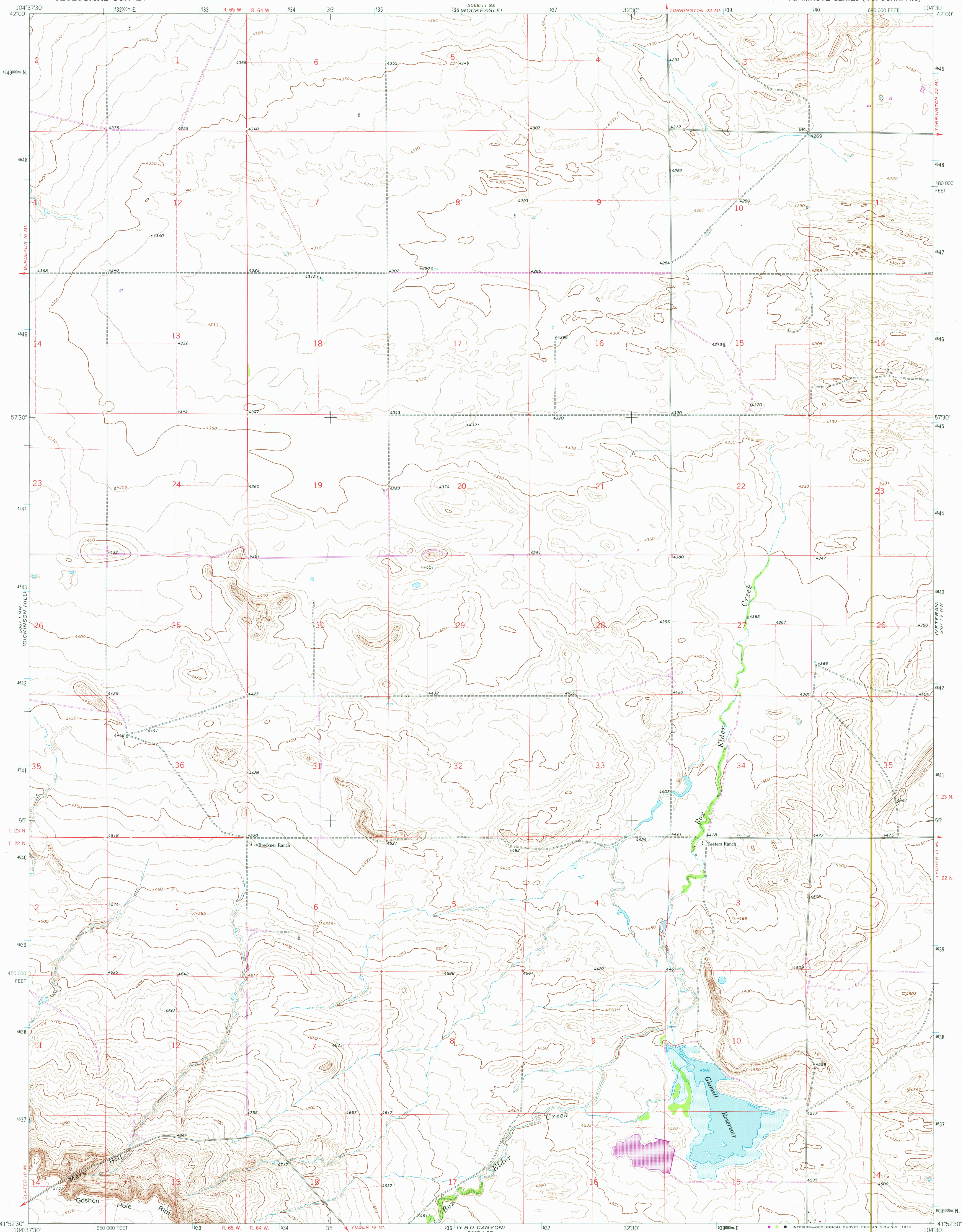

GLOMILL RESERVOIR QUADRANGLE
WYOMING-GOSHEN CO.
7.5 MINUTE SERIES (TOPOGRAPHIC)



Mapped, edited, and published by the Geological Survey
Control by USGS and USAC&S

Topography by photogrammetric methods from aerial
photographs taken 1958. Field checked 1963

Polyconic projection. 1927 North American datum
10,000-foot grid based on Wyoming coordinate system, east zone
1000-meter Universal Transverse Mercator grid ticks,
zone 13, shown in blue

Fine red dashed lines indicate selected fence lines
Areas covered by dashed light-blue pattern are subject
to controlled inundation

Revisions shown in purple and woodland compiled from
aerial photographs taken 1976 and other source data
This information not field checked. Map edited 1979

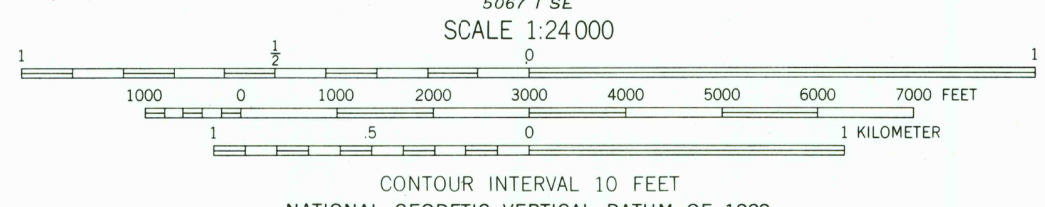
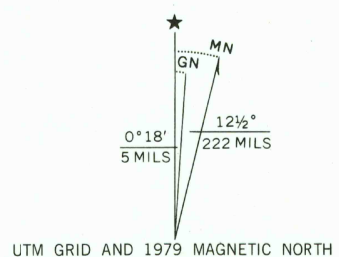

THIS MAP COMPLIES WITH NATIONAL MAP ACCURACY STANDARDS
FOR SALE BY U. S. GEOLOGICAL SURVEY, DENVER, COLORADO 80225, OR RESTON, VIRGINIA 22092
A FOLDER DESCRIBING TOPOGRAPHIC MAPS AND SYMBOLS IS AVAILABLE ON REQUEST

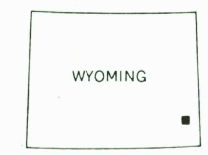

ROAD CLASSIFICATION
Light-duty ———— Unimproved dirt - - - - -

USGS
Historical File
Topographic Division

GLOMILL RESERVOIR, WYO.
N4152.5-W10430/7.5

1963
PHOTO REVISSED 1979
AMS 5067 1 NE-SERIES V874

RETURN TO:
USGS AND HISTORICAL MAP ARCHIVES

FEB - 8 1980

2392