

UNITED STATES  
DEPARTMENT OF THE INTERIOR  
GEOLOGICAL SURVEY

Maped, edited, and published by the Geological Survey  
as part of the Department of the Interior program  
for the development of the Missouri River Basin  
Control by USGS, NOS/NOAA and Wyoming Geodetic Survey

Topography by photogrammetric methods from aerial  
photographs taken 1961. Field checked 1962

Polyconic projection. 1927 North American datum  
10,000-foot grid based on Wyoming coordinate system, east zone  
1000 meter Universal Transverse Mercator grid ticks,  
zone 13, shown in blue

Fine red dashed lines indicate selected fence and field lines  
Area covered by dashed light-blue pattern is subject  
to controlled inundation

Revisions shown in purple compiled from aerial photographs taken  
1976. Map edited 1978. This information not field checked

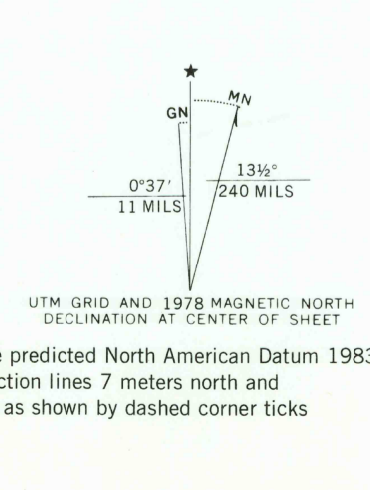

SCALE 1:24,000

1 1000 0 1000 2000 3000 4000 5000 6000 7000 FEET

1 0.5 0 0.5 1 KILOMETER

CONTOUR INTERVAL 20 FEET  
DOTTED LINES REPRESENT 10-FOOT CONTOURS  
NATIONAL GEODETIC VERTICAL DATUM OF 1929

THIS MAP COMPLIES WITH NATIONAL MAP ACCURACY STANDARDS  
FOR SALE BY U. S. GEOLOGICAL SURVEY, DENVER, COLORADO 80225, OR RESTON, VIRGINIA 22092  
A FOLDER DESCRIBING TOPOGRAPHIC MAPS AND SYMBOLS IS AVAILABLE ON REQUEST

ROAD CLASSIFICATION

Medium-duty ——— Light-duty ———  
Unimproved dirt ———  
State Route ○

WYOMING

QUADRANGLE LOCATION

There may be private inholdings within the boundaries of  
the National or State reservations shown on this map

MILLBROOK, WYO.  
N41°15' - W105°52' 5  
1962  
PHOTOREVISED 1978  
DMA 4866 IV SW - SERIES V874

USGS AND HISTORICAL MAP ARCHIVES

DEC 15 1981

1600