

658 III NE
(CRISTAL NE)

UNITED STATES
DEPARTMENT OF THE INTERIOR
GEOLOGICAL SURVEY

STATE OF NORTH DAKOTA
WATER COMMISSION

ST. THOMAS QUADRANGLE
NORTH DAKOTA
7.5 MINUTE SERIES (TOPOGRAPHIC)
SW 1/4 GLASSTON 15' QUADRANGLE

658 III NE
(GLASSTON NE)

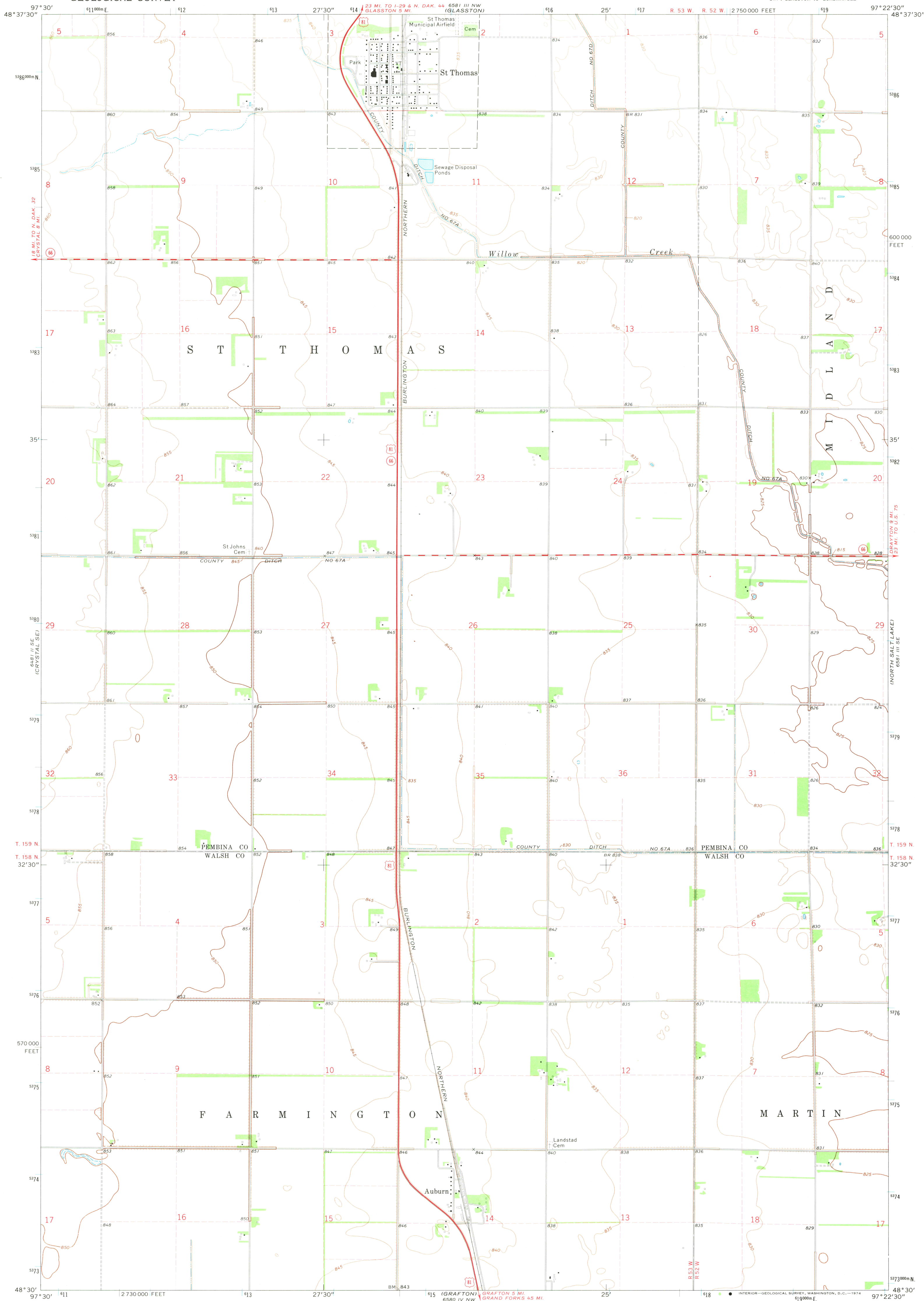

Maped, edited, and published by the Geological Survey in cooperation with the North Dakota Water Commission Control by USGS and USC&GS
Topography by photogrammetric methods from aerial photographs taken 1972. Field checked 1972
Projection and 10,000-foot grid ticks: North Dakota coordinate system, north zone (Lambert conformal conic)
1000-meter Universal Transverse Mercator grid ticks, zone 14, shown in blue. 1927 North American datum
Fine red dashed lines indicate selected fence and field lines where generally visible on aerial photographs
This information is unchecked

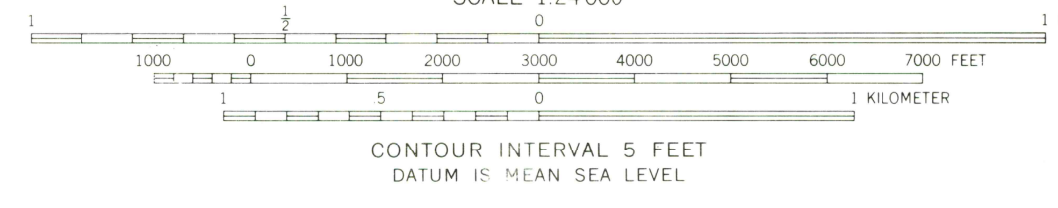
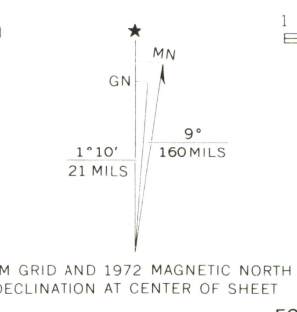

ROAD CLASSIFICATION
Primary highway, hard surface
Secondary highway, hard surface
Light-duty road, hard or improved surface
Unimproved road
Interstate Route
U. S. Route
State Route

ST. THOMAS, N. DAK.
SW 1/4 GLASSTON 15' QUADRANGLE
N4830—W9722.5/7.5

1972

AMS 6581 III SW—SERIES V871

THIS MAP COMPLIES WITH NATIONAL MAP ACCURACY STANDARDS
FOR SALE BY U. S. GEOLOGICAL SURVEY, DENVER, COLORADO 80225, OR WASHINGTON, D. C. 20242
AND BY THE STATE WATER COMMISSION, BISMARCK, NORTH DAKOTA 58501
A FOLDER DESCRIBING TOPOGRAPHIC MAPS AND SYMBOLS IS AVAILABLE ON REQUEST