

UNITED STATES
DEPARTMENT OF THE INTERIOR
GEOLOGICAL SURVEY

STATE OF KANSAS

BIG BOW NW QUADRANGLE
KANSAS
7.5 MINUTE SERIES (TOPOGRAPHIC)

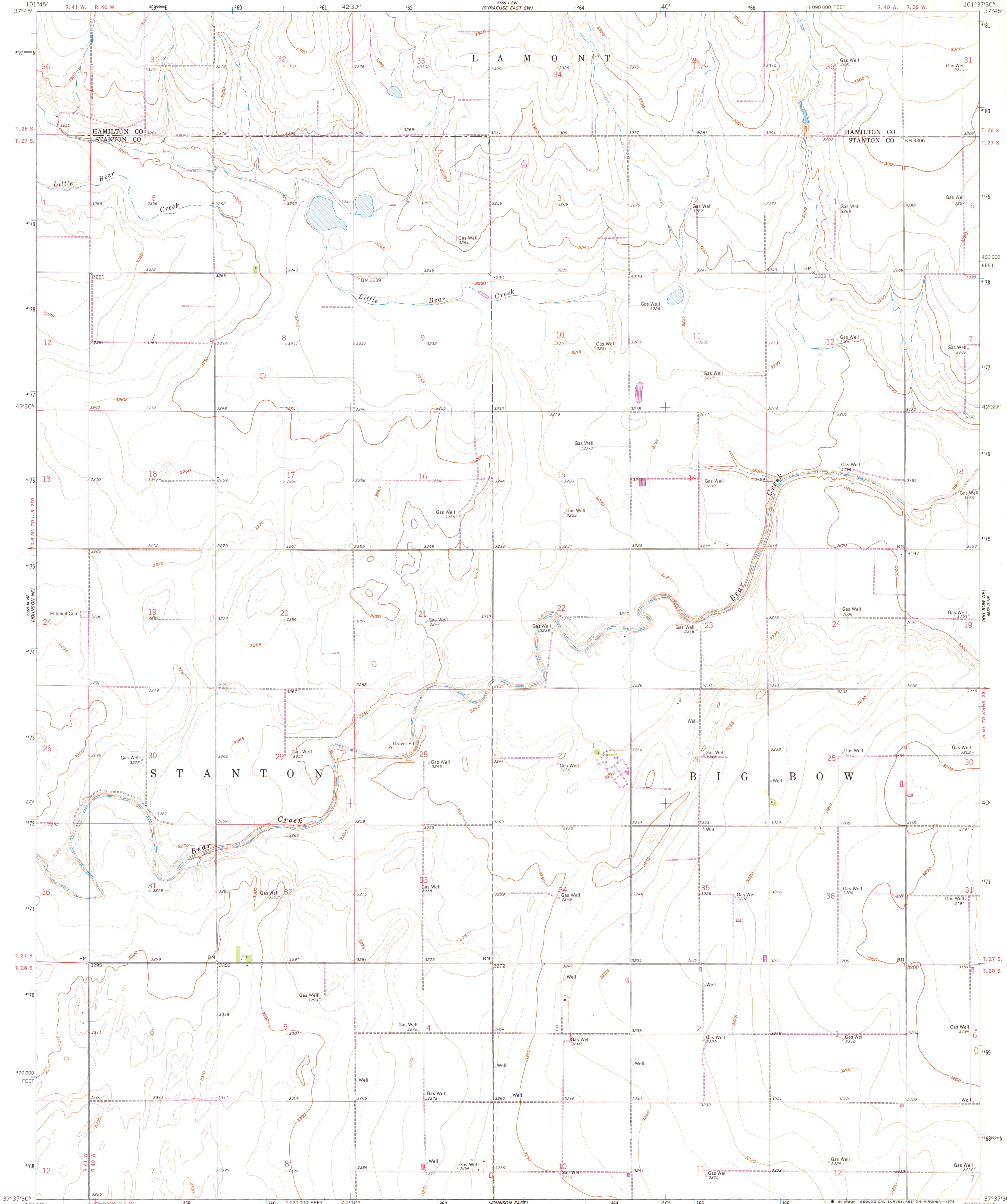

Mapped, edited, and published by the Geological Survey
in cooperation with State of Kansas agencies

Control by USGS and USC&GS

Topography from aerial photographs by photogrammetric methods
and by planetable surveys 1959. Aerial photographs taken 1958

Polyconic projection. 1927 North American datum
10,000-foot grid based on Kansas coordinate system, south zone
1000-meter Universal Transverse Mercator grid ticks,
zone 14, shown in blue

Revisions shown in purple compiled from aerial photographs taken
1977. Map edited 1978. This information not field checked

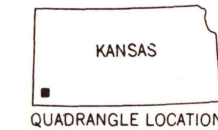
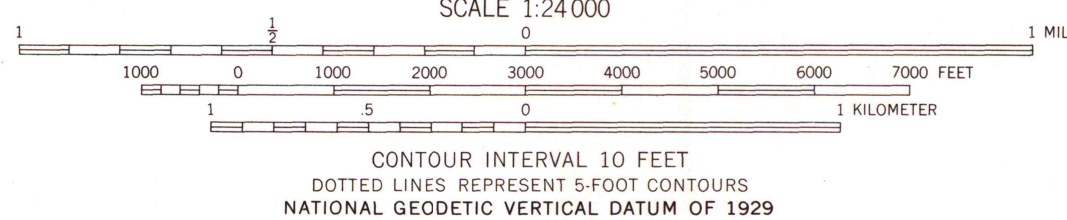
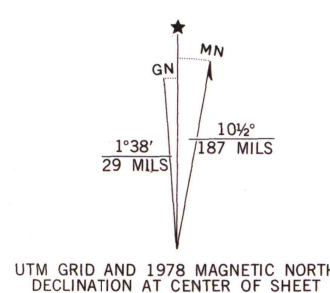

MAP AND AIR PHOTO
LIBRARY

MAR 03 1979

University of Wisconsin
Madison

BIG BOW NW, KANS.
N3737.5-W10137.5/7.5

1959
PHOTOREVISED 1978
AMS 5659 II NW-SERIES 9878