

UNITED STATES
DEPARTMENT OF THE INTERIOR
GEOLOGICAL SURVEY

ZIMMERDALE QUADRANGLE
KANSAS-HARVEY CO.
7.5 MINUTE SERIES (TOPOGRAPHIC)

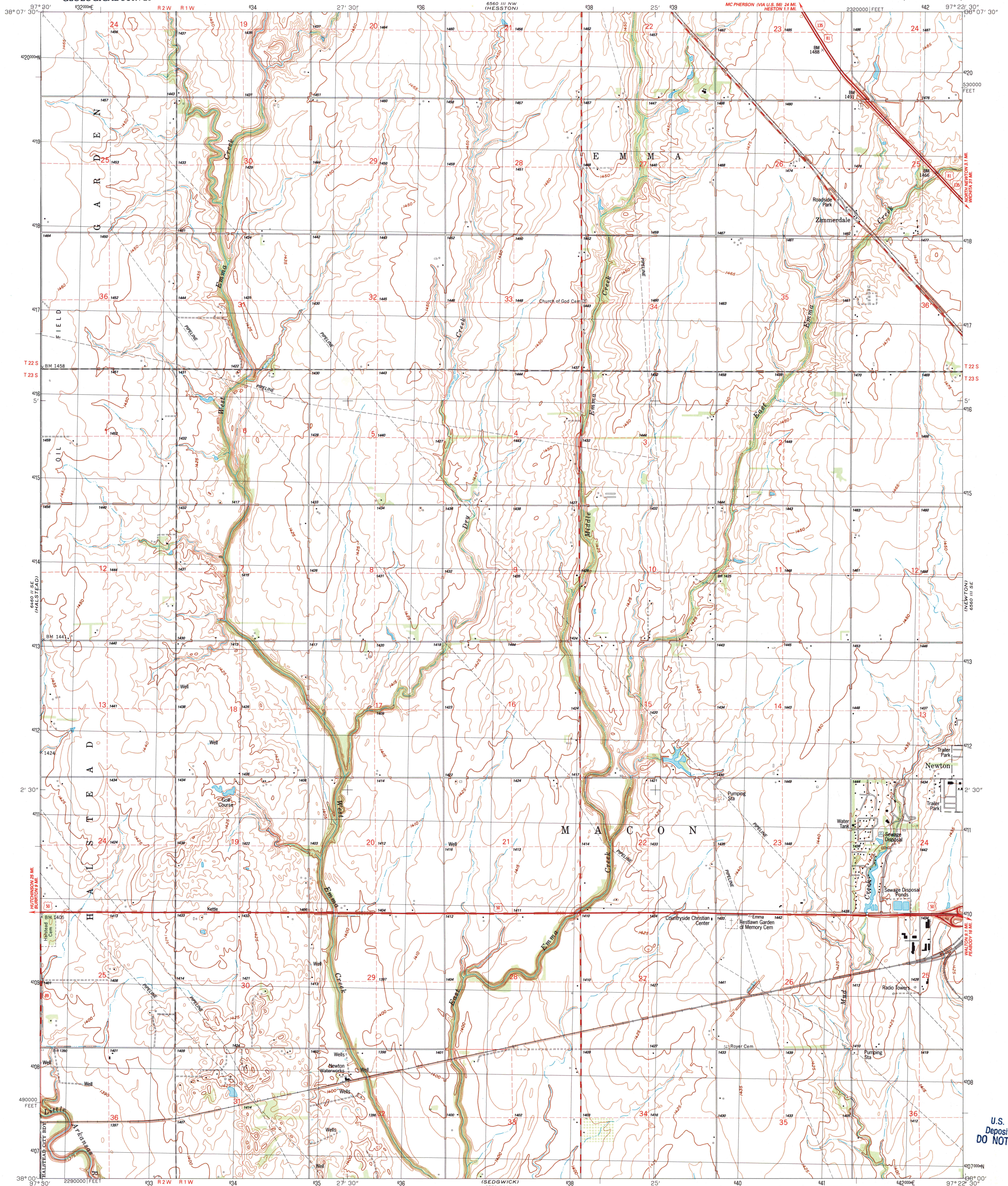

Produced by the United States Geological Survey
in cooperation with State of Kansas agencies

Control by USGS and NOS/NOAA

Topography by photogrammetric methods from aerial photographs
taken 1957. Topography by plane-table surveys 1959. Revised from
aerial photographs taken 1986. Field checked 1988. Map edited 1989

Projection and 10,000-foot grid ticks: Kansas coordinate
system, south zone (Lambert conformal conic)

1000-meter Universal Transverse Mercator grid, zone 14
1927 North American Datum

To place on the predicted North American Datum 1983,
move the projection lines 1 meter north and
28 meters east as shown by dashed corner ticks

Red tint indicates area in which only landmark buildings are shown
Fine red dashed lines indicate selected fence and field lines where
generally visible on aerial photographs. This information is unchecked

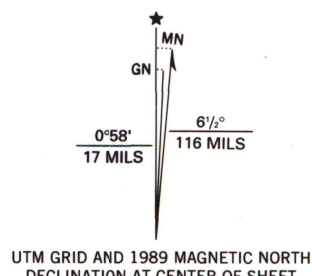

SCALE 1:24 000
1 0000 0 1000 2000 3000 4000 5000 6000 7000 FEET
1 0 1 KILOMETER
CONTOUR INTERVAL 5 FEET
NATIONAL GEODETIC VERTICAL DATUM OF 1929

THIS MAP COMPLIES WITH NATIONAL MAP ACCURACY STANDARDS
FOR SALE BY U. S. GEOLOGICAL SURVEY, DENVER, COLORADO 80225, OR RESTON, VIRGINIA 22092
AND KANSAS GEOLOGICAL SURVEY, LAWRENCE, KANSAS 66044
A FOLDER DESCRIBING TOPOGRAPHIC MAPS AND SYMBOLS IS AVAILABLE ON REQUEST

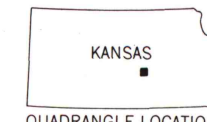

ROAD CLASSIFICATION
Primary highway, hard surface ——— Light-duty road, hard or improved surface ———
Secondary highway, hard surface ——— Unimproved road ———
Interstate Route ——— U. S. Route ——— State Route ———

ZIMMERDALE, KANS.
38097-A4-TF-024
1989

DMA 6560 III SW-SERIES V878

U.S. Regional
Depository Copy
DO NOT DISCARD

A.H. ROBINSON
MAP LIBRARY

AUG 10 1990

University of Wisconsin
Madison