

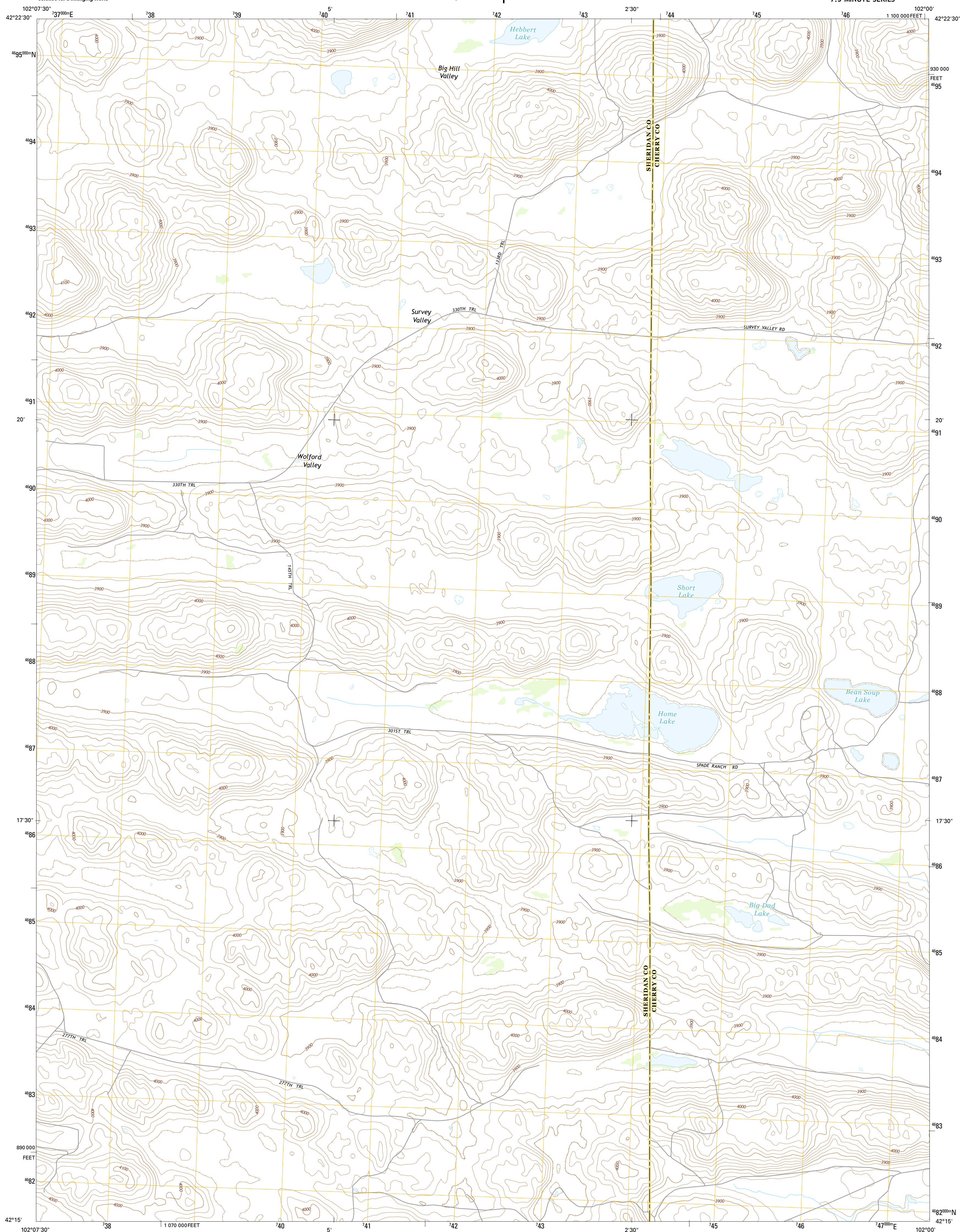

U.S. DEPARTMENT OF THE INTERIOR  
U.S. GEOLOGICAL SURVEY



WOLFORD VALLEY QUADRANGLE  
NEBRASKA  
7.5-MINUTE SERIES



Produced by the United States Geological Survey  
North American Datum of 1983 (NAD83)  
World Geodetic System of 1984 (WGS84). Projection and  
1 000-meter grid: Universal Transverse Mercator, Zone 13T  
10 000-foot ticks: Nebraska Coordinate System of 1983

This map is not a legal document. Boundaries may be generalized for this map scale. Private lands within government reservations may not be shown. Obtain permission before entering private lands.

Imagery.....	NAIP, June 2012
Roads.....	HERE, ©2013
Names.....	GNIS, 2013
Hydrography.....	National Hydrography Dataset, 2012
Contours.....	National Elevation Dataset, 2002
Boundaries.....	Multiple sources; see metadata file 1972 - 2014

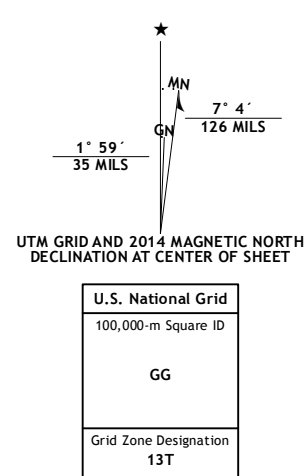

SCALE 1:24 000

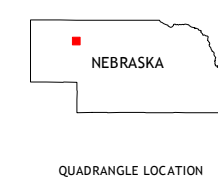
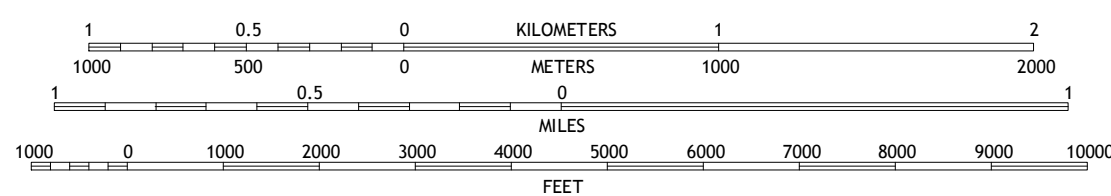

QUADRANGLE LOCATION

1	2	3	1 Dolly Warden Lake
			2 Billys Lake
4		5	3 Turpin Lake West
			4 Argo Hill
6	7	8	5 Card Lake
			6 Arnold Lake
			7 Lowe Valley
			8 Camp Valley

ADJOINING SQUARES

ADJOINING QUADRANGLES

ROAD CLASSIFICATION

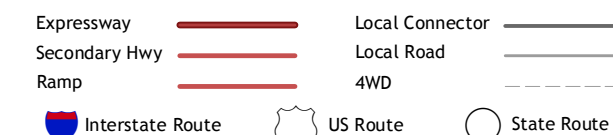

 US Route       State Route

WOLFORD VALLEY, NE  
2014

