

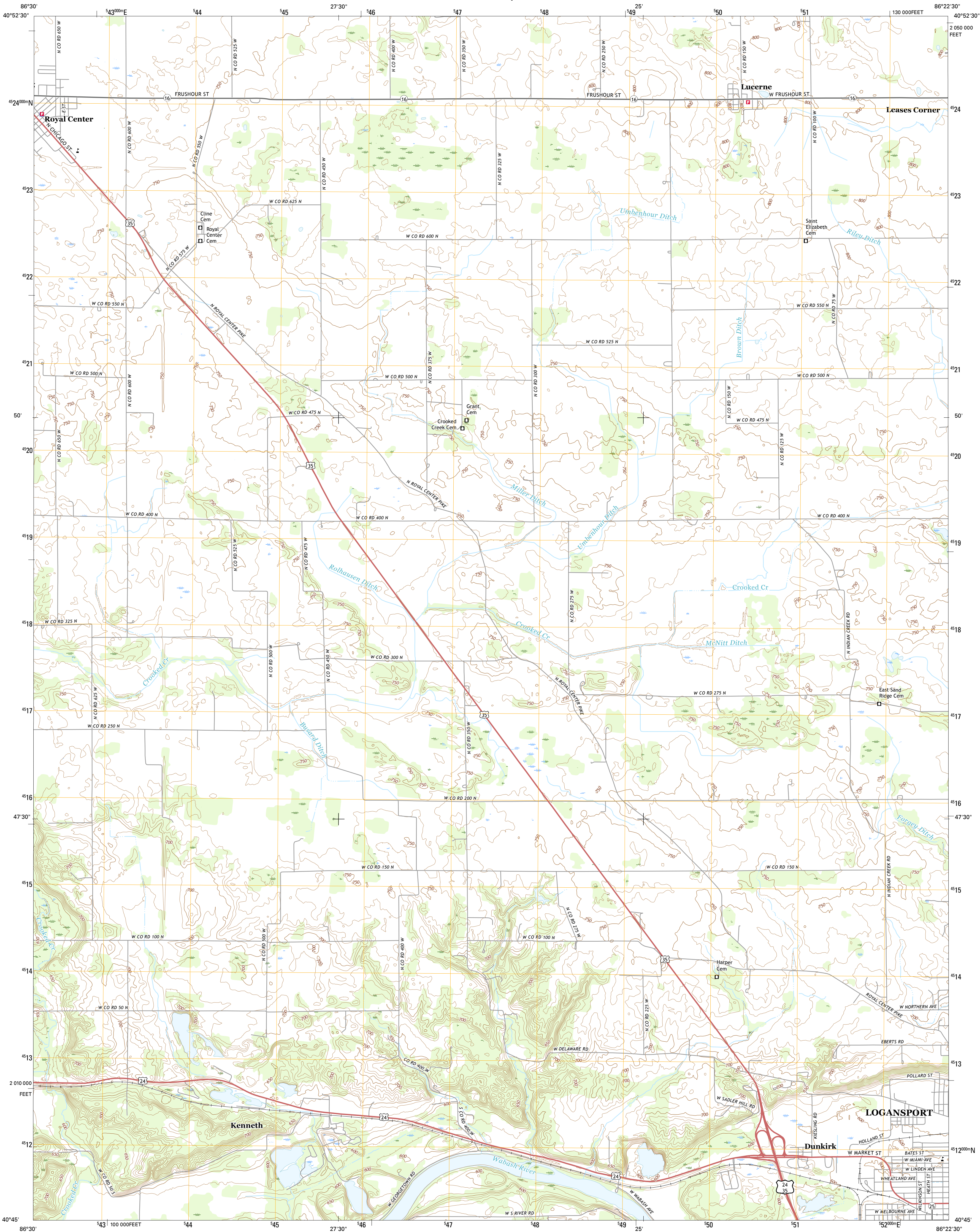

U.S. DEPARTMENT OF THE INTERIOR  
U.S. GEOLOGICAL SURVEY



LUCERNE QUADRANGLE  
INDIANA-CASS CO.  
7.5-MINUTE SERIES



Produced by the United States Geological Survey  
North American Datum of 1983 (NAD83)  
Roads..... U.S. Census Bureau, 2015 - 2016  
Names..... GNIS, 2016  
Hydrography..... National Hydrography Dataset, 2014  
Contours..... National Elevation Dataset, 2014  
Boundaries..... Multiple sources; see metadata file 1972 - 2016  
Public Land Survey System..... BLM, 2015  
Wetlands..... FWS National Wetlands Inventory 1977 - 2014

UTM GRID AND 2015 MAGNETIC NORTH DECLINATION AT CENTER OF SHEET

U.S. National Grid
100,000-m Square ID
EL
Grid Zone Designation
14T

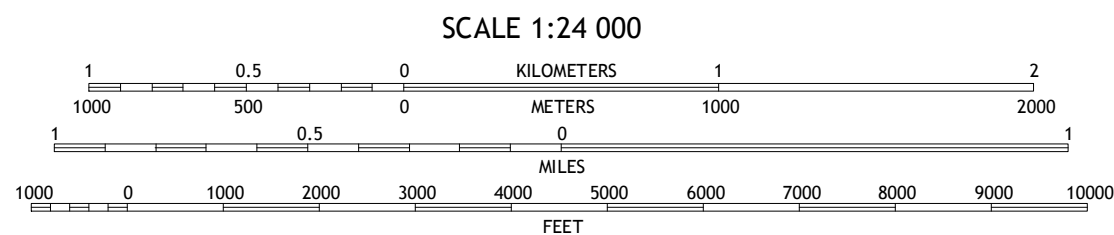

CONTOUR INTERVAL 10 FEET  
NORTH AMERICAN VERTICAL DATUM OF 1988

This map was produced to conform with the  
National Geospatial Program US Topo Product Standard, 2011.  
A metadata file associated with this product is draft version 0.6.19



1	2	3
4	5	6
7	8	9

ADJOINING QUADRANGLES

ROAD CLASSIFICATION

Expressway	Local Connector
Secondary Hwy	Local Road
Ramp	4WD
Interstate Route	US Route
	State Route

LUCERNE, IN  
2016

