

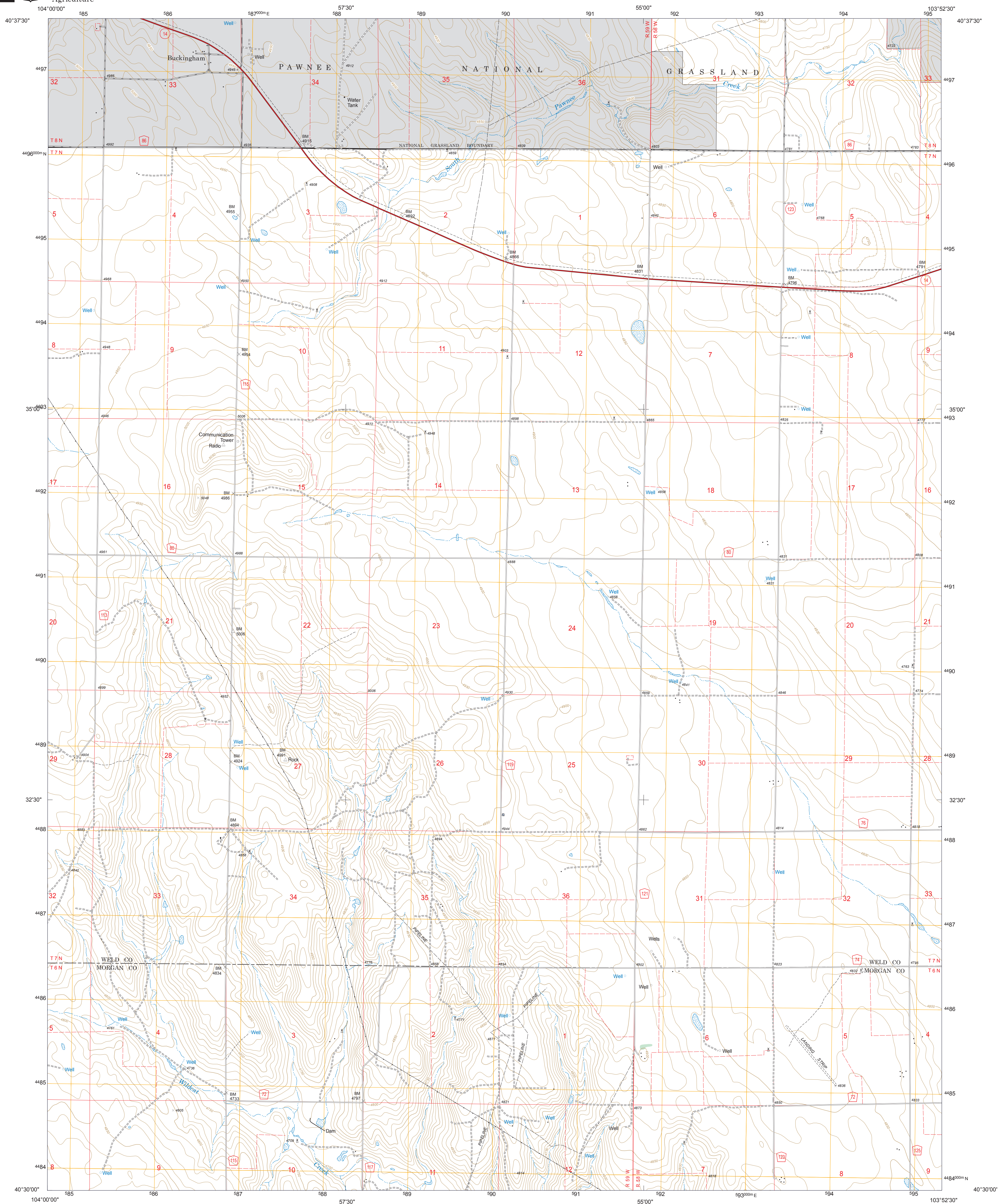

### 7.5-MINUTE SERIES (TOPOGRAPHIC)



Full Revision of Forest Service lands 1998  
 Updates to Transportation 1998  
 Updates to Boundaries 1998

This is not a legal document. Public lands are subject to change and leasing, and may have access restrictions. Not all roads and trails on this map are open to motor vehicle use. Check with appropriate officials and obtain appropriate regulatory maps and information. Obtain permission before entering private lands.

USDA is an equal opportunity provider,  
employer, and lender

The MVUM is a legal enforceable document that identifies the roads, trails, and areas where motor vehicle use is allowed in a Forest Service administrative unit or ranger district. MVUMs are reissued each year. It is the responsibility of motor vehicle users to acquire the current MVUM. MVUMs are available FREE at Forest Service offices and at [www.fs.fed.us/recreation/programs/ohv/ohv\\_maps.shtml](http://www.fs.fed.us/recreation/programs/ohv/ohv_maps.shtml)

Keota	Raymer NW	Raymer NE
Keota SE	Buckingham	Raymer
Clarksburg	Clarksburg	Peace

Interstate.....		Highway.....	
U.S. ....		Road, Unspecified.....	
State.....		Road, Paved.....	
County.....		Road, Gravel.....	
National Forest, suitable for passenger cars.....		Road, Dirt.....	
National Forest, suitable for high clearance vehicles.....		Unimproved.....	
National Forest Trail.....		Road, Closed.....	
		Trail.....	
		Gate: Barrier.....	

check with local Forest Service unit for current travel conditions and restrictions

This product generated and downloaded on 2/14/2023

BUCKINGHAM, CO  
(FSTOPO LEGACY)