

789 IV SE
(GVALEAD)

UNITED STATES
DEPARTMENT OF THE INTERIOR
GEOLOGICAL SURVEY

ALEXANDER QUADRANGLE
IOWA
7.5 MINUTE SERIES (TOPOGRAPHIC)

789 IV NE
(GVALEAD)

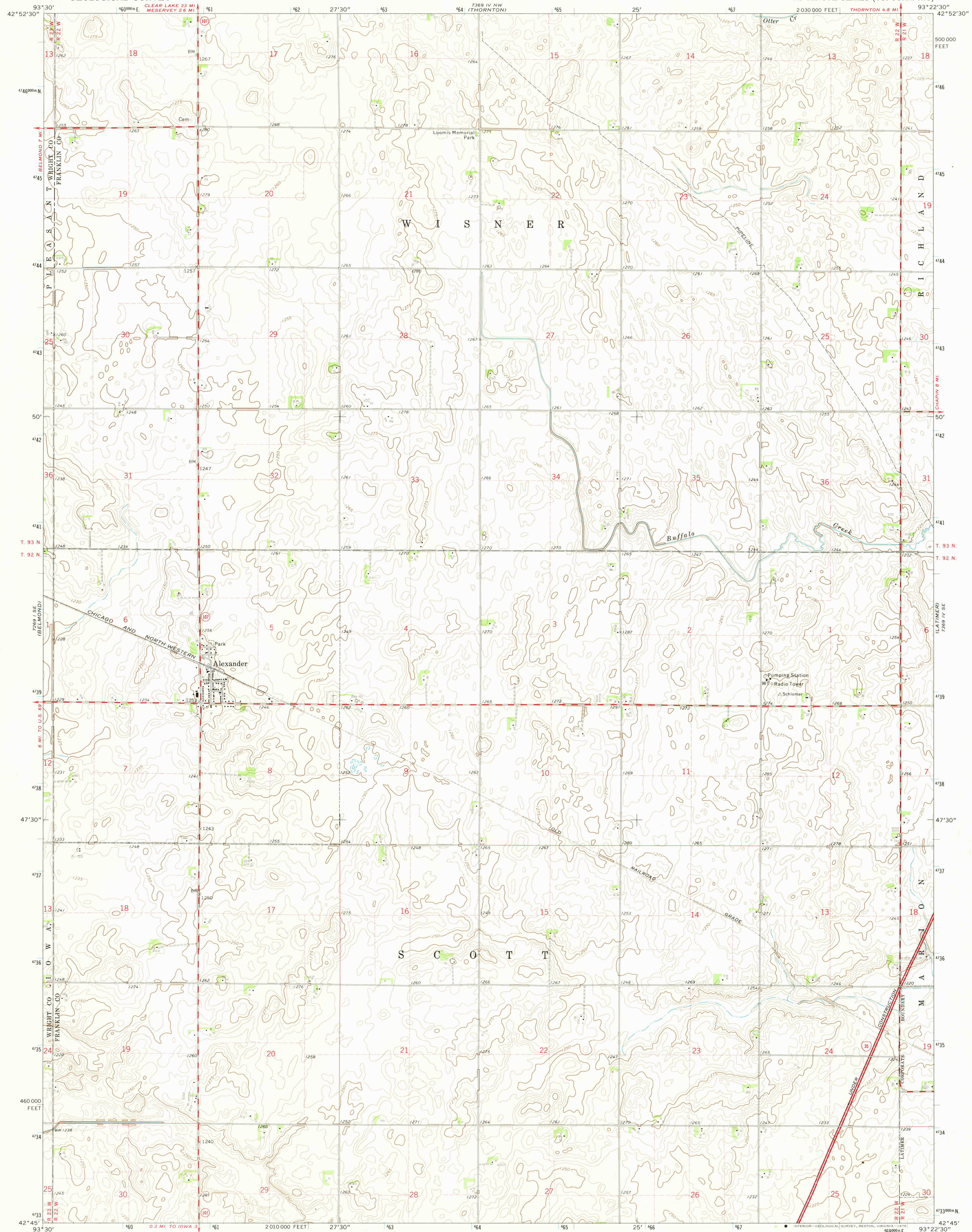

Mapped, edited, and published by the Geological Survey

Control by USGS and USC&GS

Topography by photogrammetric methods from aerial

photographs taken 1972. Field checked 1972

Projection and 10,000-foot grid ticks: Iowa coordinate

system, north zone (Lambert conformal conic)

1000-meter Universal Transverse Mercator grid ticks,

zone 15, shown in blue. 1927 North American datum

Fine red dashed lines indicate selected fence and field lines where

generally visible on aerial photographs. This information is unchecked

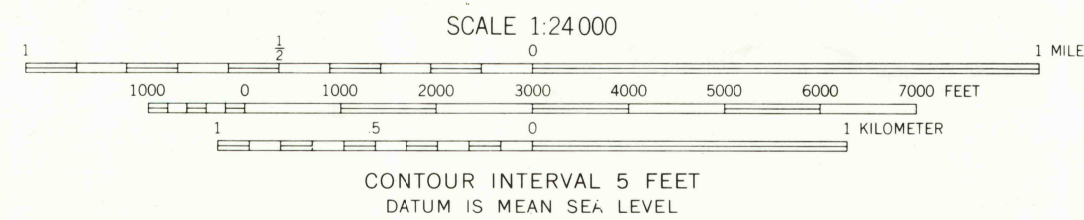
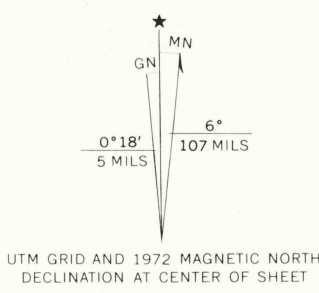

ROAD CLASSIFICATION	
Primary highway, hard surface	Light-duty road, hard or improved surface
Secondary highway, hard surface	Unimproved road
Interstate Route	U.S. Route
	State Route

ALEXANDER, IOWA
N4245-W9322.5/7.5
1972

AMS 7369 IV SW-SERIES V876

THIS MAP COMPLIES WITH NATIONAL MAP ACCURACY STANDARDS
FOR SALE BY U.S. GEOLOGICAL SURVEY, DENVER, COLORADO 80225, OR RESTON, VIRGINIA 22092
AND BY THE IOWA GEOLOGICAL SURVEY, IOWA CITY, IOWA 52240
A FOLDER DESCRIBING TOPOGRAPHIC MAPS AND SYMBOLS IS AVAILABLE ON REQUEST

USGS
Historical File
Topographic Division

MAR 5 1975

2400