

A.M.S. V501
AMS 1 1990

Prepared under the direction of the Chief of Engineers, by the Corps of Engineers, U. S. Army Map Service (AM), Washington, D. C. Compiled in 1948 from United States Quadrangles, 1:62,500, U. S. Geological Survey and Corps of Engineers, 1901-1941; County Highway Maps, 1940; and intelligence data to 1948. Planimetric detail partially revised by photogrammetric methods. Aerial photography 1938-1944. Road and aeronautical data verified by state authorities, 1949. Control by U. S. Geological Survey, U. S. Coast and Geodetic Survey and U. S. Engineers.

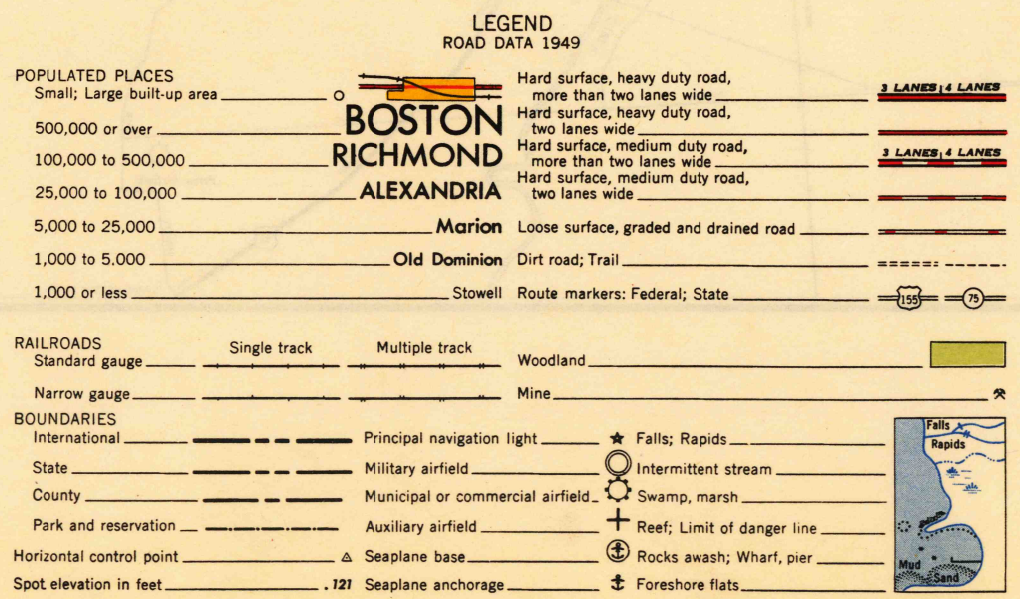

TOWNSHIP OR RANGE LINE
LAND GRANT BOUNDARY

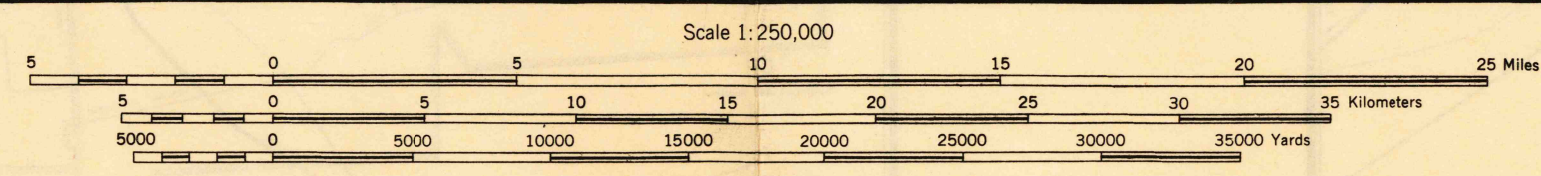
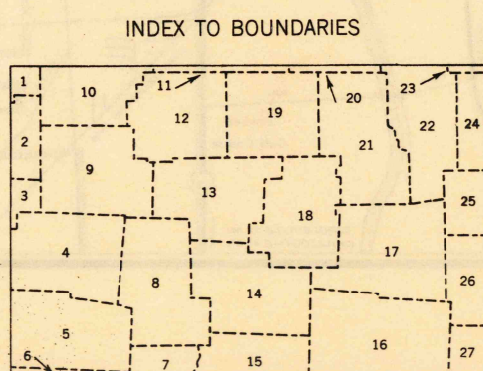

FOR SALE BY U. S. GEOLOGICAL SURVEY, WASHINGTON 25, D. C.

SECTIONIZED TOWNSHIP



LOCATION DIAGRAM FOR NK 17-10

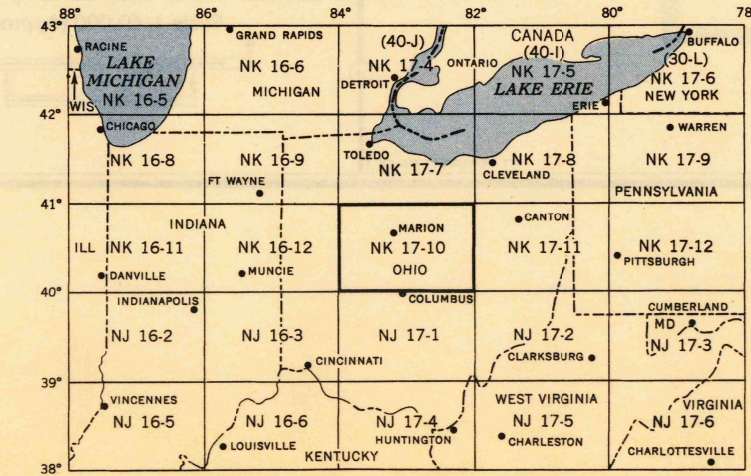

CORPS OF ENGINEERS, U. S. ARMY MAP SERVICE, 5010

8-51

COVERAGE DIAGRAM

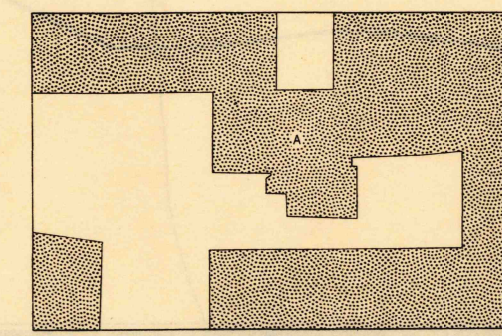

MARION, UNITED STATES
OHIO
N4000-W8200/100x200

U. S. G. S.
FILE COPY
Inspection and Editing

8-24-51
(2000)