

A.M.S. V831
Type F (AMS 1), 1947.

Prepared under the direction of the Chief of Engineers by the Army Map Service (AM), War Department, Washington, D. C. Compiled in 1947 from Pennsylvania, 1:62,500, Corps of Engineers, Harrisburg, 1943. Planimetric detail revised from aerial photography by photo planimetric methods. Aerial photography by Army Map Service, 1946. Horizontal and vertical control by USGS, USCGS, U. S. Engineer Department, and Soil Conservation Service. Planimetry field edited, 1947.

LEGEND	
ROAD DATA 1947	
Hard surface, heavy duty road, more than two lanes wide	Loose surface, graded and drained, or narrow hard surface road
Hard surface, heavy duty road, two lanes wide	Improved dirt road
Hard surface, medium duty road, more than two lanes wide	Unimproved dirt road
Hard surface, medium duty road, two lanes wide	Trail
State route marker	

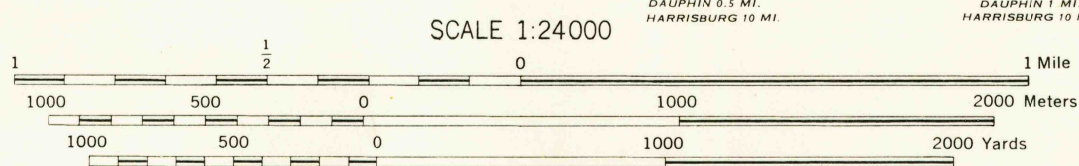

SCALE 1:24,000
CONTOUR INTERVAL 20 FEET
DATUM IS MEAN SEA LEVEL
TRANSVERSE MERCATOR PROJECTION
1927 NORTH AMERICAN DATUM

USGS
Historical File
Topographic Division
U.S.G.S.
FILE COPY
TOPOGRAPHIC DIVISION

INDEX TO BOUNDARIES INDEX TO ADJOINING SHEETS

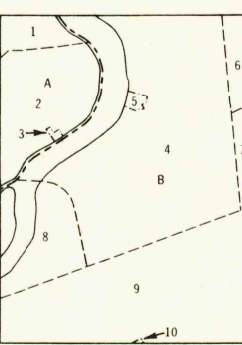

Sheet 5664 IV NW falls within RA 10-10.	AMS V831 1:250,000
1. Perry County	2. Buffalo Township
3. West Township	4. New Buffalo Borough (Incorporated)
5. Dauphin County	6. Halifax Township
7. Jackson Township	8. Wayne Township
9. Middle Paxton Township	10. Dauphin Borough (Incorporated)