

UNITED STATES  
DEPARTMENT OF THE INTERIOR  
GEOLOGICAL SURVEY

CROOK QUADRANGLE  
COLORADO-LOGAN CO.  
7.5 MINUTE SERIES (TOPOGRAPHIC)

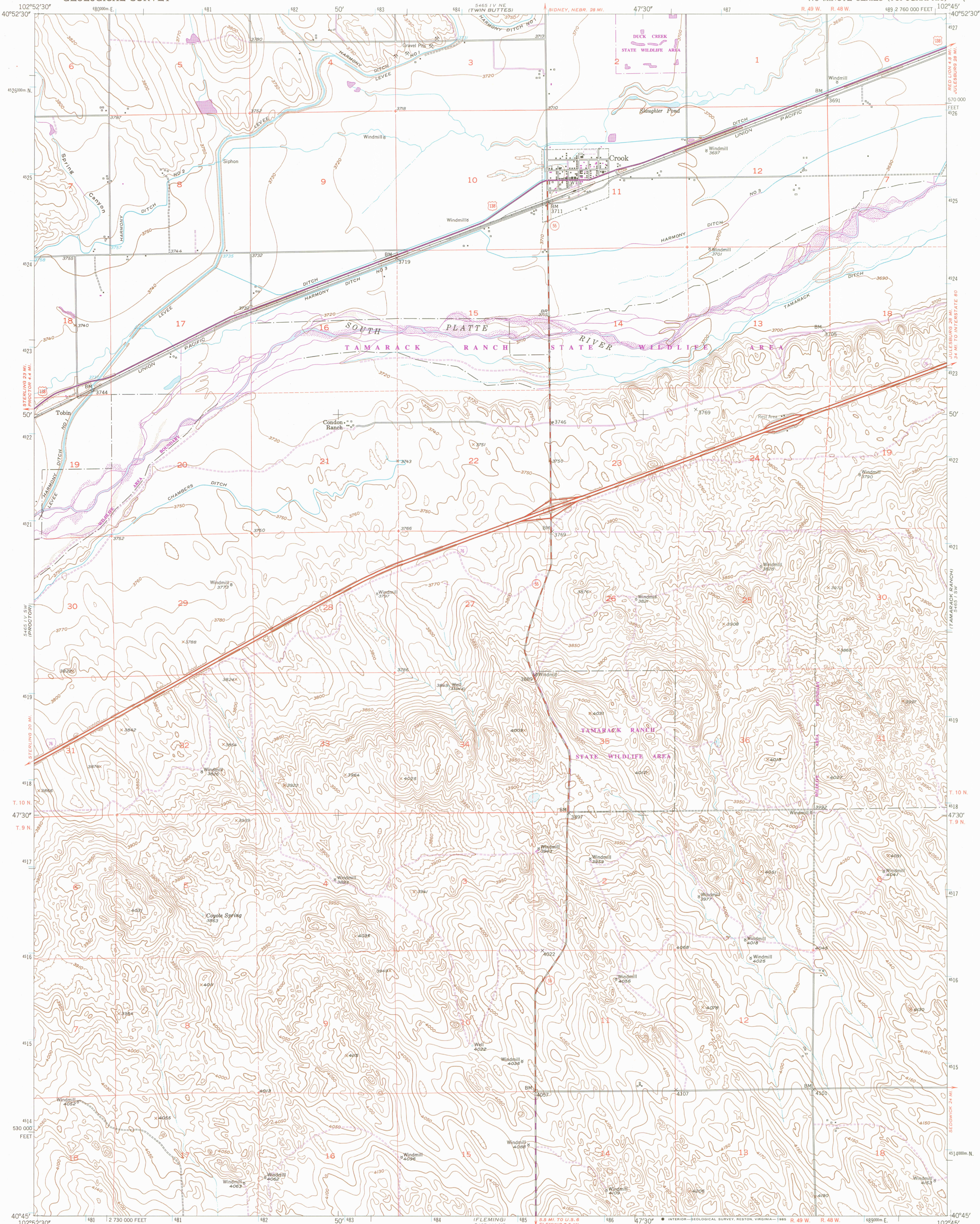

Mapped, edited, and published by the Geological Survey  
as part of the Department of the Interior program  
for the development of the Missouri River Basin

Control by USGS and NOS/NOAA

Culture and drainage in part compiled from aerial photographs  
taken 1949. Topography by plane-table surveys 1953  
Limited revision 1971

Polyconic projection. 1927 North American Datum  
10,000-foot grid based on Colorado coordinate system, north zone  
1,000-meter Universal Transverse Mercator grid ticks,  
zone 13, shown in blue

There may be private inholdings within the boundaries  
of the National or State reservations shown on this map

To place on the predicted North American Datum 1983  
move the projection lines 5 meters north and  
41 meters east as shown by dashed corner ticks

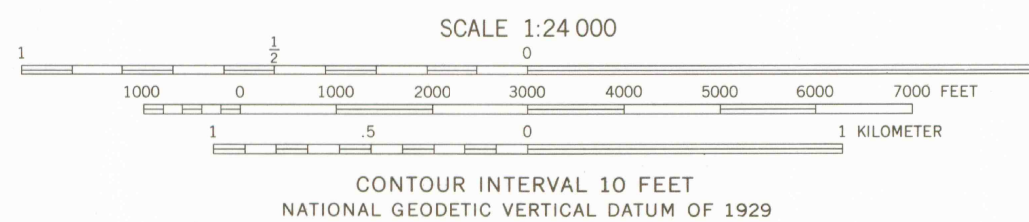

THIS MAP COMPLIES WITH NATIONAL MAP ACCURACY STANDARDS  
FOR SALE BY U. S. GEOLOGICAL SURVEY, DENVER, COLORADO 80225, OR RESTON, VIRGINIA 22092  
A FOLDER DESCRIBING TOPOGRAPHIC MAPS AND SYMBOLS IS AVAILABLE ON REQUEST

ROAD CLASSIFICATION  
Primary highway, hard surface  
Secondary highway, hard surface  
Unimproved road  
Interstate Route  
U. S. Route  
State Route



Revisions shown in purple and woodland  
compiled from aerial photographs taken 1980  
and other source data. This information  
not field checked. Map edited 1984

GEOLOGICAL SURVEY OF WYOMING  
CROOK, COLO.  
40102-G7-TF-024  
1953  
PHOTOREVISED 1984  
DMA 5465 IV SE-SERIES 1987