

UNITED STATES
DEPARTMENT OF THE INTERIOR
GEOLOGICAL SURVEY

MESSEX QUADRANGLE
COLORADO
7.5 MINUTE SERIES (TOPOGRAPHIC)

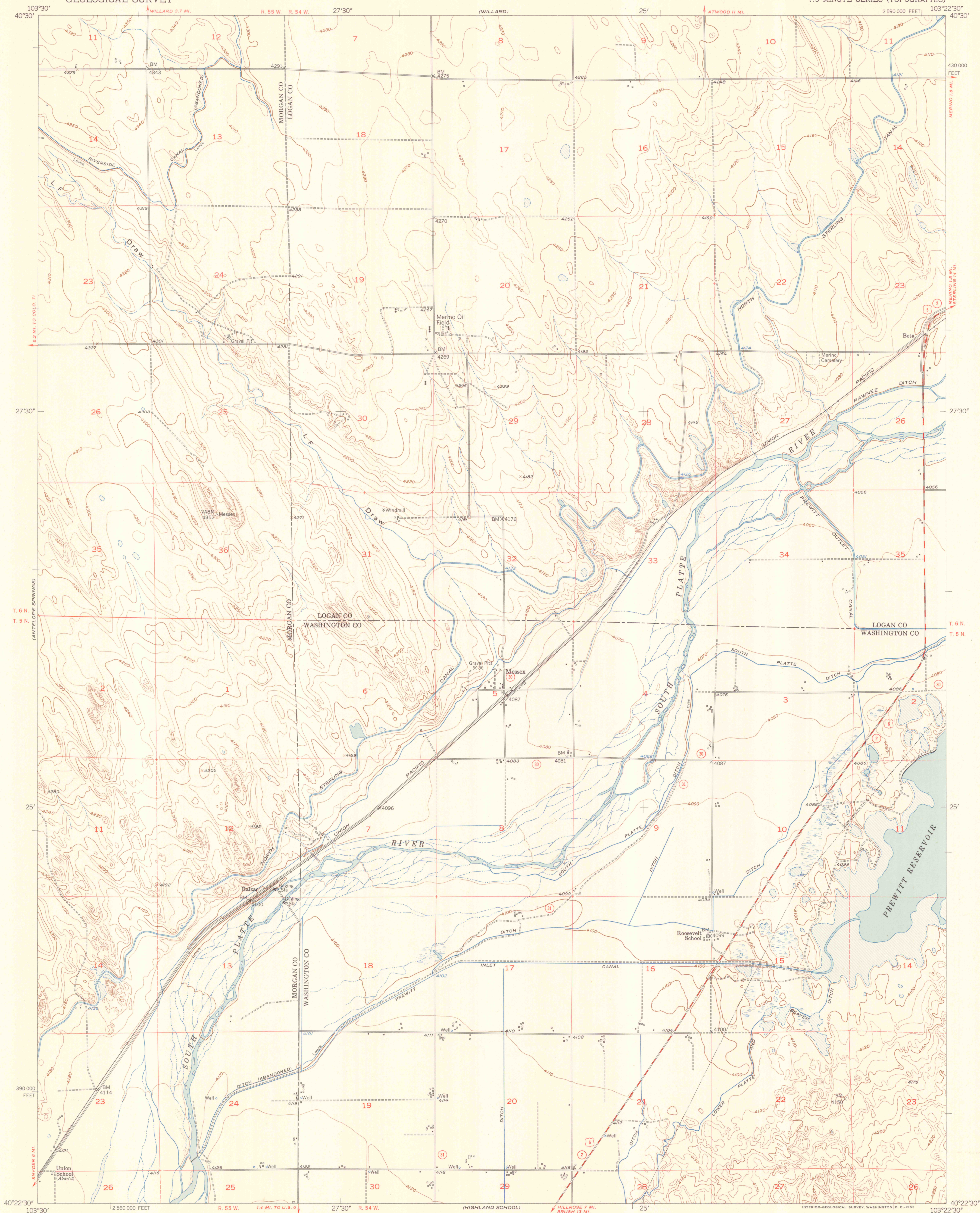

Mapped, edited, and published by the Geological Survey as part of the Department of the Interior program for the development of the Missouri River Basin. Control by USC&GS. Culture and drainage in part compiled from aerial photographs taken June, October, November, 1948 and June, August, 1949. Topography by plane-table methods, 1951. Polyconic projection, 1927 North American datum, 10,000-foot grid based on Colorado coordinate system, north zone. Dashed land lines indicate approximate location.

TRUE NORTH
MAGNETIC NORTH
APPROXIMATE MEAN DECLINATION, 1951

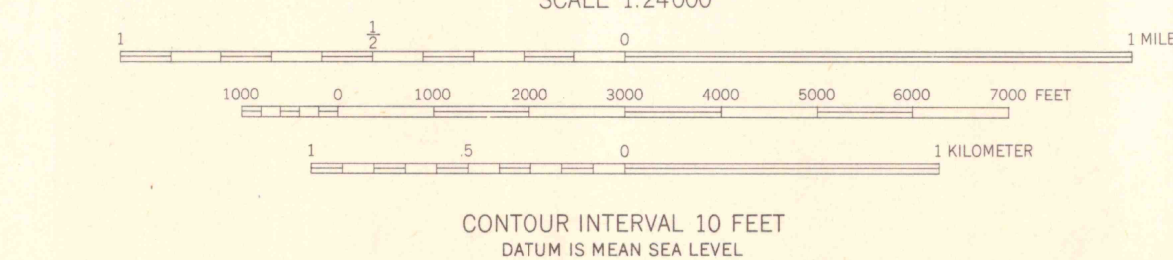

JAN 19 2006
MAP ROOM
ARTHUR LAKES LIBRARY
COLORADO SCHOOL OF MINES

ROAD CLASSIFICATION
Heavy-duty 4 LANE 16 LANE Light-duty
Medium-duty 4 LANE 16 LANE Unimproved dirt
U. S. Route State Route

MESSEX, COLO.
N4022.5-W10322.5/7.5
1951

G 3700
\$24
.G4
MAP ROOM

THIS MAP COMPLIES WITH NATIONAL MAP ACCURACY STANDARDS
FOR SALE BY U. S. GEOLOGICAL SURVEY, FEDERAL CENTER, DENVER, COLORADO OR WASHINGTON 25, D. C.
A FOLDER DESCRIBING TOPOGRAPHIC MAPS AND SYMBOLS IS AVAILABLE ON REQUEST

OFFICE COPY
LIBRARY USE ONLY