

DOCUMENTS DIVISION  
RECEIVED  
JUN 9 - 1954  
SCHOOL OF MINES LIBRARY

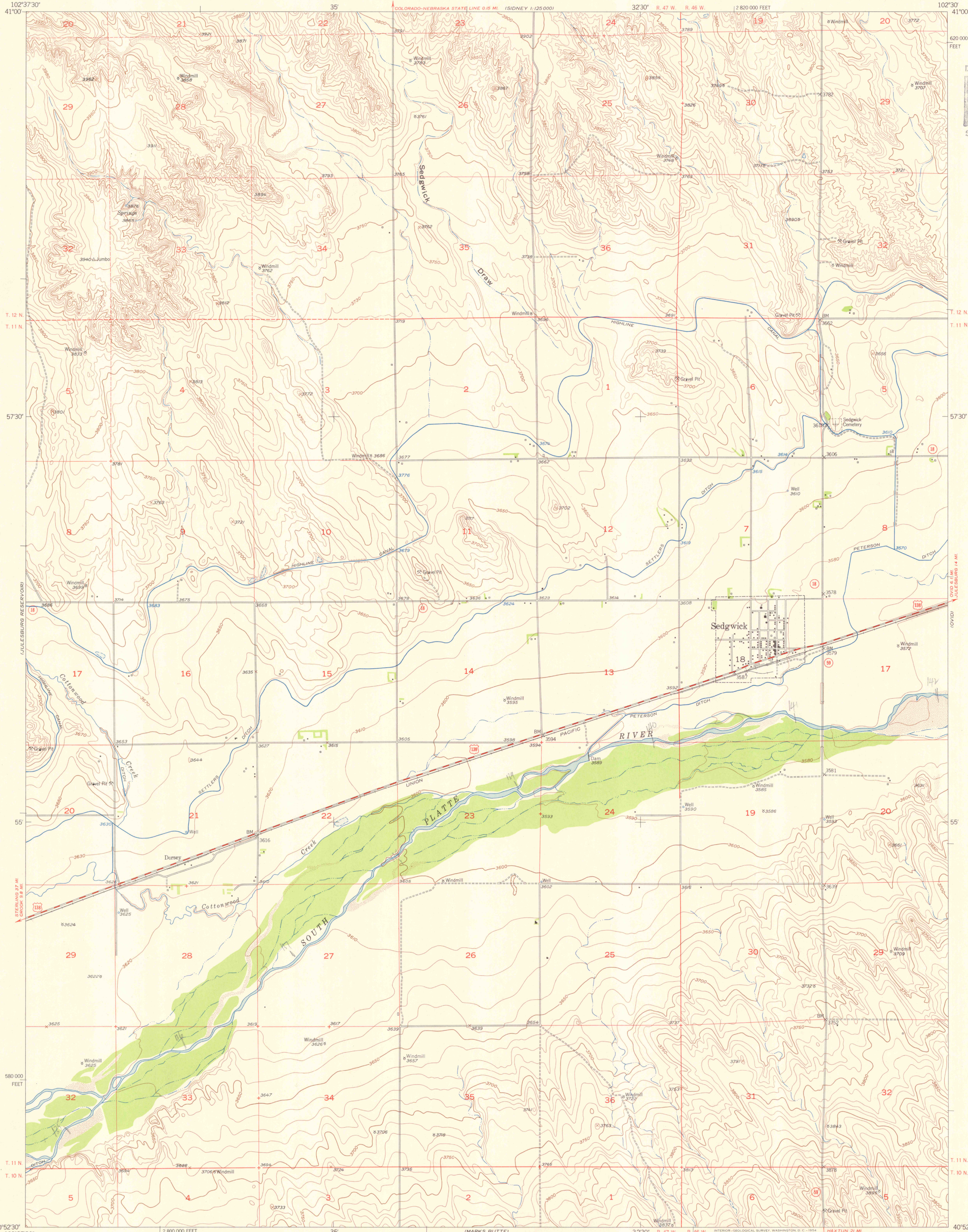

Mapped, edited, and published by the Geological Survey  
as part of the Department of the Interior program  
for the development of the Missouri River Basin  
Control by USGS and USC&GS

Culture and drainage in part compiled from aerial photographs  
taken 1948. Topography by plane-table surveys 1953  
Polyconic projection, 1927 North American datum  
10,000-foot grid based on Colorado coordinate system,  
north zone

Dashed land lines indicate approximate locations

APPROXIMATE MEAN  
DECLINATION, 1953

SCALE 1:24000  
1 0 1000 2000 3000 4000 5000 6000 7000 FEET  
1 0 1 KILOMETER

CONTOUR INTERVAL 10 FEET  
DATUM IS MEAN SEA LEVEL

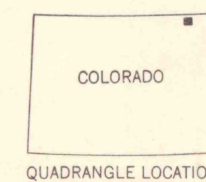

ROAD CLASSIFICATION  
Heavy-duty 4 LANE 16 LANE Light-duty  
Medium-duty 4 LANE 16 LANE Unimproved dirt  
U. S. Route State Route

SEDGWICK, COLO.  
N4052.5-W10230/7.5

1953

LIBRARY USE ONLY

THIS MAP COMPLIES WITH NATIONAL MAP ACCURACY STANDARDS  
FOR SALE BY U. S. GEOLOGICAL SURVEY, FEDERAL CENTER, DENVER, COLORADO OR WASHINGTON 25, D. C.  
A FOLDER DESCRIBING TOPOGRAPHIC MAPS AND SYMBOLS IS AVAILABLE ON REQUEST

I 19.12:5 Sedgwick 953