

UNITED STATES
DEPARTMENT OF THE INTERIOR
GEOLOGICAL SURVEY

PITMAN WEST QUADRANGLE
NEW JERSEY
7.5 MINUTE SERIES (TOPOGRAPHIC)

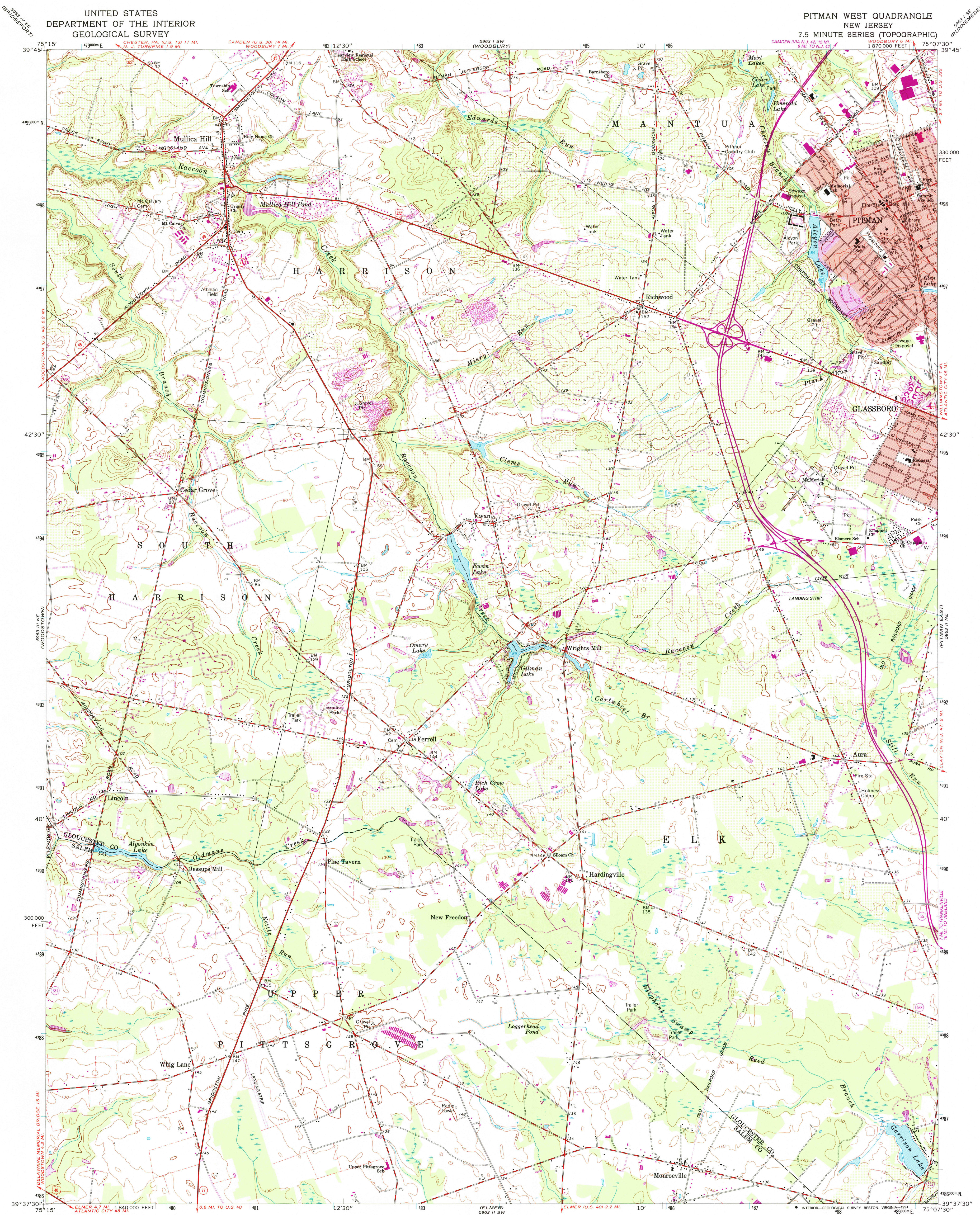

Produced by the United States Geological Survey
Control by USGS, NOS/NOAA, and New Jersey Geodetic Survey
Planimetry by photogrammetric methods from aerial photographs
taken 1951. Topography by planimetric surveys 1953. Revised from
aerial photographs taken 1965. Field checked 1967
Projection and 10,000-foot grid ticks: New Jersey coordinate
system, transverse Mercator
1000-meter Universal Transverse Mercator grid ticks, zone 18, shown in blue
1927 North American Datum (NAD 27)
North American Datum of 1983 (NAD 83) is shown by dashed corner ticks
The values of the shift between NAD 27 and NAD 83 for 7.5-minute
intersections are given in USGS Bulletin 1875
Red tint indicates areas in which only landmark buildings are shown
Fine red dashed lines indicate selected fence and field lines where
generally visible on aerial photographs. This information is unchecked

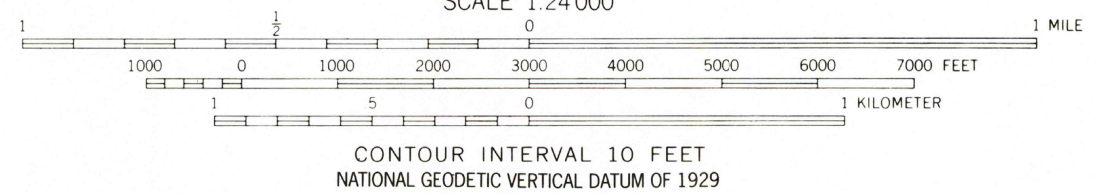
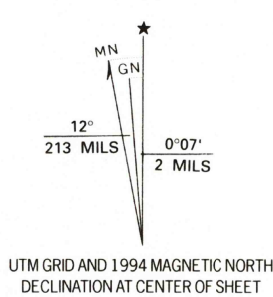

THIS MAP COMPLIES WITH NATIONAL MAP ACCURACY STANDARDS
FOR SALE BY U.S. GEOLOGICAL SURVEY
DENVER, COLORADO 80225, OR RESTON, VIRGINIA 22092
A FOLDER DESCRIBING TOPOGRAPHIC MAPS AND SYMBOLS IS AVAILABLE ON REQUEST

Revisions shown in purple compiled from aerial
photographs taken 1990 and other sources. This
information not field checked. Map edited 1994
Information shown in purple may not meet USGS content
standards and may conflict with previously mapped contours
Purple tint indicates extension of urban areas

ROAD CLASSIFICATION	
Primary highway, hard surface	Light-duty road, hard or improved surface
Secondary highway, hard surface	Unimproved road
Interstate Route	U. S. Route
	State Route



PITMAN WEST, N.J.
39075-F2-1F-024
1967
REVISED 1994
DMA 5963 II NW-SERIES V822

