

UNITED STATES
DEPARTMENT OF THE INTERIOR
GEOLOGICAL SURVEY

COOLEY LAKE QUADRANGLE
NEW MEXICO
7.5 MINUTE SERIES (TOPOGRAPHIC)

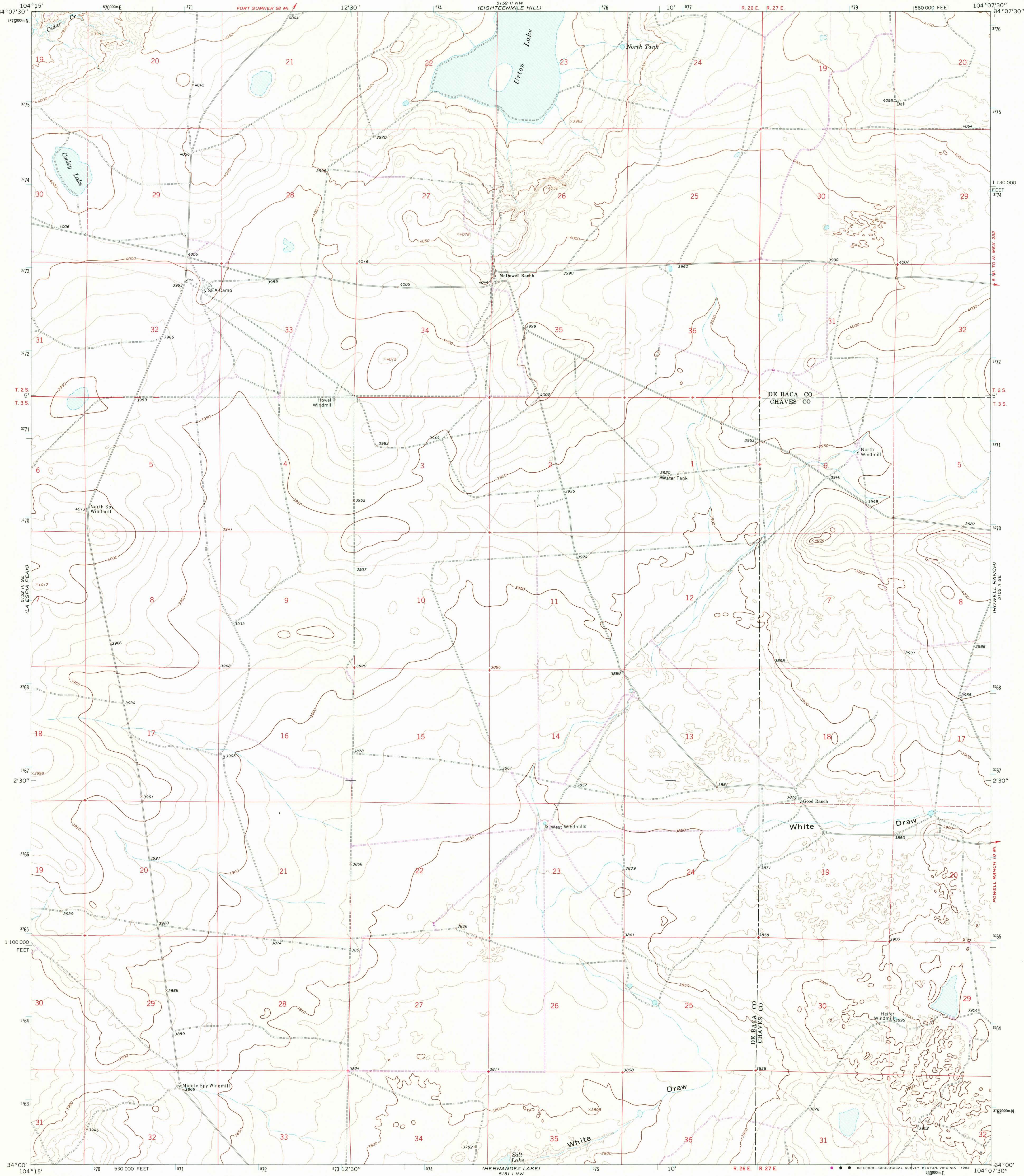

Mapped, edited, and published by the Geological Survey

Control by USGS and NOS/NOAA

Topography by photogrammetric methods from aerial

photographs taken 1966. Field checked 1967

Polyconic projection. 10,000-foot grid ticks based on
New Mexico coordinate system, east zone. 1000-meter
Universal Transverse Mercator grid ticks, zone 13,
shown in blue. 1927 North American Datum. To place
on the predicted North American Datum 1983 move
the projection lines 5 meters south and 47 meters
east as shown by dashed corner ticks

Fine red dashed lines indicate selected fence lines

Revisions shown in purple and woodland compiled from
aerial photographs taken 1979 and other sources
This information not field checked. Map edited 1982

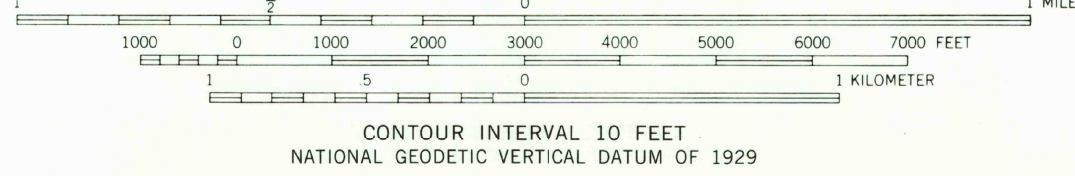
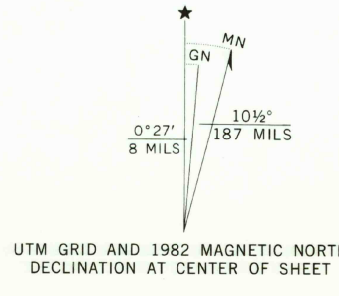

THIS MAP COMPLIES WITH NATIONAL MAP ACCURACY STANDARDS
FOR SALE BY U. S. GEOLOGICAL SURVEY, DENVER, COLORADO 80225, OR RESTON, VIRGINIA 22092
A FOLDER DESCRIBING TOPOGRAPHIC MAPS AND SYMBOLS IS AVAILABLE ON REQUEST



QUADRANGLE LOCATION

ROAD CLASSIFICATION
Light-duty ——— Unimproved dirt - - - - -

RETURN TO:
USGS NMD HISTORICAL MAP ARCHIVES

COOLEY LAKE, N. MEX.
N3400—W10407.5/7.5

1967
PHOTOREVISED 1982
DMA 5152 II SW—SERIES V881

OCT 21 1982

2600