

UNITED STATES
DEPARTMENT OF THE INTERIOR
GEOLOGICAL SURVEY

SQUAW BUTTES QUADRANGLE
MONTANA—GLACIER CO.
7.5 MINUTE SERIES (TOPOGRAPHIC)

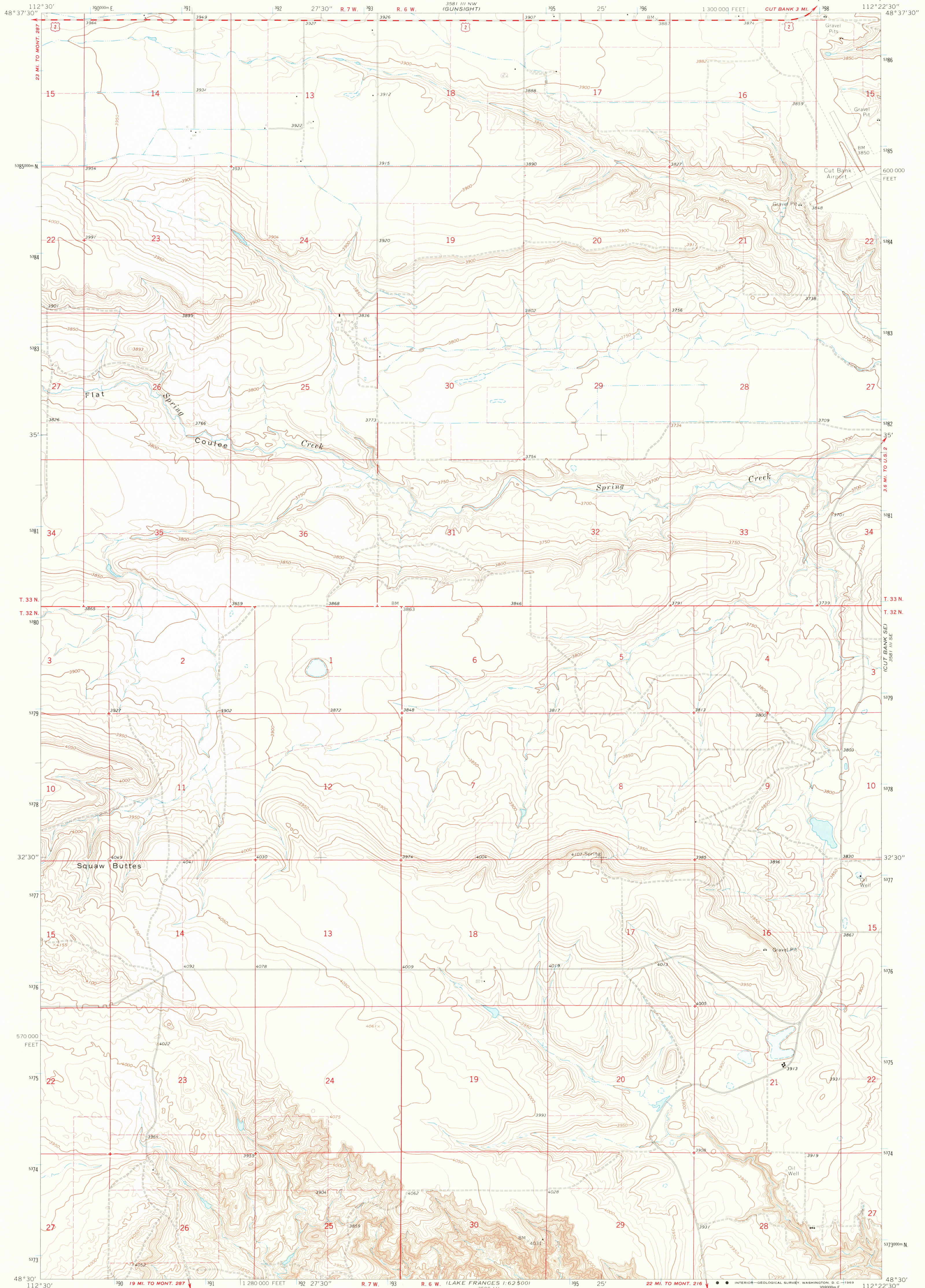

Mapped, edited, and published by the Geological Survey
Control by USGS and USC&GS
Topography by photogrammetric methods from aerial
photographs taken 1964. Field checked 1966.
Polyconic projection. 1927 North American datum.
10,000-foot grid based on Montana coordinate system.
north zone
1000-meter Universal Transverse Mercator grid ticks,
zone 12, shown in blue
Fine red dashed lines indicate selected fence lines
Entire area lies within the Blackfeet Indian Reservation

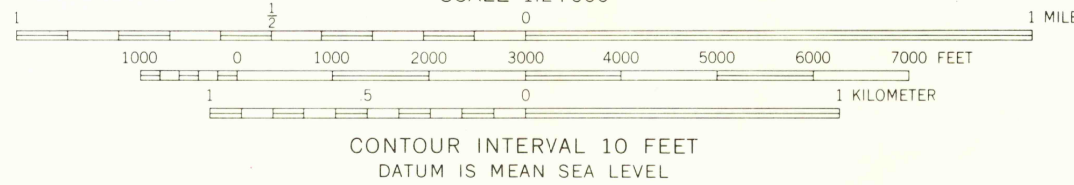
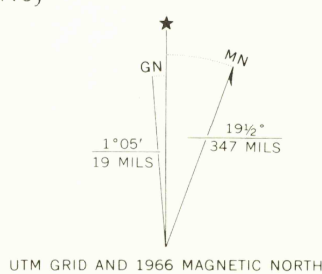

ROAD CLASSIFICATION
Medium-duty ——— Light-duty ———
Unimproved dirt - - - - -
U.S. Route

SQUAW BUTTES, MONT.
N4830—W11225.7/5

1966

AMS 3581 III SW—SERIES V894

USGS
Historical File
Topographic Division

OCT 9 1969