

Produced by the United States Geological Survey
Control by USGS and NOS/NOAA
Compiled from imagery taken 1957. Photoinspected using
imagery dated 1991; no major culture or drainage changes
observed. PLSS and survey control current as of 1962.
Boundaries and names revised 1994.
North American Datum of 1927 (NAD 27). Projection:
Idaho Coordinate System, central zone (Transverse Mercator)
10000-foot ticks: Idaho Coordinate System, central and west zones
and Montana Coordinate System, south zone
Blue 1000-meter Universal Transverse Mercator ticks, zone 11
North American Datum of 1983 (NAD 83) is shown by dashed
corner ticks. The values of the shift between NAD 27 and NAD 83
for 7.5-minute intersections are obtainable from National Geodetic
Survey NADCON software.
There may be private inholdings within the boundaries of the
National or State reservations shown on this map.

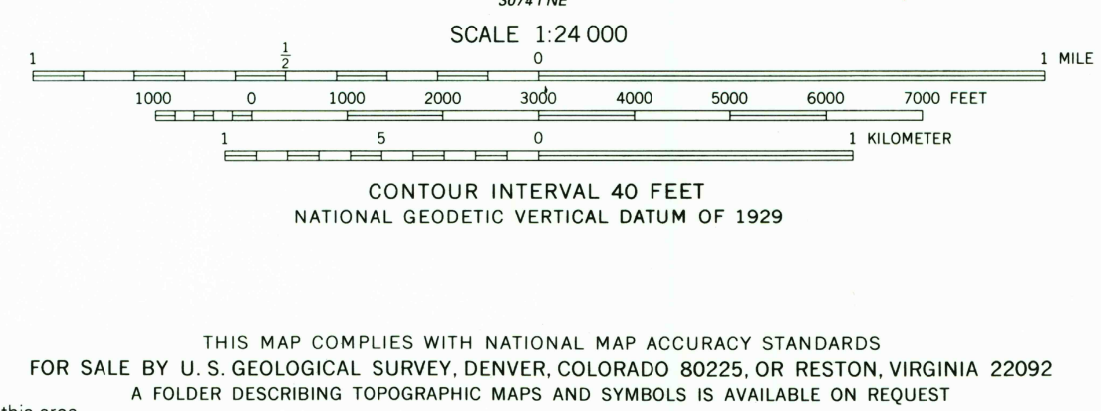

ROAD CLASSIFICATION
Primary highway, hard surface — Light duty road, hard or improved surface
Secondary highway, hard surface — Unimproved road
Interstate Route — U.S. Route — State Route

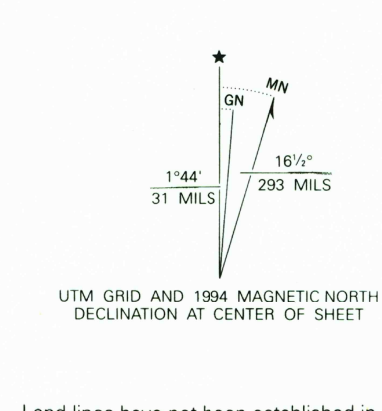

BLUE JOINT, ID-MT
45114-E5-TF-024

1991

DMA 3075 II SE-SERIES V893

