

DEPARTMENT OF THE INTERIOR
U. S. GEOLOGICAL SURVEY

MONROE COUNTY, NEW YORK
REGIONAL PLANNING BOARD
DONALD S. BARROWS, CHAIRMAN, HAROLD G. DOBSON, VICE CHAIRMAN
ANDREW H. BOWN, ESTEN A. FLETCHER, FRANK W. MOFFETT
J. FRANKLIN BONNER, SECRETARY
ROY P. WARREN, ENGINEER
(Braddock Heights)

NEW YORK
(MONROE COUNTY)
ROCHESTER WEST QUADRANGLE

Advance sheet
Subject to correction

77° 37' 30" (Rochester East)
43° 01' 30" (Rochester East)

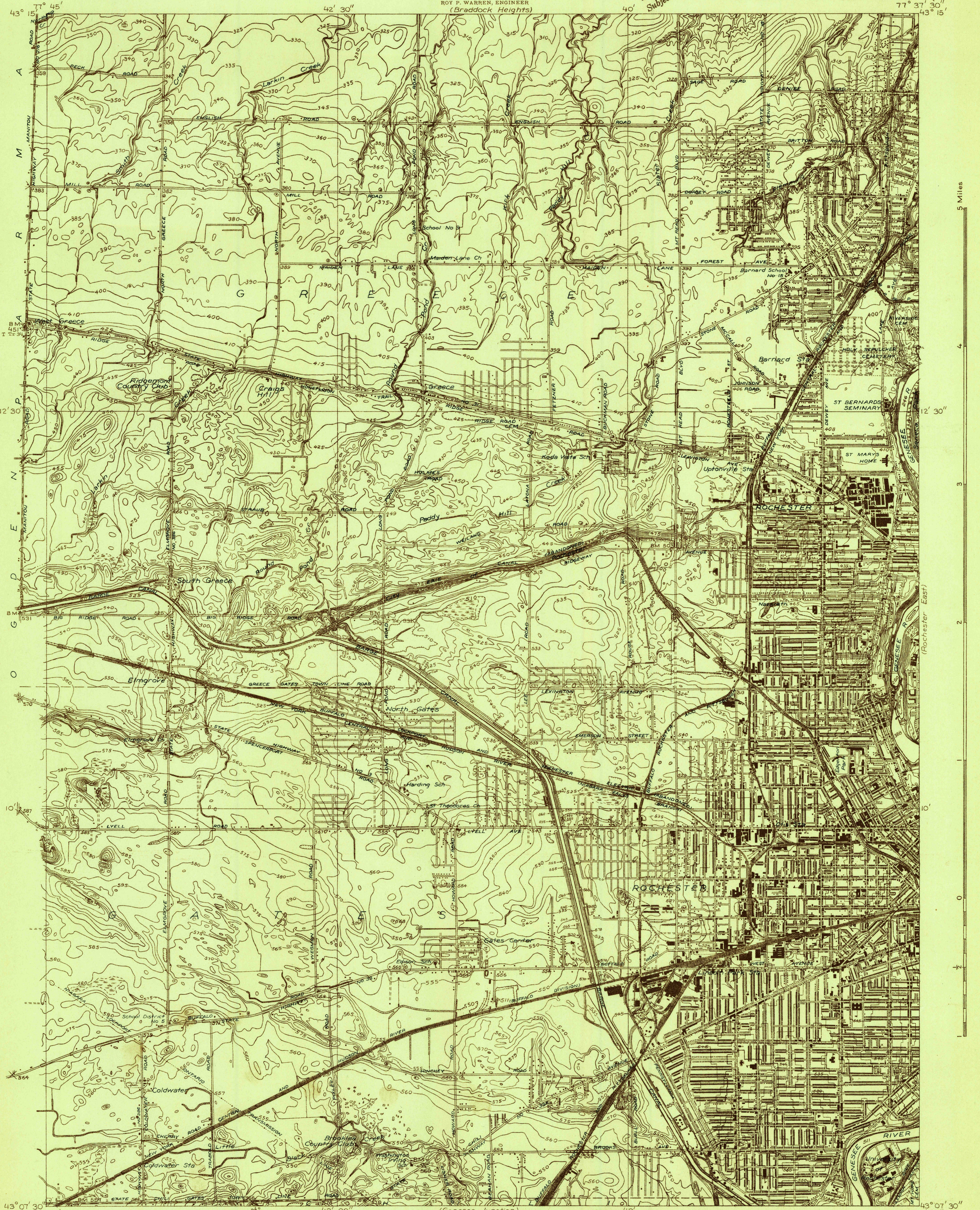

Albert Pike, Division Engineer
Topography by R.F. Wilcox and H.B. Smith
Culture and drainage in part compiled from aerial photographs
Control by U. S. Geological Survey and
U. S. Coast and Geodetic Survey
Surveyed in 1931



APPROXIMATE MEAN
DECLINATION, 1981

Scale 24,000
1 0.5 0 1 2 Miles
5000 0 5000 10000 Feet

Contour interval 5 feet
Datum is mean sea level

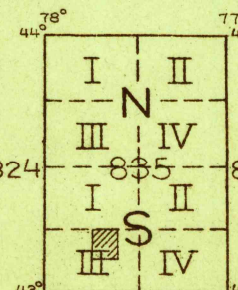

USGS Library
Reston, VA.
Topo Archive

ROCHESTER WEST, N.Y.

FILED HISTORICAL FILES
RETURN TO CENTRAL FILE
(DO NOT REMOVE)