

UNITED STATES
DEPARTMENT OF THE INTERIOR
GEOLOGICAL SURVEY

CAMBRIDGE QUADRANGLE
OKLAHOMA
7.5 MINUTE SERIES (TOPOGRAPHIC)

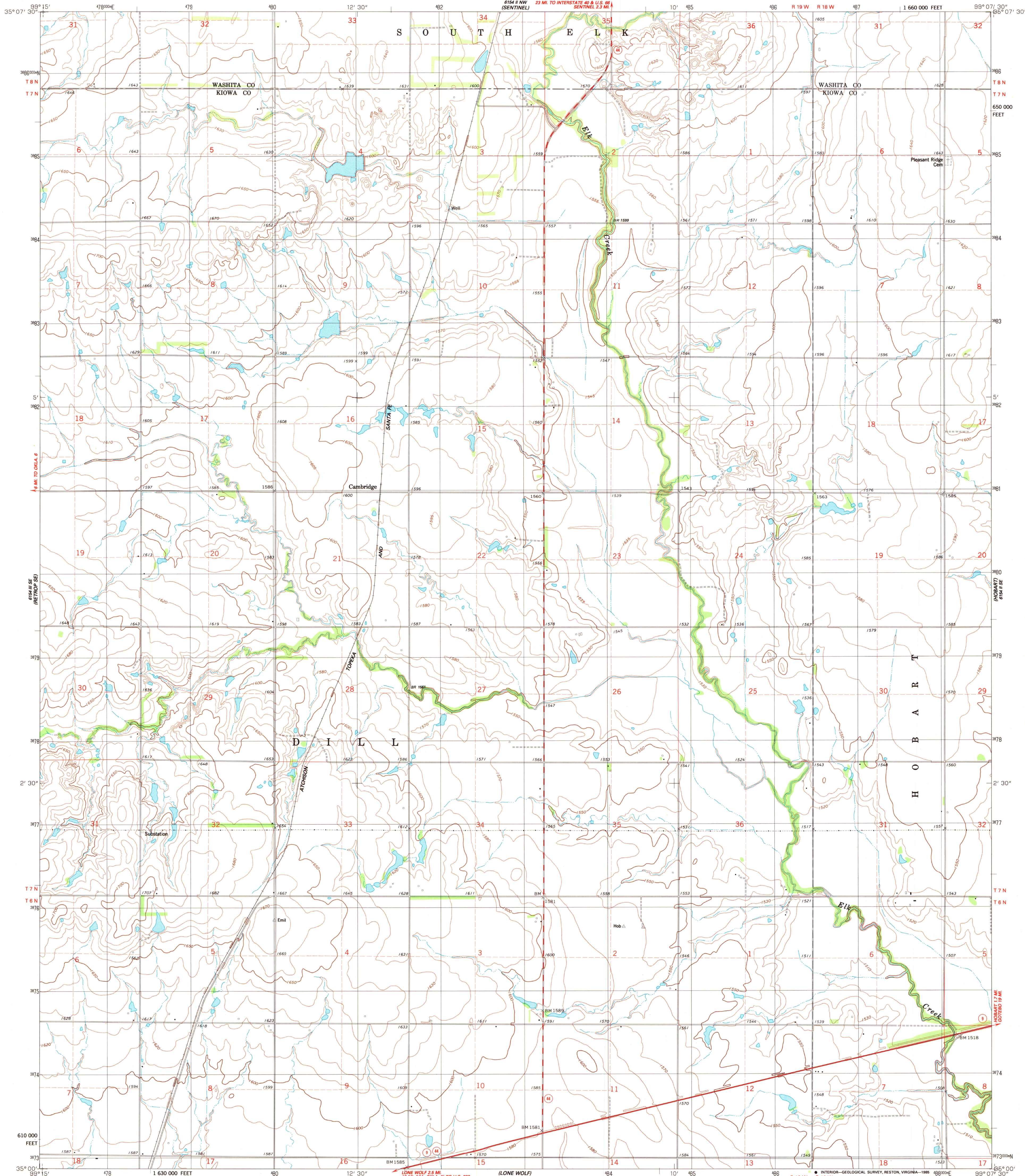

Mapped, edited, and published by the Geological Survey in cooperation with the Oklahoma Highway Department, Oklahoma Water Resources Board, and Oklahoma State Soil Conservation Board.
Control by USGS and NOS/NOAA
Topography by photogrammetric methods from aerial photographs taken 1958. Revised from aerial photographs taken 1983. Field checked 1984. Map edited 1984.
Projection and 10,000-foot grid ticks: Oklahoma coordinate system, south zone (Lambert conformal conic).
1000-meter Universal Transverse Mercator grid, zone 14
1927 North American Datum
To place on the predicted North American Datum 1983, move the projection lines 4 meters south and 33 meters east as shown by dashed corner ticks.
Fine red dashed lines indicate selected fence and field lines where generally visible on aerial photographs. This information is unchecked.

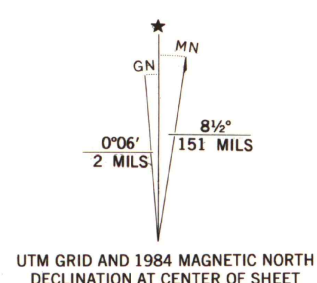

SCALE 1:24 000
CONTOUR INTERVAL 10 FEET
DOTTED LINES REPRESENT 5-FOOT CONTOURS
NATIONAL GEODETIC VERTICAL DATUM OF 1929
THIS MAP COMPLIES WITH NATIONAL MAP ACCURACY STANDARDS
FOR SALE BY U.S. GEOLOGICAL SURVEY, DENVER, COLORADO 80225, OR RESTON, VIRGINIA 22092
AND OKLAHOMA GEOLOGICAL SURVEY, NORMAN, OKLAHOMA 73069
A FOLDER DESCRIBING TOPOGRAPHIC MAPS AND SYMBOLS IS AVAILABLE ON REQUEST



ROAD CLASSIFICATION
Primary highway, hard surface
Secondary highway, hard surface
Unimproved road
Interstate Route
U. S. Route
State Route
CAMBRIDGE, OKLA.
SW/4 HOBART 15' QUADRANGLE
35099-A2-TF-024
1984
DMA 6154 II SW-SERIES V883

U.S. Regional
Depository Copy
DO NOT DISCARD
H. ROBINSON
MAP LIBRARY
DEC 20 1985
University of Wisconsin
Madison