

UNITED STATES  
DEPARTMENT OF THE INTERIOR  
GEOLOGICAL SURVEY

BRYANT RANCH QUADRANGLE  
TEXAS-MIDLAND CO.  
7.5 MINUTE SERIES (TOPOGRAPHIC)

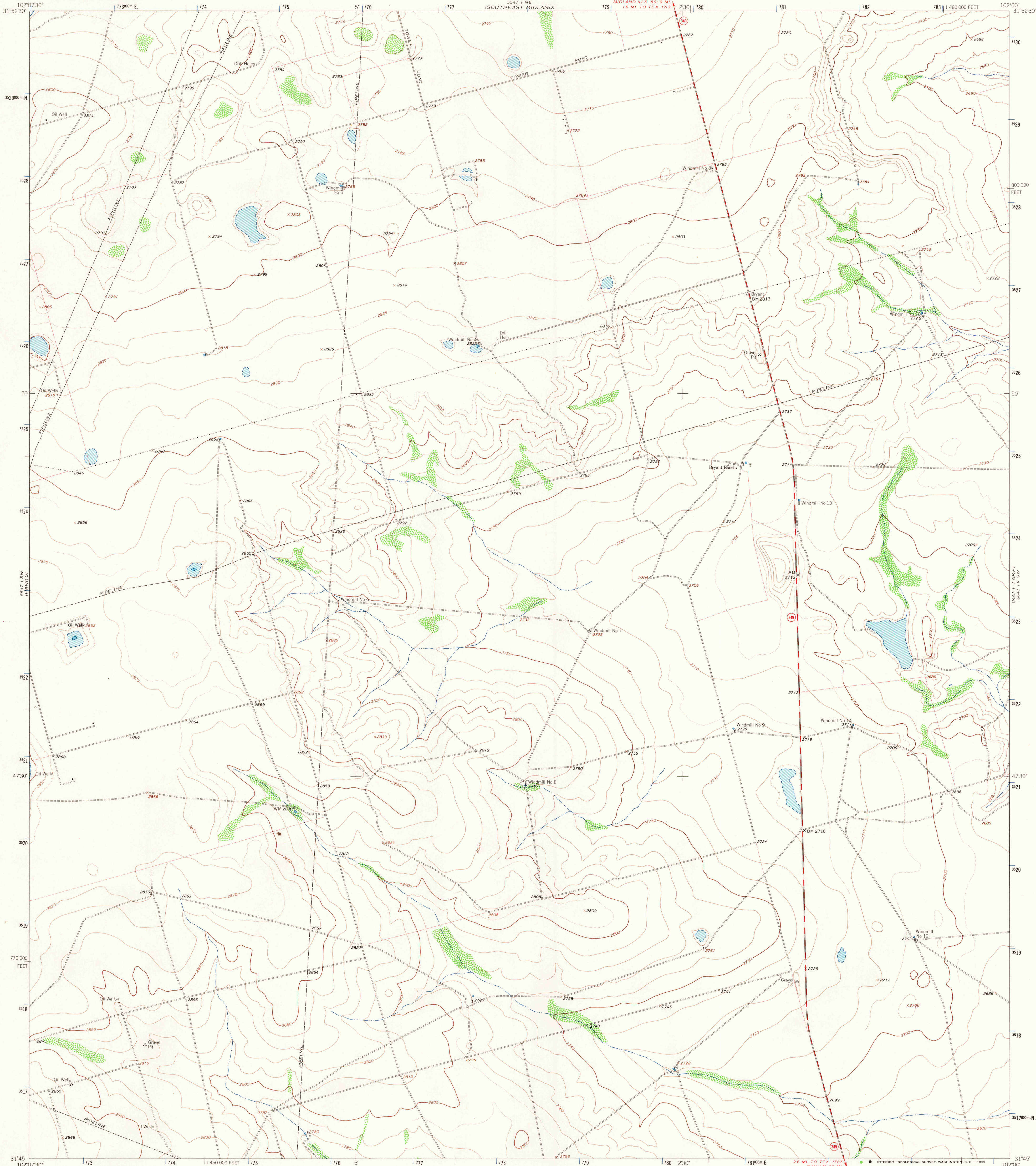

Mapped, edited, and published by the Geological Survey

Control by USGS and USC&GS

Topography by photogrammetric methods from aerial photographs taken 1963. Field checked 1964

Polycyclic projection: 1927 North American datum  
10 000 foot grid based on Texas coordinate system, central zone  
1000 meter Universal Transverse Mercator grid ticks,  
zone 13, shown in blue

Fine red dashed lines indicate selected fence lines

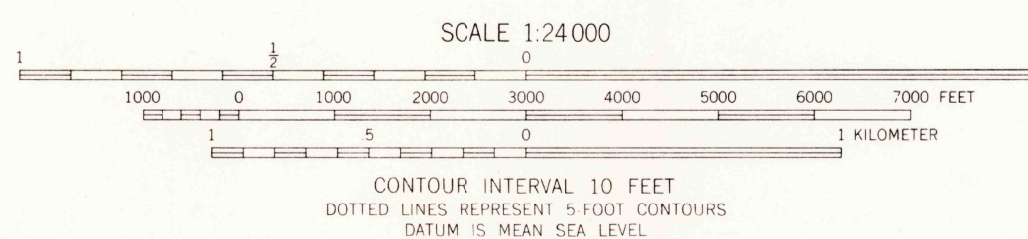
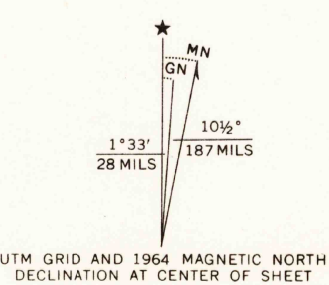

THIS MAP COMPLIES WITH NATIONAL MAP ACCURACY STANDARDS  
FOR SALE BY U. S. GEOLOGICAL SURVEY, DENVER, COLORADO 80225, OR WASHINGTON, D. C. 20242  
A FOLDER DESCRIBING TOPOGRAPHIC MAPS AND SYMBOLS IS AVAILABLE ON REQUEST

USGS  
Historical File  
Topographic Division



QUADRANGLE LOCATION

ROAD CLASSIFICATION  
Medium duty ——— Light-duty ———  
Unimproved dirt ———  
State Route ———

U.S.G.S.  
FILE COPY  
TOPOGRAPHIC DIVISION

BRYANT RANCH, TEX.  
N3145-W10200/7.5

1964

AMS 5547 I SE-SERIES V882

2345  
MAR 8 1964