

UNITED STATES  
DEPARTMENT OF THE INTERIOR  
GEOLOGICAL SURVEY

WEST OF KERRICK QUADRANGLE  
TEXAS-DALLAM CO.  
7.5 MINUTE SERIES (TOPOGRAPHIC)  
(FORMERLY STRATFORD 2 NE)

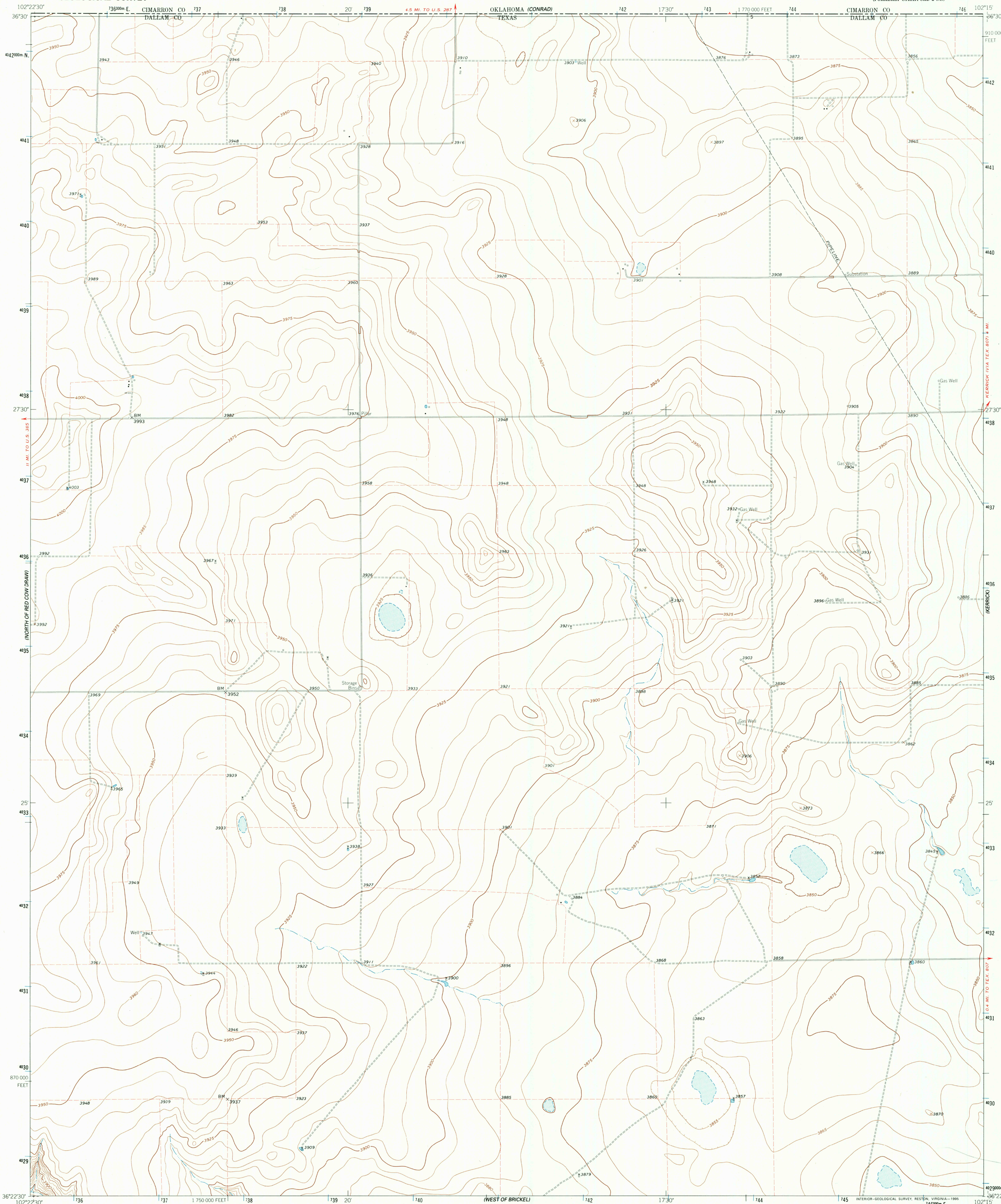

Produced by the United States Geological Survey in cooperation with Texas Water Development Board Control by USGS and NOS/NOAA  
Compiled from aerial photographs taken 1962 and plane-table surveys 1964  
North American Datum of 1927 (NAD 27). Projection and 10 000-foot ticks: Texas Coordinate System, north zone (Lambert Conformal Conic)  
Blue 1000-meter Universal Transverse Mercator ticks, zone 13  
North American Datum of 1983 (NAD 83) is shown by dashed corner ticks. The values of the shift between NAD 27 and NAD 83 for 7.5-minute intersections are obtainable from National Geodetic Survey NADCON software  
Fine red dashed lines indicate selected fence lines

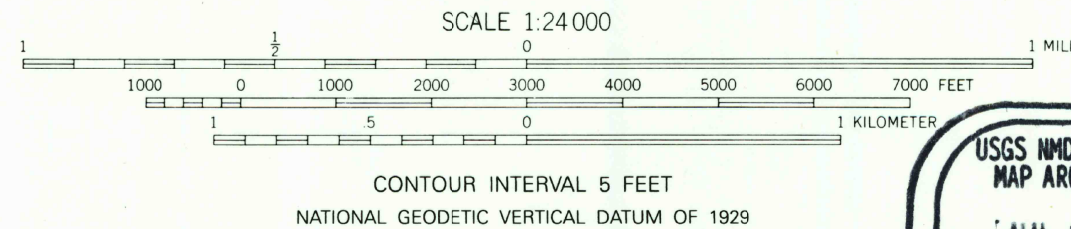
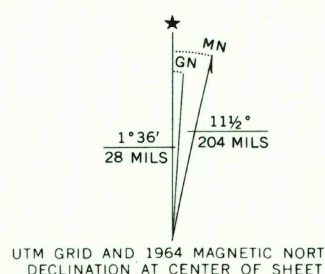

THIS MAP COMPLIES WITH NATIONAL MAP ACCURACY STANDARDS  
FOR SALE BY U.S. GEOLOGICAL SURVEY  
DENVER, COLORADO 80225, OR RESTON, VIRGINIA 22092  
A FOLDER DESCRIBING TOPOGRAPHIC MAPS AND SYMBOLS IS AVAILABLE ON REQUEST



3602-134

ROAD CLASSIFICATION  
Light-duty ————— Unimproved dirt —————

WEST OF KERRICK, TX  
(FORMERLY STRATFORD 2 NE)  
36102-D3-TF-024

1964  
DMA 5556 IV NE-SERIES V882