

A.M.S. V502  
Type F (AMS 1), 1947.  
Prepared under the direction of the Chief of Engineers by the Army Map Service (AM), Corps of Engineers, Department of the Army, Washington, D.C. Compiled in 1947 from United States Quadrangles 1:62,500 and 1:250,000. Corps of Engineers and U.S. Geological Survey, 1915-1943. County Highway Maps, 1937-1941. Statistical Data to 1940. Woodland partially revised from aerial photography dated 1942-1945. Aerial photography by U.S. Air Force. Road classifications verified by State Highway Department, 1947. Control by U.S. Coast and Geodetic Survey.

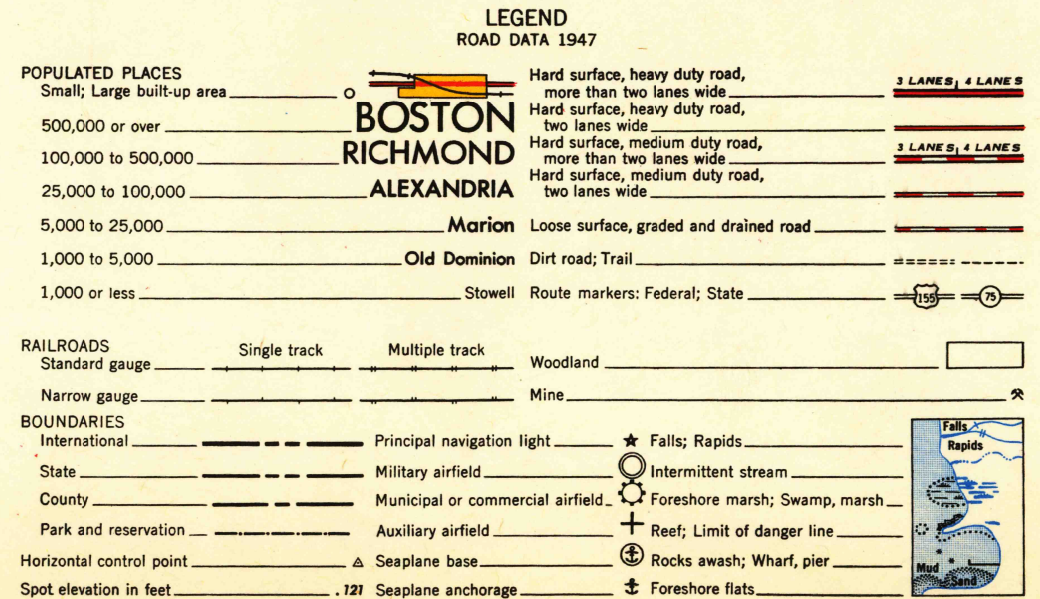

SECTIONIZED TOWNSHIP

6	5	4	3	2	1
7	8	9	10	11	12
13	14	15	16	17	18
19	20	21	22	23	24
25	26	27	28	29	30
31	32	33	34	35	36

INDEX TO BOUNDARIES

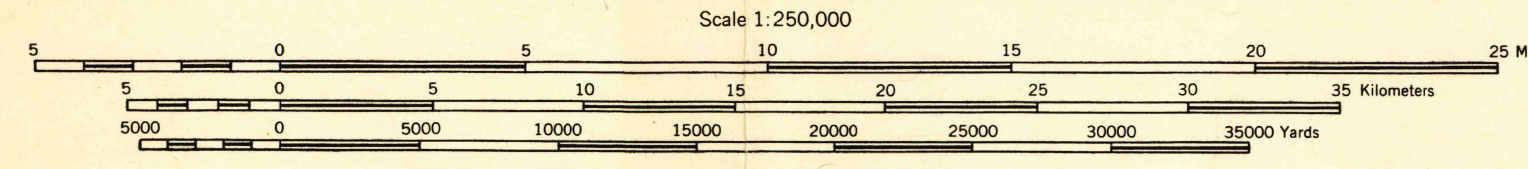
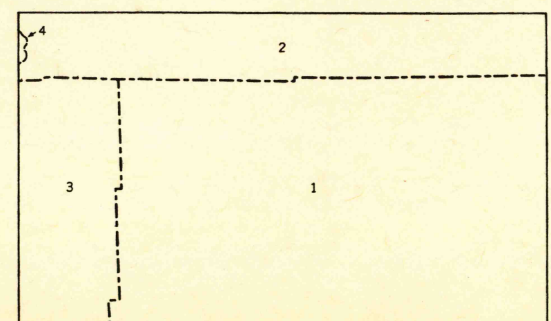

FOR SALE BY U. S. GEOLOGICAL SURVEY, DENVER FEDERAL CENTER, DENVER, COLORADO, OR WASHINGTON 25, D. C.

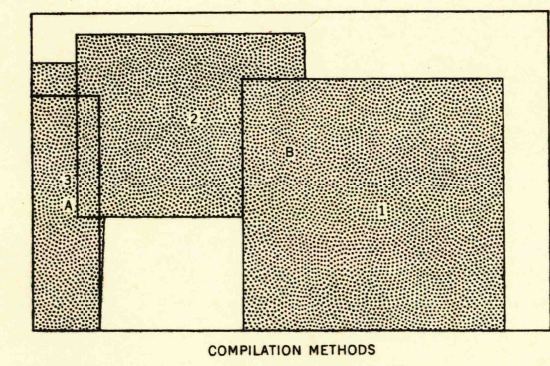
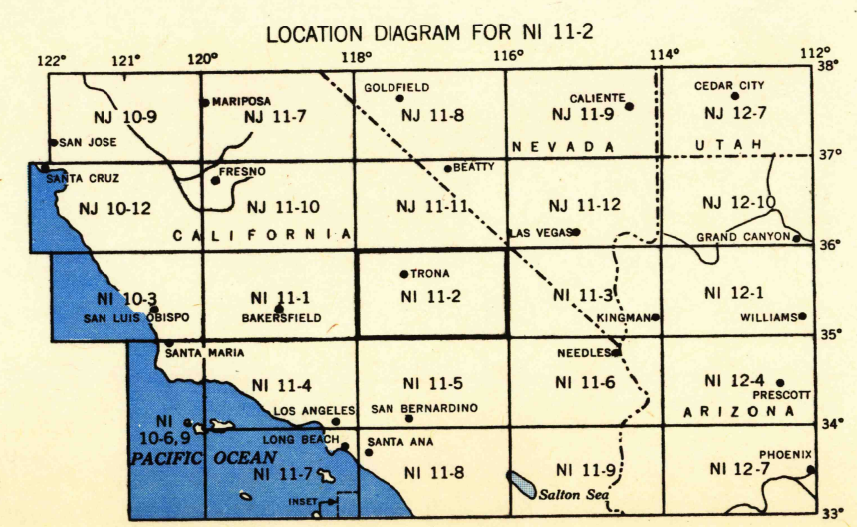

TRONA, UNITED STATES  
CALIFORNIA  
N3500-W11600/100x200