

U. S. G. S.
FILE COPY
Inspection and Editing

STATE OF ILLINOIS
ADLAI E. STEVENSON, GOVERNOR
DEPARTMENT OF REGISTRATION AND EDUCATION
NOBLE J. PUFFER, DIRECTOR
GEOLOGICAL SURVEY DIVISION, M. M. LEIGHTON, CHIEF, URBANA, ILLINOIS

UNITED STATES
DEPARTMENT OF THE INTERIOR
GEOLOGICAL SURVEY

ILLINOIS
(COOK COUNTY)
RIVER FOREST QUADRANGLE

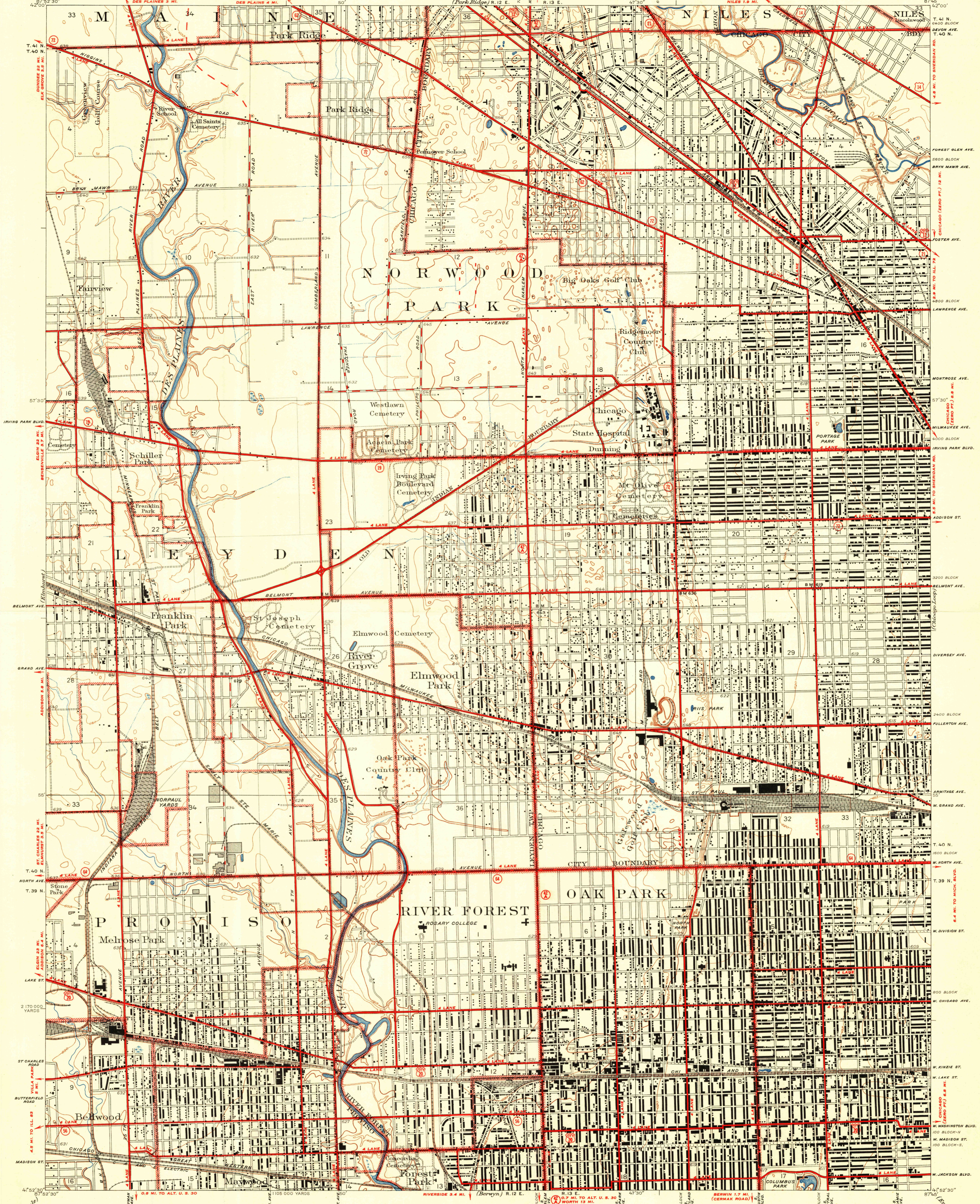

O. H. Nelson, Associate Topographic Engineer in charge
Topography by O. H. Nelson, H. E. Simmons and Arthur Johnson
Culture and drainage in part compiled from aerial photographs taken
by Air Corps U.S. Army
Surveyed in 1924-1925
Culture revised in part 1947

ROAD CLASSIFICATION
HARD-SURFACE ALL WEATHER ROADS DRY WEATHER ROADS
Heavy-duty 4 LANE IMPROVED DIRT
Medium-duty 4 LANE IMPROVED DIRT
Loose-surface, graded, or narrow hard-surface
U. S. Route
State Route

Scale 1:50,000
Contour interval 5 feet
Datum is mean sea level
FOR SALE BY U. S. GEOLOGICAL SURVEY, WASHINGTON 25, D. C.
A FOLDER DESCRIBING TOPOGRAPHIC MAPS AND SYMBOLS IS AVAILABLE ON REQUEST

USGS
Historical File
Topographic Division

Polyconic projection, North American datum
Edition of 1928
reprinted 1950
with corrections
NAD 83 - WGS 84/75
Chicago City datum is 579.896 feet
above mean sea level

U. S. G. S.
FILE COPY
Inspection and Editing

RIVER FOREST, ILL.

AUG 8 1950

4260