

UNITED STATES
DEPARTMENT OF THE INTERIOR
GEOLOGICAL SURVEY

Maped and edited by Tennessee Valley Authority
Published by the Geological Survey

Control by NOS/NOAA, USGS and TVA
Topography by USGS and TVA by photogrammetric
methods using aerial photographs
Map field checked by TVA 1947

Polyconic projection, 10,000 foot grid ticks based on Alabama
coordinate system, east zone, 1000-meter Universal Transverse Mercator
grid ticks, zone 16, shown in blue. 1927 North American Datum
To place on the predicted North American Datum 1983
move the projection lines 7 meters south and 3 meters
west as shown by dashed corner ticks

There may be private inholdings within the boundaries of
the National or State reservations shown on this map

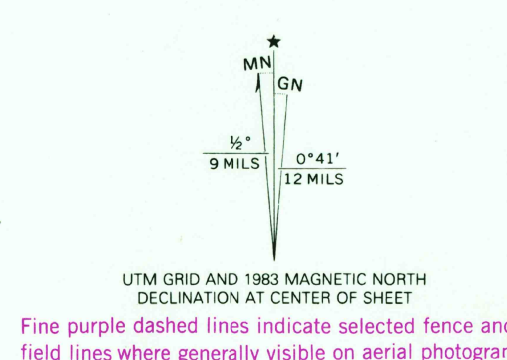

SCALE 1:24,000

CONTOUR INTERVAL 20 FEET
DASHED LINES REPRESENT HALF-INTERVAL CONTOURS
NATIONAL GEODETIC VERTICAL DATUM OF 1929

THIS MAP COMPLIES WITH NATIONAL MAP ACCURACY STANDARDS
FOR SALE BY U. S. GEOLOGICAL SURVEY, RESTON, VIRGINIA 22092,
AND U. S. TENNESSEE VALLEY AUTHORITY, CHATTANOOGA, TENN. 37401 OR KNOXVILLE, TENN. 37902
A FOLDER DESCRIBING TOPOGRAPHIC MAPS AND SYMBOLS IS AVAILABLE ON REQUEST

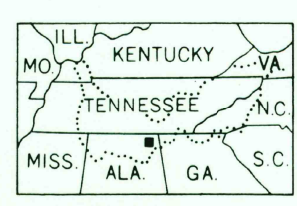

ROAD CLASSIFICATION	
Primary highway, all weather, hard surface	Light-duty road, all weather, improved surface
Secondary highway, all weather, hard surface	Unimproved road, fair or dry weather
Interstate Route	U. S. Route
	State Route

STEVENS ON, ALA.
34085-67-TF-024

1947
PHOTO REVIS ED 1983
DMA 3853 IV SE-SERIES V844