

UNITED STATES
DEPARTMENT OF THE INTERIOR
GEOLOGICAL SURVEY

BOUSE SW QUADRANGLE
ARIZONA-LA PAZ CO.
7.5 MINUTE SERIES (TOPOGRAPHIC)

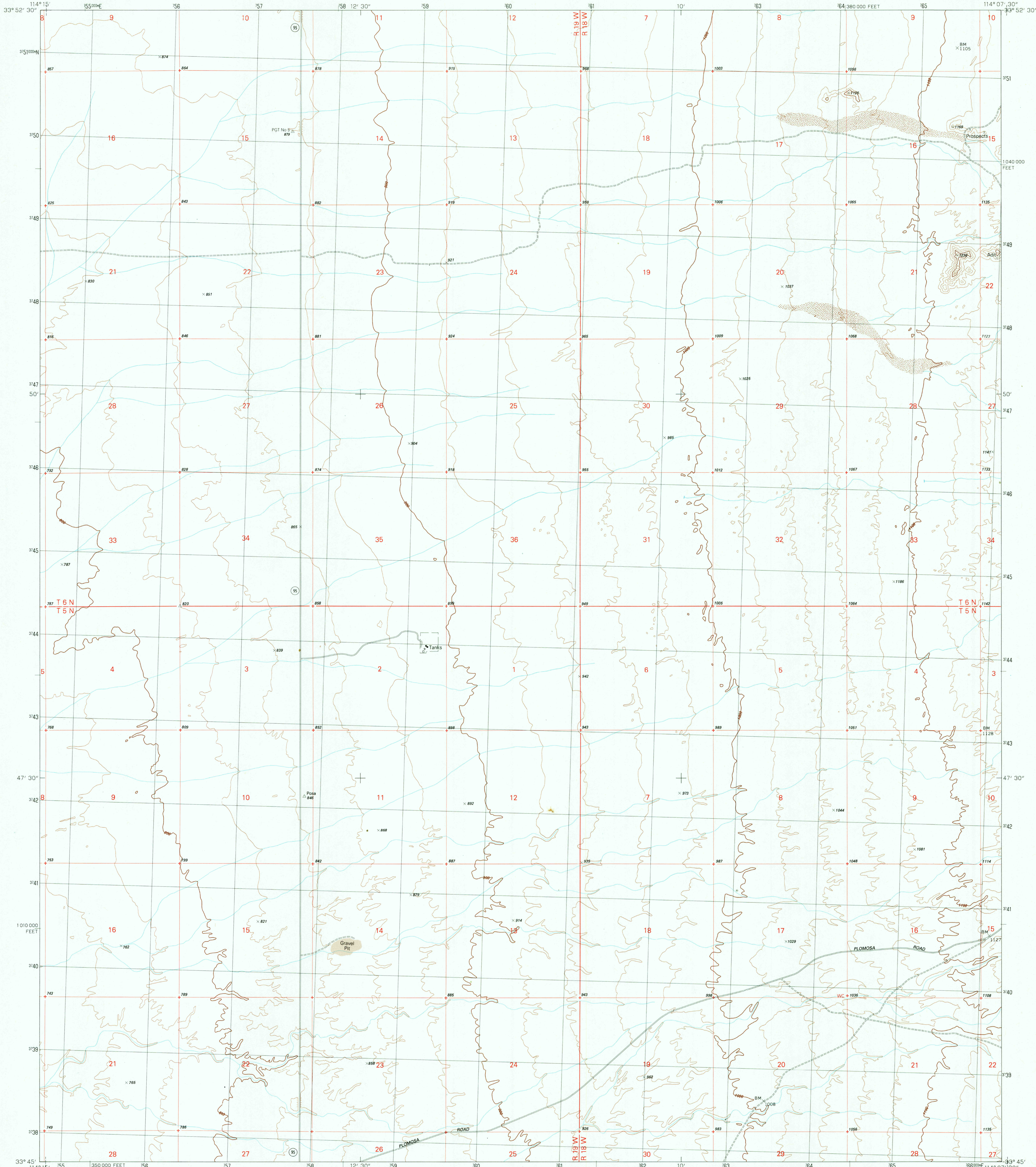

PRODUCED BY THE UNITED STATES GEOLOGICAL SURVEY
CONTROL BY USGS, NOS/NOAA, AND AMS
FIELD CHECKED 1991 AND 1990
LIMITED REVISION FROM AERIAL PHOTOGRAPHS TAKEN 1962
FIELD CHECKED 1987 MAP EDITED 1990
PROJECTION TRANSVERSE MERCATOR
GRID: 1000-METER UNIVERSAL TRANSVERSE MERCATOR ZONE 11
10000-FOOT STATE GRID TICS ARIZONA, WEST ZONE
UTM GRID DECLINATION 1734° EAST
1980 MAGNETIC NORTH DECLINATION 15° EAST
VERTICAL DATUM NATIONAL GEODETIC VERTICAL DATUM OF 1959
HORIZONTAL DATUM 1927 NORTH AMERICAN DATUM
To place on the predicted North American Datum of 1983,
move the projection lines as shown by dashed corner ticks
(4 meter south and 72 meters east).
There may be private inholdings within the boundaries of any
Federal and State Reservations shown on this map.
Public Land Survey System is shown as published in 1962 and
verified or supplemented in 1987.

PROVISIONAL MAP
Produced from original
manuscript drawings. Informa-
tion shown as of date of
field check.

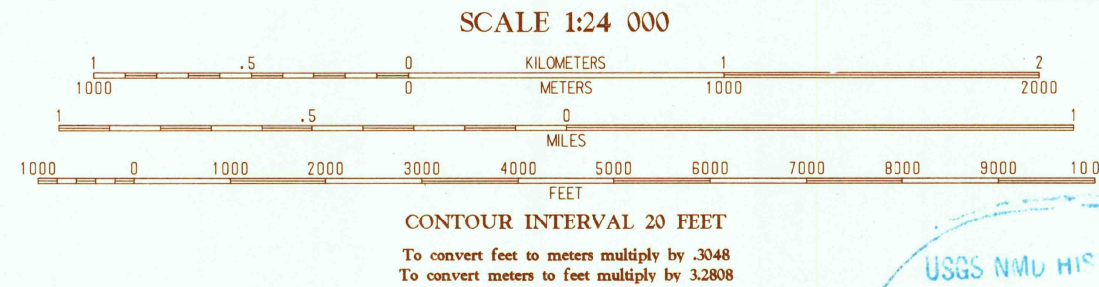

THIS MAP COMPLIES WITH NATIONAL MAP ACCURACY STANDARDS
FOR SALE BY U.S. GEOLOGICAL SURVEY, DENVER, COLORADO 80225
OR RESTON, VIRGINIA 22092

JAN 28 1991
REC'D FILE COPY

1	2	3	1. Moon Mountain NE
2	3	4	2. Bouse NW
3	4	5	3. Bouse
4	5	6	4. Moon Mountain SE
5	6	7	5. Bear Peak
6	7	8	6. Middle Camp Mountain
7	8	9	7. Quartzite
8	9	10	8. Plomosa Pass

ROAD LEGEND
Improved Road
Unimproved Road
Trail
Interstate Route
U.S. Route
State Route

BOUSE SW, ARIZONA
PROVISIONAL EDITOR 1990
33114-G2-TF-024