

UNITED STATES
DEPARTMENT OF THE INTERIOR
GEOLOGICAL SURVEY

OBERT QUADRANGLE
NEBRASKA
7.5 MINUTE SERIES (TOPOGRAPHIC)

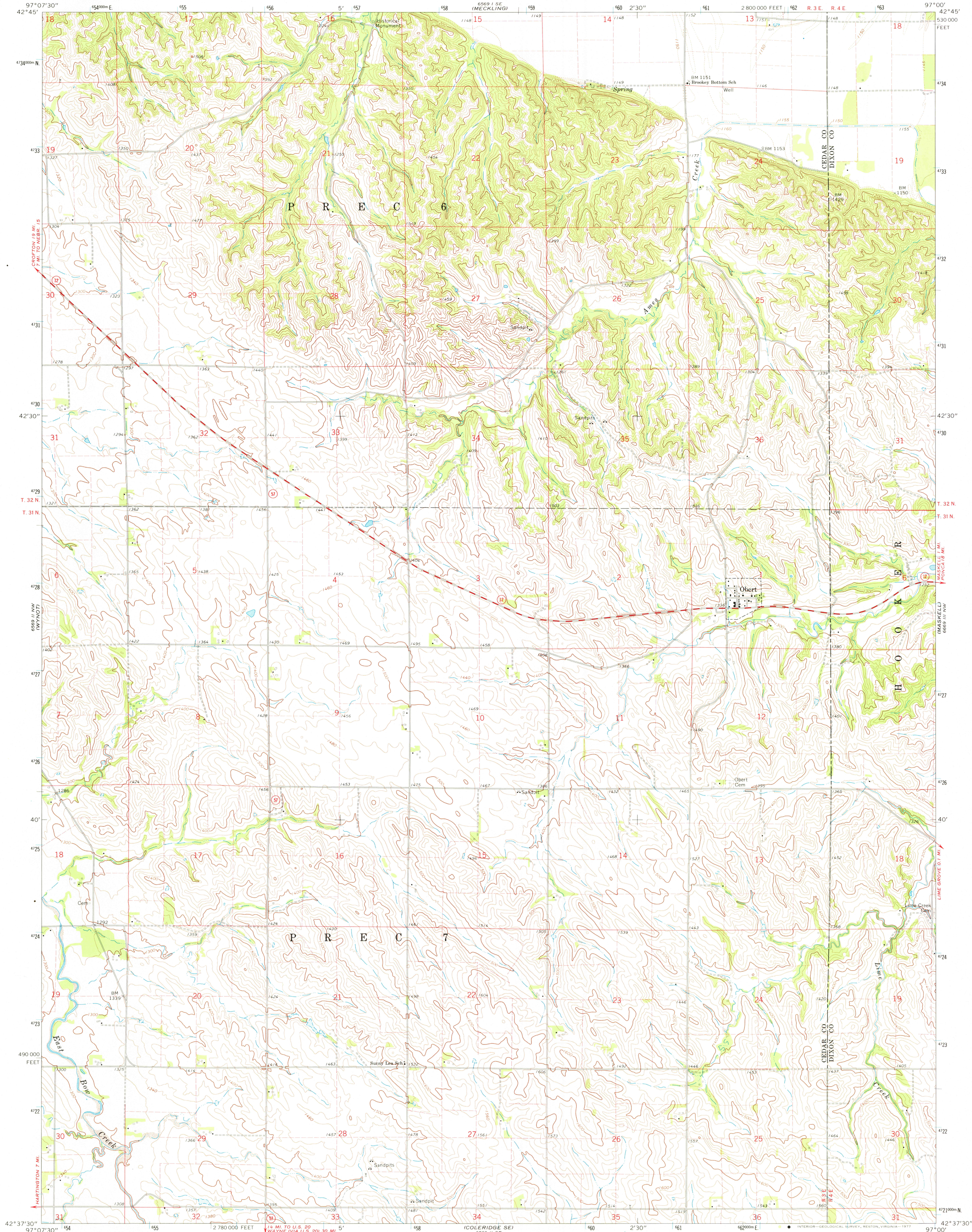

Mapped, edited, and published by the Geological Survey as part of the Department of the Interior program for the development of the Missouri River Basin Control by USGS and USC&GS
Topography by photogrammetric methods from aerial photographs taken 1966 and planetable surveys 1968
Polyconic projection. 1927 North American datum 10,000-foot grid based on Nebraska coordinate system, north zone 1000-meter Universal Transverse Mercator grid ticks, zone 14, shown in blue
Fine red dashed lines indicate selected fence and field lines where generally visible on aerial photographs. This information is unchecked

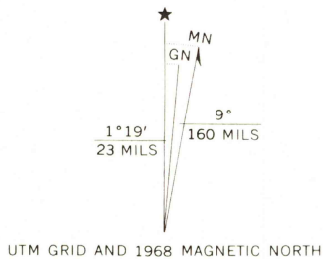

THIS MAP COMPLIES WITH NATIONAL MAP ACCURACY STANDARDS
FOR SALE BY U.S. GEOLOGICAL SURVEY, DENVER, COLORADO 80225, OR RESTON, VIRGINIA 22092
A FOLDER DESCRIBING TOPOGRAPHIC MAPS AND SYMBOLS IS AVAILABLE ON REQUEST

ROAD CLASSIFICATION
Secondary highway, all weather, Light-duty road, all weather, hard surface
Unimproved road, fair or dry weather
State Route

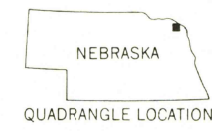

OBERT, NEBR.
N4237.5—W9700/7.5

1968
AMS 6569 II NE—SERIES V875

USGS
Historical File
Topographic Division

2300

NOV 20 1977