

UNITED STATES
DEPARTMENT OF THE INTERIOR
GEOLOGICAL SURVEY

PLATTSMOUTH QUADRANGLE
NEBRASKA-IOWA
7.5 MINUTE SERIES (TOPOGRAPHIC)

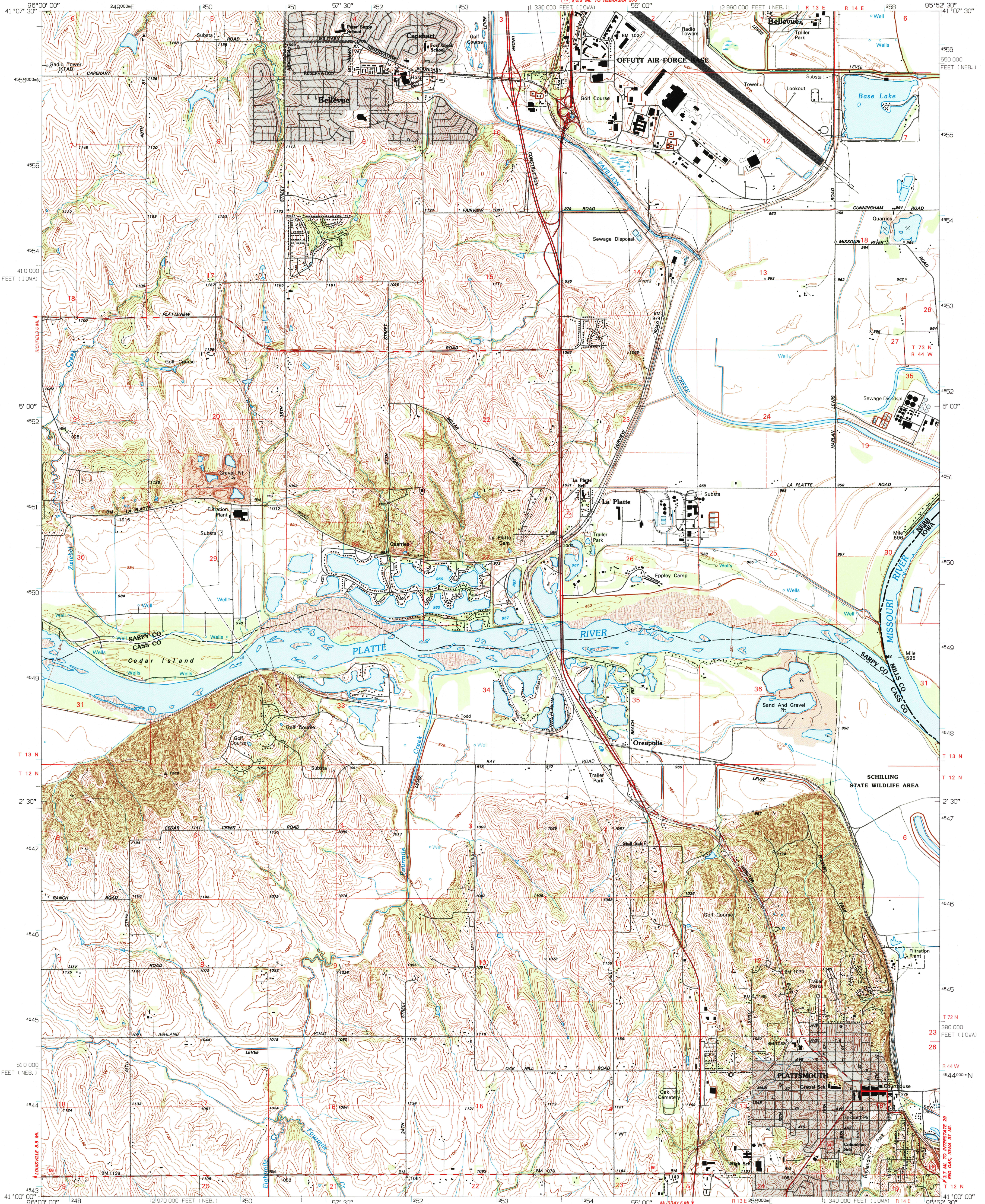

Produced by the United States Geological Survey
Control by USGS and NOS/NOAA
Topography by photogrammetric methods from aerial photographs taken 1952 and planimetric surveys 1956. Revised from aerial photographs taken 1990. Field checked 1993. Map edited 1994.
Universal Transverse Mercator projection
10,000-foot grid ticks: Nebraska coordinate system and Iowa coordinate system, south zones
1000-meter American Datum (NAD 27)
North American Datum of 1983 (NAD 83) is shown by dashed corner ticks
The values of the shift between NAD 27 and NAD 83 for 7.5-minute intersections are given in USGS Bulletin 1875
There may be private inholdings within the boundaries of the National or State reservations shown on this map
Gray tint indicates areas in which only landmark buildings are shown
Fine red dashed lines indicate selected fences and field lines shown generally visible on aerial photographs. This information is unchecked

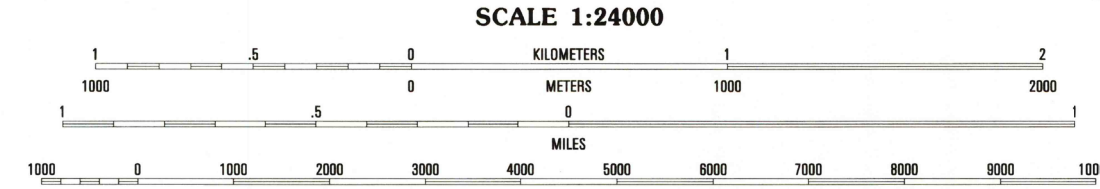
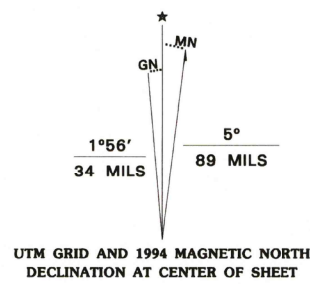

CONTOUR INTERVAL 10 FEET
SUPPLEMENTARY CONTOUR INTERVAL 5 FEET
NATIONAL GEODETIC VERTICAL DATUM OF 1929

COMPLIES WITH U.S. GEOLOGICAL SURVEY STANDARDS FOR SPATIAL ACCURACY - CLASS 2
FOR SALE BY U.S. GEOLOGICAL SURVEY, DENVER, COLORADO 80225, OR RESTON, VIRGINIA 22092
AND IOWA GEOLOGICAL SURVEY, IOWA CITY, IOWA 52240

A FOLDER DESCRIBING TOPOGRAPHIC MAPS AND SYMBOLS IS AVAILABLE ON REQUEST

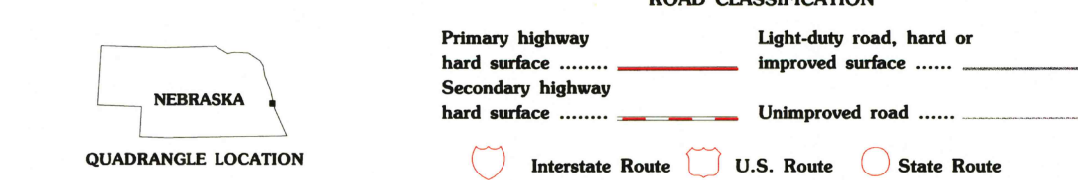

ROAD CLASSIFICATION			QUADRANGLE LOCATION		
Primary highway	Light-duty road, hard or hard surface	Improved surface	1	2	3
Secondary highway	Unimproved road		4	5	6
Interstate Route	U.S. Route	State Route	7	8	9

PLATTSBURGH, NEBR.-IOWA
41095-A8-TF-024

1994

DMA 6866 III SW-SERIES V875

