

LOGAN MOUNTAIN QUADRANGLE
WYOMING-PARK CO.
7.5 MINUTE SERIES (TOPOGRAPHIC)

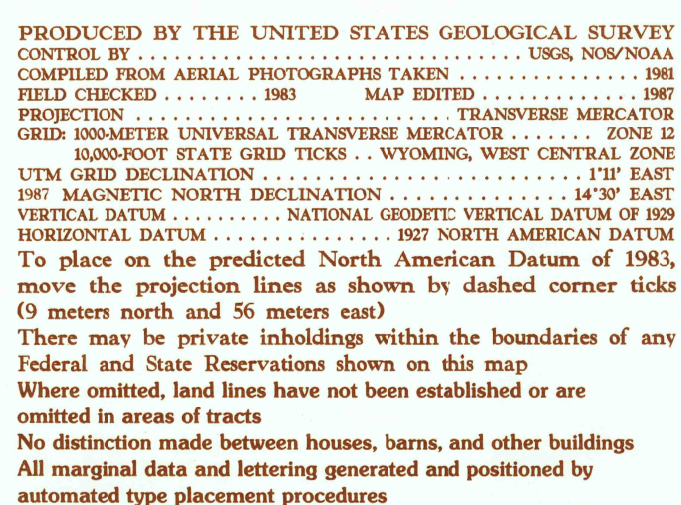

THIS MAP COMPLIES WITH NATIONAL MAP ACCURACY STANDARDS
FOR SALE BY U.S. GEOLOGICAL SURVEY, DENVER, COLORADO 80225
OR RESTON, VIRGINIA 22092

1 0.5 0 1
1000 0 1000 2000 3000 4000 5000 6000 7000 8000 9000 10 000
MILES

1 0.5 0 1 2
1000 0 1000 2000
FEET
KILOMETERS

0 METERS 1000 2000
CONTOUR INTERVAL 40 FEET

1	2	3	1 Dead Indian Meadows
			2 Pat O'Hara Mountain
4		5	3 Goff Lake
			4 Jim Mountain
			5 Shoshone Canyon
6	7	8	6 Wapiti
			7 Castle Rock Creek
			8 Irma Flats

Improved Road
Unimproved Road
Trail
 Interstate Route  U.S. Route  State Route

44109-E3-TF-024

